

Powder coated aluminium/timber composite window to be installed in accordance with manufacturers recommendations. Colour: RAL 7015

100mm Blockwork, strength and control joints to Structural Engineer's requirements. Min mass 120Kg/m2 to comply with Approved Document E.

102.5mm facing brickwork, FL class to BS 3921, workmanship to be in accordance with BS 8000:Part 3, masonry.

100mm Kingspan Kooltherm TW50 partial fill insulation or similar approved, installed with joints tightly butted to manufacturer's requirements - thickness to provide U value of 0.18W/m²K to overall wall construction.

Brickwork support or similar and approved to Structural Engineers requirements

Integral vapour control membrane
Promat TL board or similar and approved, fixed direct to underside of concrete slab soffit.

Detail 1 - Window head junction with brickwork

Powder coated aluminium/timber composite window to be installed in accordance with manufacturers recommendations. Colour: RAL 7015

2 courses of blue brick above dpc

Ground level varies.

Brickwork below DPC to be laid in 1:3 cement:sand mortar (sulphate resisting where required) to extend minimum two courses below ground level. Brickwork below this level may be replaced with blockwork.

Open perpend weepholes at max centres to drain cavity 900mm.
Lean mix cavity infill, top splayed towards outer leaf.

1200 Gauge polythene DPM. All joints 300mm lapped, twice, folded and taped to form 100mm min welded joint; joints lapped min. 150mm with DPC and sealed in accordance with manufacturer's instructions.

Detail - Window cill junction with brickwork

Foundations to Structural Engineer's design and specification

75mm Kingspan K10 insulation or similar and approved, mechanically fixed to underside of slab to provide U value of 0.24W/m²K

window manufacturer to provide coupled head restraint section - Size to be confirmed on site.

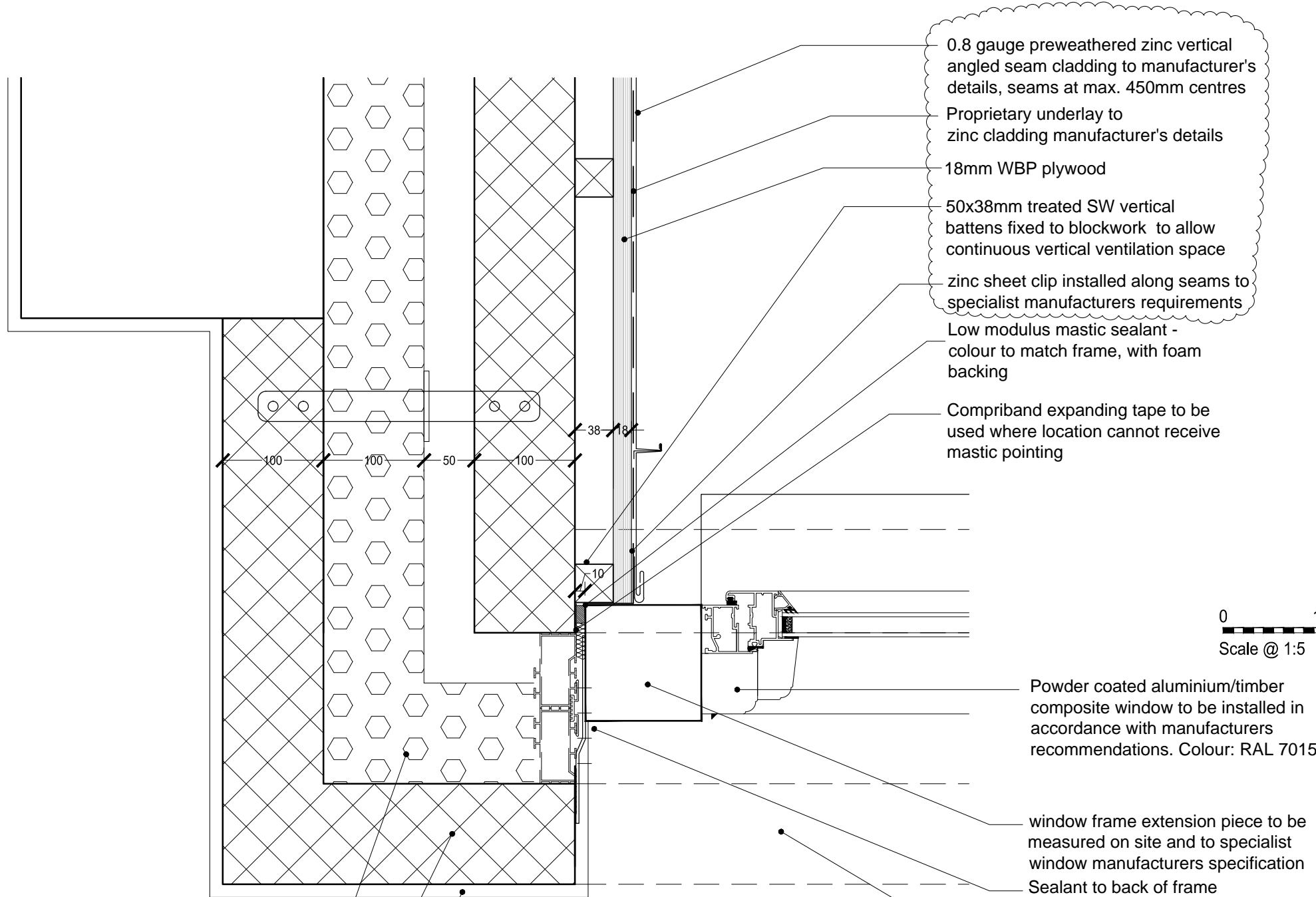

100mm Kingspan Kooltherm TW50 partial fill insulation or similar approved, installed with joints tightly butted to manufacturer's requirements - thickness to provide U value of 0.18W/m²K to overall wall construction.

100mm Blockwork, strength and control joints to Structural Engineer's requirements. Min mass 120Kg/m2 to comply with Approved Document E.

WET PLASTER - 13mm plaster and skim with galv. MS beading at corners and stops and EML at junctions of dissimilar materials.

Detail 3 - Window jamb junction with rainscreen cladding

Limitation of responsibilities
this drawing is not to be scaled.
the scope of the architects work is limited to the production of drawings and information leading to the commencement of work on site.
the architects are not responsible for the administration of the contract nor the quality of work on site.
decisions that are essential to the implementation of the construction on site are to be at the sole risk and discretion of the contractor and no responsibility is taken in contract or tort for any such decision.
the accuracy of 'as built' information is reliant upon the quality and completeness of the information provided by the main contractor.

NOTES:

NOTE
This drawing may be subject to revision and amendment due to instructions & comments by other including:

- Planning approval & conditions
- Building Regulations approval & conditions
- Client comments
- Employers Agent comments
- CPDA / Secured by Design comments
- M&E contractor design co ordination
- Engineering design
- Specialist subcontractor / supplier co ordination & comments

External wall construction 1
Target U-value = **0.18w/m²K**
External facing brickwork 102.5mm
Clear cavity 50mm
Cavity insulation (Kingspan TW50) - GWP < 5 100mm
Inner blockwork leaf 100mm
Wet plaster 13mm

External wall construction 2
Target U-value = **0.18w/m²K**
Render 15mm
Outer leaf blockwork 100mm
Clear cavity 50mm
Cavity insulation (Kingspan K17) - GWP < 5 80mm
Inner blockwork leaf 100mm
Plasterboard on dabs 13mm

External wall construction 3
Target U-value = **0.18w/m²K**
Zinc cladding 60mm
External facing blockwork 100mm
Clear cavity 50mm
Cavity insulation (Kingspan TW50) - GWP < 5 100mm
Inner blockwork leaf 100mm
Wet plaster 13mm

CFSH notes
Mat 1, Mat 2 and Mat 3
Bugler Developments to confirm which timber products need to be supplied with chain of custody certification

0 100 200 300 400 500mm
Scale @ 1:5

Powder coated aluminium/timber composite window to be installed in accordance with manufacturers recommendations. Colour: RAL 7015

window frame extension piece to be measured on site and to specialist window manufacturers specification
Sealant to back of frame

Min. 25mm MDF window board with rounded nosing extending 50mm beyond & returned to window reveals

C te 19/08/11 Window profile amended. Cladding amended to show zinc. Insulation added to u/s of commercial space. af
B te 28/02/11 Head detail revised. Issued for construction. af
A te 17/12/10 Issued for approval. af
rev by date revision cd.

status

For construction

1-5 St Pancras Way, NW1

Window head, cill and jamb details

Commercial space

date 16/12/10 drawn te 1:5 af
job number 0524 drawing number (21)15 revision C

MEPK
ARCHITECTS

10 - 18 Vestry Street
London N1 7RE
t: 020 7251 5573
f: 020 7251 5574
london@mepk.co.uk
www.mepk.co.uk