

notes:

**NOTE**  
This drawing may be subject to revision and amendment due to instructions & comments by other including:

Planning approval & conditions  
Building Regulations approval & conditions  
Client comments  
Employers Agent comments  
CPDA / Secured by Design comments  
M&E contractor design co ordination  
Engineering design  
Specialist subcontractor / supplier co ordination & comments

<b>External wall construction 1</b> <i>Target U-value = 0.18w/m²K</i> External facing brickwork 102.5mm Clear cavity 50mm Cavity insulation (Kingspan TW50) - GWP < 5 100mm Inner blockwork leaf 100mm Wet plaster 13mm
<b>External wall construction 2</b> <i>Target U-value = 0.18w/m²K</i> Render 15mm Outer leaf blockwork 100mm Clear cavity 50mm Cavity insulation (Kingspan K17) - GWP < 5 80mm Inner blockwork leaf 100mm Plasterboard on dabs 13mm
<b>External wall construction 3</b> <i>Target U-value = 0.18w/m²K</i> Zinc cladding 60mm External facing blockwork 100mm Clear cavity 50mm Cavity insulation (Kingspan TW50) - GWP < 5 100mm Inner blockwork leaf 100mm Wet plaster 13mm
<b>CFSH notes</b> Mat 1, Mat 2 and Mat 3 Bugler Developments to confirm which timber products need to be supplied with chain of custody certification

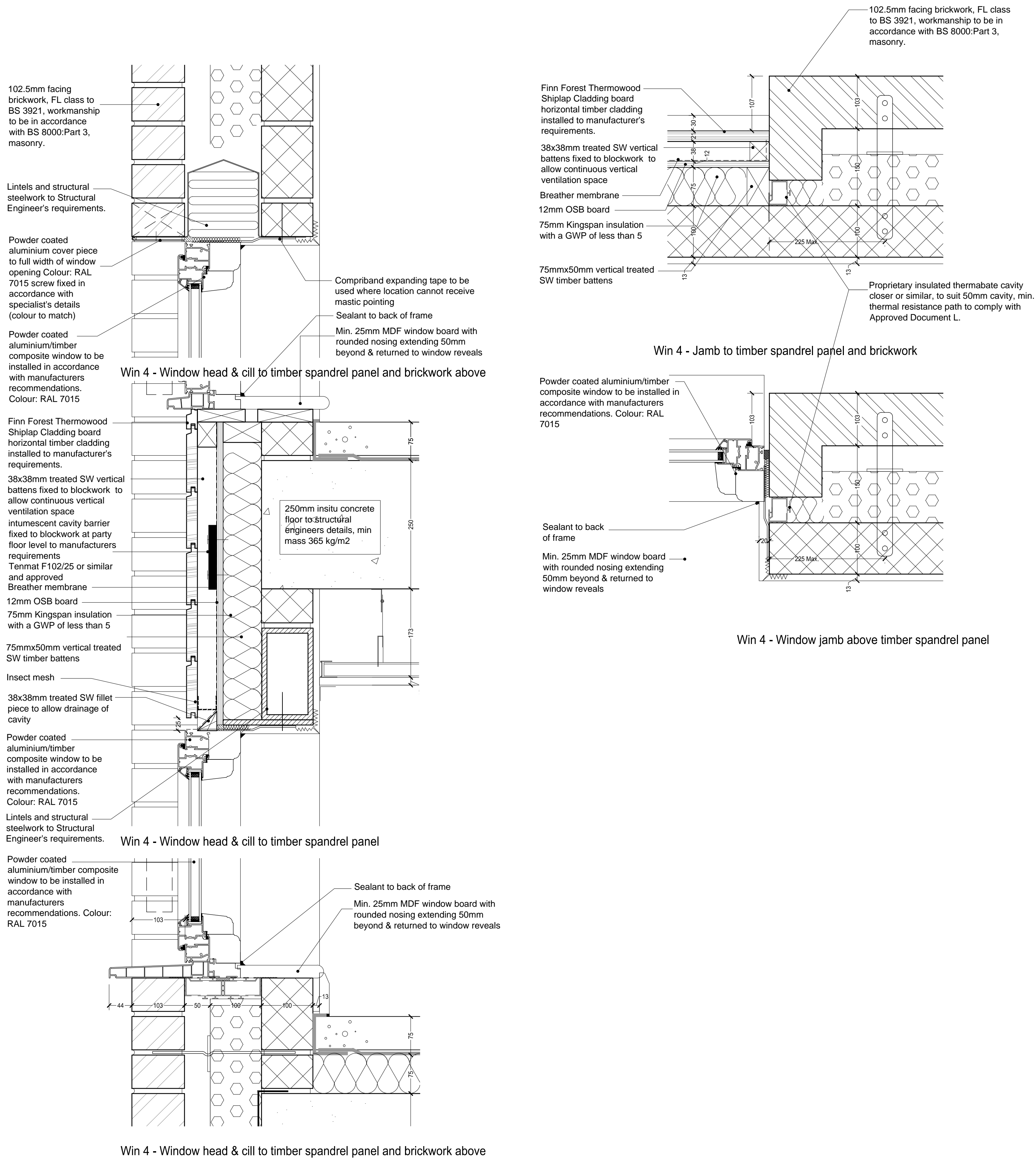
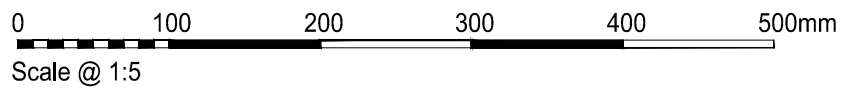

D	AF	13/10/11	aluminium cover strip added to window head detail Win4	
C	te	19/07/11	Window profiles revised. WIN 5 omitted.	
B	te	28/02/11	Issued for construction.	af
A	te	17/12/10	Issued for approval.	af
rev	by	date	revision	cd.

status

For construction

1-5 St Pancras Way, NW1

Window details

Sheet 2

date	drawn	scale	@ A1	cd.
16/12/10	te	1:5	af	
job number	drawing number	revision		
0524	(21)14	D		

**MEPK**  
ARCHITECTS

10 - 18 Vestry Street  
London N1 7RE  
t: 020 7251 5573  
london@mepk.co.uk  
www.mepk.co.uk