

Appendix 6: CCL Arboricultural Report Ref 08475/D

Tree Protection Plan
(Proposals Overlaid)

Poorly formed, low quality laburnum trees dia 15cm

Young holly
ht 3m
dia 6cm

T4

Shrub

Topped lime tree
ht 4.5m

T3

Holly,
ht 2m,
dia 6cm

16 Daleham Gardens

H7



Tree Protection Fencing
The 'In-Ground' System

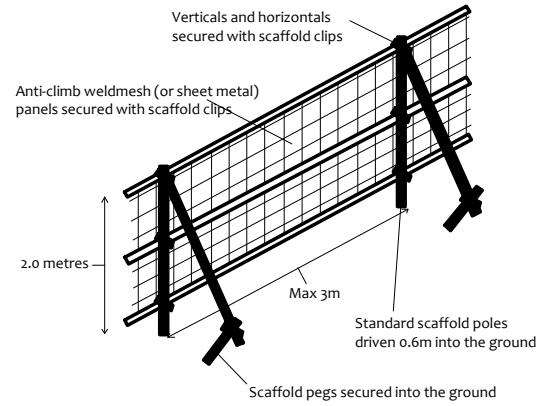

The 'Back Stay System'
(an alternative to 'The In-Ground System')

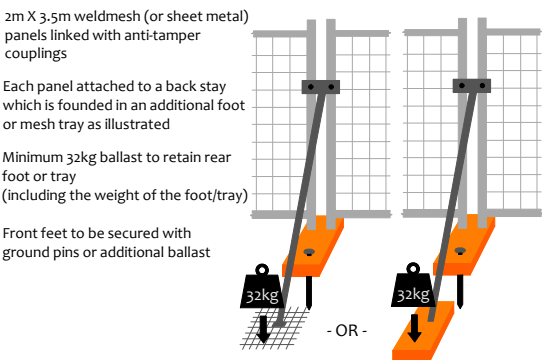

Construction Exclusion Zone

Within this area the following restrictions shall apply:
No excavation or land regrading whatsoever.
No storage of materials, rubble, soil or spoil.
No fires within the exclusion zone or within 10m of any tree canopy.
No site cabins or other temporary structures.
No discharge of polluted water, cement or chemicals of any kind.
No use of any machinery, or passage or parking of vehicles.
No tree works without council consent.

Restricted Activity Zone

Within this zone construction activity is restricted. Restrictions are detailed within the accompanying Method Statement Report (Section 5.10)

Dedicated Mixing and Cleaning Area

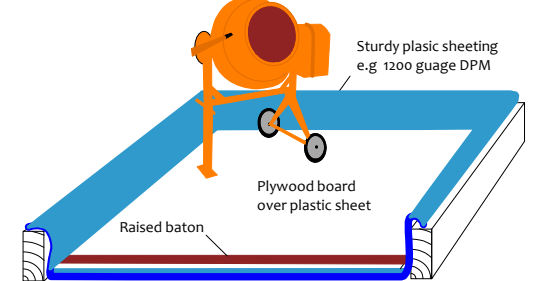

CROWN
Arboricultural Consultants
01422 316660

Site:
16 Daleham Gardens

Ref No: 08475C/TPP
Scale: 1:200
Paper Size: A3

T1 Tree number 1
G2 Group number 2
H3 Hedge number 3

BS 5837 Root Protection Area

Stem & canopy of Category A tree
Stem & canopy of Category B tree
Stem & canopy of Category C tree
Stem & canopy of Category R tree

Fixed protective fencing The 'In-Ground System' or the 'Backstay System' To remain in place for all construction activity

Restricted Activity Zone

Construction Exclusion Zones

0 5 10m