

Basement Floor Plan -Proposed

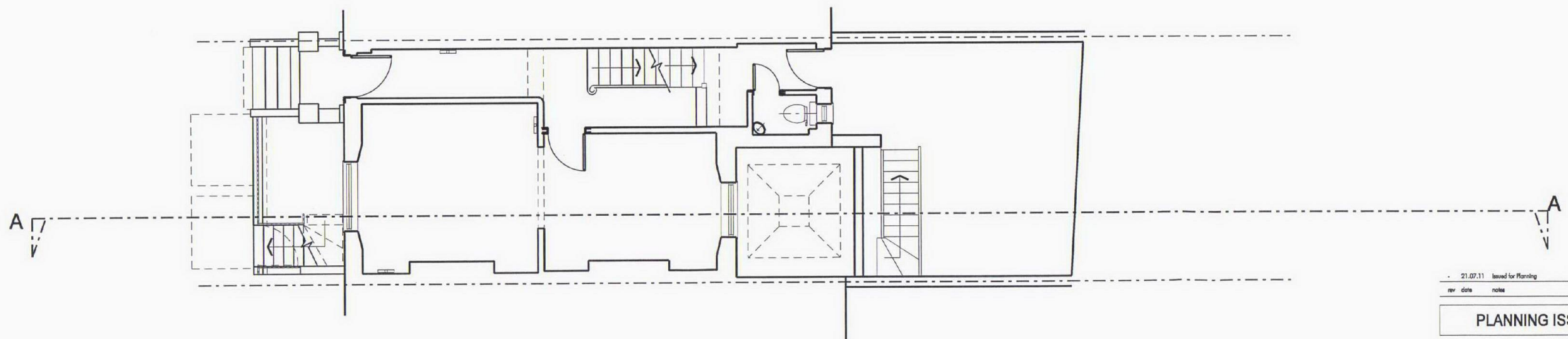

Ground Floor Plan - Proposed



21.07.11	Issued for Planning	RN	NW	
rev	date	notes	drawn by	checked by
PLANNING ISSUE				
AndArchitects				
16 Mandeville Courtyard, 142 Battersea Park Road, London SW11 4NB tel: +44 (0) 20 7720 8999 email: mail@andarchitects.co.uk				
client	Mr & Mrs Gillam			
project	12 Chamberlain Street NW1 8XB			
drawing title	Proposed Basement & Ground Floor Plan - Planning No4			
date	June 2011	scale	1: 50 @ A1 1: 100 @ A3	
drawing number	346 PL(4)102		revision	

All dimensions must be checked on site and any discrepancies reported to the architect before any work commences. DO NOT SCALE from this drawing. This drawing is the copyright of AND Architects Ltd and may not be copied or printed without express written permission from AND Architects Ltd