

Basement Floor Plan

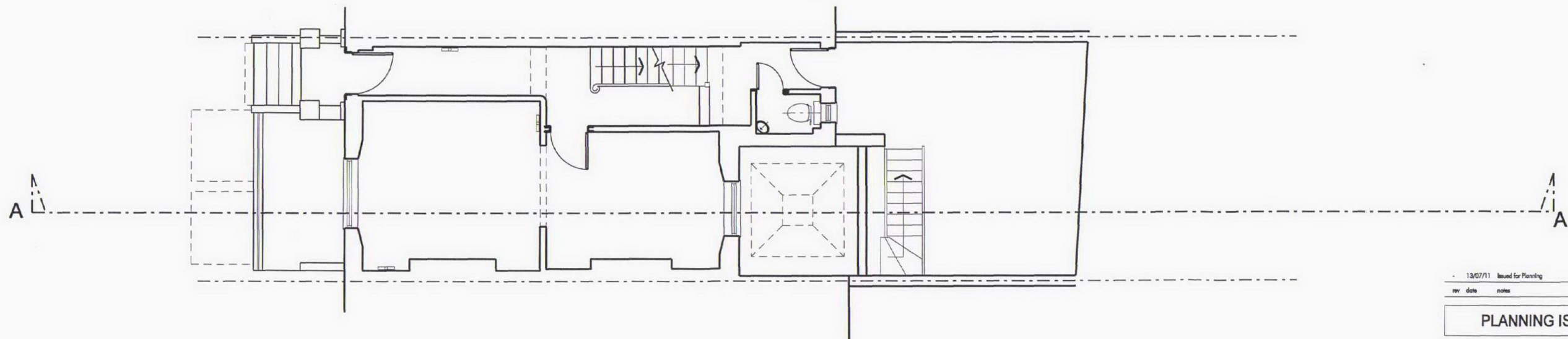

Ground Floor Plan

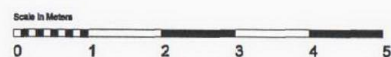

-	13/07/11	Issued for Planning	RN	NW
rev	date	notes	drawn by	checked by

PLANNING ISSUE

AndArchitects

16 Mandeville Court, 142 Battersea Park Road, London SW11 4NB
tel: +44 (0) 20 7720 5999 email: mail@andarchitects.co.uk

client
Mr & Mrs Gillam

project
12 Chamberlain Street
NW1 8XB

drawing title
Existing Basement & Ground
Floor Plan

date
June 2011

scale
1:50 @ A1
1:100 @ A3

drawing number
346 PL(0)002

revision
-

All dimensions must be checked on site and any discrepancies reported to the architect before any work commences. DO NOT SCALE from this drawing. This drawing is the copyright of AND Architects Ltd and may not be copied or printed without express written permission from AND Architects Ltd.