

DO NOT SCALE FROM THIS DRAWING. All dimensions must be verified by the main contractor before the commencement on site of any item of work or the preparation of shop drawings for their own work or that of sub-contractor or suppliers.
 This drawing is to be read in conjunction with all relevant documents.
 Any queries or discrepancies must be reported immediately to the architect.
 This document is copyright of DDWH Architects Ltd.

--- walls to be removed

(SD) Smoke detector ceiling mounted

Internal Stud Partition between Bathroom and Hallway to be 50 mm stud partition with 50mm thick mineral fibre or semi-rigid insulation fixed between the studs prior to plasterboard and skimming to provide sound insulation in internal partition. Ducts to be lined with with two layers of 12.5mm plasterboard or one layer of 12.5mm 'fireline' board. All partition to be constructed in line with British Gypsum White Book recommendation and stipulation.

Partitions and walls (new and existing) to bathrooms to be lined internally with 15mm Wedi Tilebacker or similar approved, and prepared for tiling.

Soil and vent pipes to be 110mm PVC-u to conform to BS4514. Waste pipes to be MPVC-u 32, 40 and 50mm to conform to BS5255. Waste pipes to be 32mm for basins, 40mm for sinks and baths. Sinks and basins to have 75mm deep seal traps, wc, baths and showers to have 50mm sealed traps. All exposed wastes to be in white MPVC-u. Provide rodding points at changes in direction. Branch connections from wash basins not to exceed 3m, kitchen sink not to exceed 3m for 40mm dia. branch pipe, bath branch connection not to exceed 3m length for 40mm dia. pipe, wc branch connections not to exceed 6m length. If these lengths are exceeded, branch pipes must be ventilated.

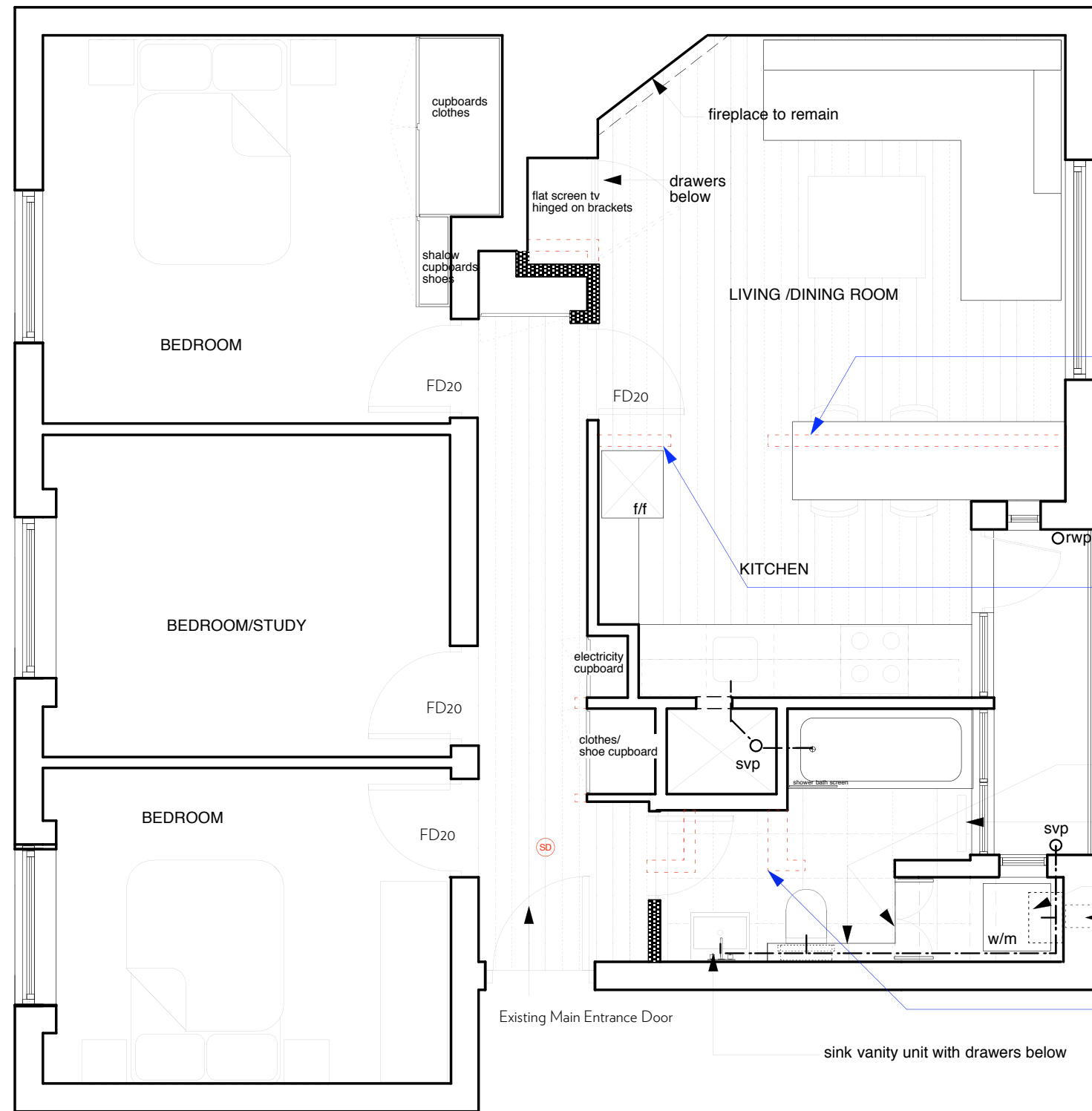

Partition 1
The view of wall between living room and kitchen proposed to be removed



Partition 1
The view of wall between living room and kitchen proposed to be removed

250 mm step to conceal the drainage pipes from the sink and the soil pipe from Wc

towel rail

existing boiler

existing boiler flue



Partition 2
The view of wall between bathroom and hall proposed to be removed

Rev	Date	Notes
a	Nov 2010	Toilet relocated
b	Jan 2011	wc wall revised
c	Sept 2011	Building Regulation notes added
d	Nov. 2011	Fireplace notes amended.

Project: 11 Barnfield NW3	Date: Sep 10
Client: M & J	Scale: 1:50
Drawing No: 132 - 102d	Drawn: dd
Drawing Title: Plan as Proposed Option	

DDWH Architects
 architecture urban design interior design
 27 barnfield upper park road, london nw3 2uu
 tel: 020 7691 0141
 fax: 020 7691 0142
 mail@ddwharchitects.com