

01 G09/D2n - External Elevation

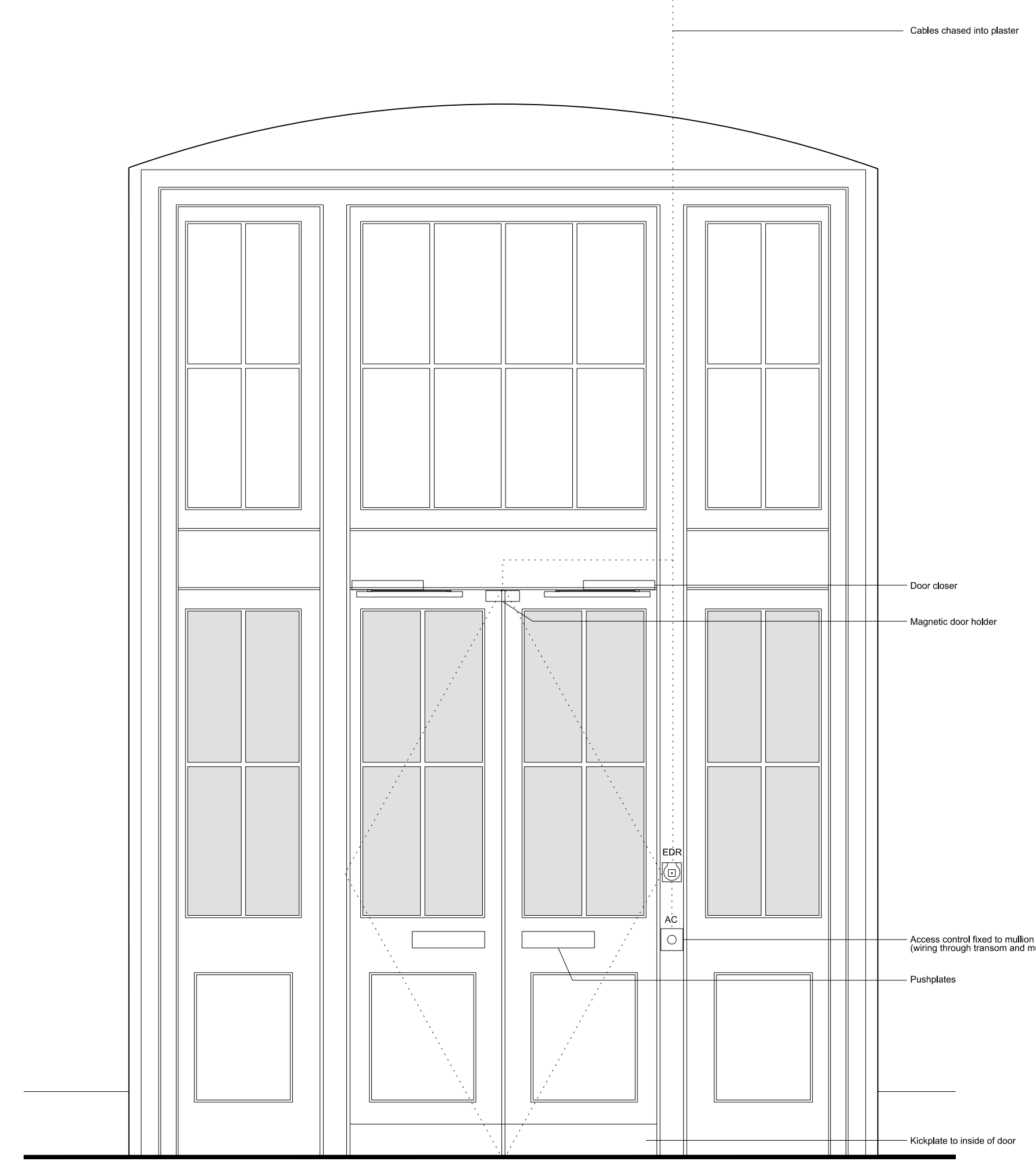

02 G09/D2n - Internal Elevation

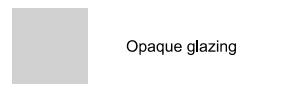

Door No	Room	Gridline	Material & Finish	Overpanel	Structural Opening	Leaf Height	Door Handing	Opening Force	Signage	Fire Requirements	Manifestation	Ironmongery	Access Control
G06/D2n	G/06a	W13/14	Timber/Glass	yes	As existing	2568	DD	TBC	n/a	none	n/a	SS thrust bearing hinges DORMA overhead door closer Horizontal pull handles externally Horizontal push plates internally Kickplate internally Door stop	Card Reader (both sides) Emergency Door Release Local Isolator Controller
G07a/D1n	G/07a	W12/13											Door Contact Magnetic Door Holder F/A Input/Output Relay
G09/D2n	G/09	W14/15										[TR4A in ironmongery schedule]	

Issue	Date	By	Chkd	Appd
01	07.07.11	JMP		

**John McAslan + Partners**  
 49 Princes Place London W11 4QA  
 Tel : +44 (0)20 7727 2663  
 Fax : +44 (0)20 7221 8835  
 www.mcaslan.co.uk

Architect  
 Landscape Architect



Job Title  
**King's Cross Station  
 Redevelopment Programme  
 Package 6**

Drawing Title  
**Western Range Building  
 External Doors  
 Sheet 3/7  
 G06/D2n G07a/D1n G09/D2n**

Scale at A1

CCMS No

Drawing Status  
**For Construction**

JMP Job No	Drawing No	Rev.
1365	ENG-SKE-JMP-WRB-CAZ-2152	01