

- Notes:-
1. This drawing represents design intent but the final built layout is subject to coordination by the architect.
 2. This drawing is to be read in conjunction with all Electrical, Mechanical, Public Health, Structural and Architectural drawings.
 3. Refer to schematics for ductwork sizes, pipework sizes and volume flow rates.
 4. All ductwork terminating in dampers or open ends must be finished with 60% free area insect mesh with maximum hole size 1mm unless otherwise specified.
 5. Dust filter unit containing a readily removable filter cartridge. Cartridge to hold a cut piece of G4 filter media over a cut piece of F7 filter media. Cartridge to be suitably robust and simple to operate. Design to be developed by contractor with specialist manufacturer and Architect.

C1	25/08/11	RW	AD	AS
Construction				
T2	17/03/11	MO	AD	AS
Tender				
T1	24/02/11	MO	AD	AS
Tender				
Issue	Date	By	Chkd	Appd

ARUP

13 Finsbury Street
London EC2N 2BN
Tel: +44 (0)20 7551 1531 Fax: +44 (0)20 7551 3024
www.arup.com

Client
The British Museum

Job Title
**British Museum
World Conservation and
Exhibitions Centre**

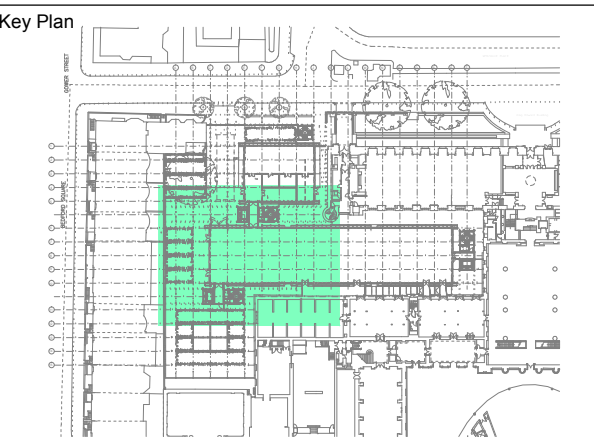

Drawing Title
**Mechanical Services
Level 6A
Special Extract Layout
Sheet B**

Scale at A0
1:50

Discipline
Mechanical

Job No
124020

Drawing Status
Construction

Drawing No
ARUP-50-DR-6AXB

Issue
C1