

- Notes:-
- This drawing represents design intent but the final built layout is subject to coordination by the architect.
  - This drawing is to be read in conjunction with all Electrical, Mechanical, Public Health, Structural and Architectural drawings.
  - Refer to schematics for ductwork sizes, pipework sizes and volume flow rates.
  - All ductwork terminating in dampers or open ends must be finished with 60% free area insect mesh with maximum hole size 1mm unless otherwise specified.

C1	28/08/11	RW	AD	AS
Construction				
T4	13/05/11	MO	AD	AS
Tender addendum				
Bell's Landing note				
T3	17/03/11	MO	AD	AS
Tender				
T2	24/02/11	MO	AD	AS
Tender				
T1	28/01/11	MO	AD	AS
For Information				
01	17/08/10	TB	AD	AS
Stage E				
Issue	Date	By	Chkd	Appd

**ARUP**

13 Finsbury Street  
London EC2A 1EJ  
Tel +44 (0)20 7551 1531 Fax +44 (0)20 7551 3024  
www.arup.com

Client  
The British Museum

Job Title  
British Museum  
World Conservation and  
Exhibitions Centre

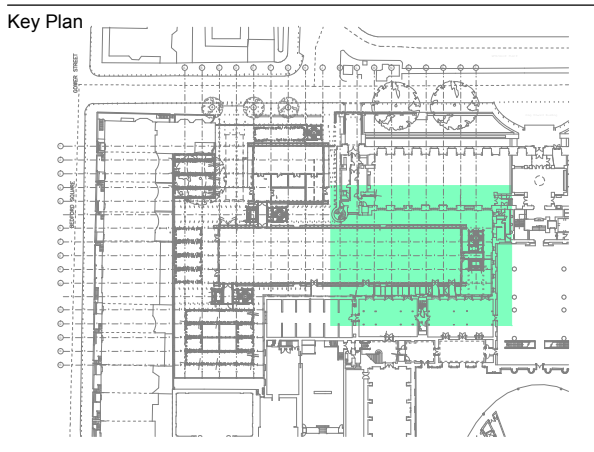

Drawing Title  
Mechanical Services  
Level 2 Layout  
Sheet C

Scale of A0  
1:50

Discipline  
Mechanical

Job No  
124020

Drawing Status  
Construction

Drawing No  
ARUP-50-DR-020C

Issue  
C1