



For continuation refer to drawing
-DR-062G

STAIR CORE LIGHTING FED VIA FIRE RATED BATTERY BACKED CABLING ONLY. REMOTE CHANGEOVER MODULE LOCATED ADJACENT TO STAIR CORE LIGHTING DB. EHA-2E/L1, EHA-2E/L2, EHA-2E/L3 MAINS CIRCUIT - DBA1H/K/L3

STAIR CORE LIGHTING FED VIA FIRE RATED BATTERY BACKED CABLING ONLY. REMOTE CHANGEOVER MODULE LOCATED ADJACENT TO STAIR CORE LIGHTING DB. EHA-2E/L1, EHA-2E/L2, EHA-2E/L3 MAINS CIRCUIT - DBA2H/K/L1

- Notes
1. Refer to architects drawings for setting out.
 2. This drawing is to be read in conjunction with all Electrical, Mechanical, Public Health, Structural & Architectural drawings.
 3. Where no luminaires are indicated cross refer to E3-series drawings.
 4. Motorised fire dampers are indicated on mechanical layouts. Allow for a single phase power supply (fused connection unit) to each.
 5. Leak detection probes required to all cavities in basement levels. Extent to be confirmed during stage F. Make allowance for a probe and power supply every 20m around perimeter.

Issue	Date	By	Chkd	Appd
C1	28/08/11	IM	DAD	AS
Construction				
T4	13/05/11	IM	AD	AS
Tender Addendum				
T3	17/03/11	MRC	DAD	AS
Tender				
T2	24/02/11	MRC	DAD	AS
Tender				
T1	28/01/11	MC	AD	AS
For Information				
01	17/08/10	MC	AD	AS
Stage E				

ARUP
 13 Fenny Street
 London W1T 4RG
 Tel: +44 (0)20 7591 1531 Fax: +44 (0)20 7596 3024
 www.arup.com

Client
The British Museum

Job Title
**British Museum
 World Conservation and
 Exhibitions Centre**

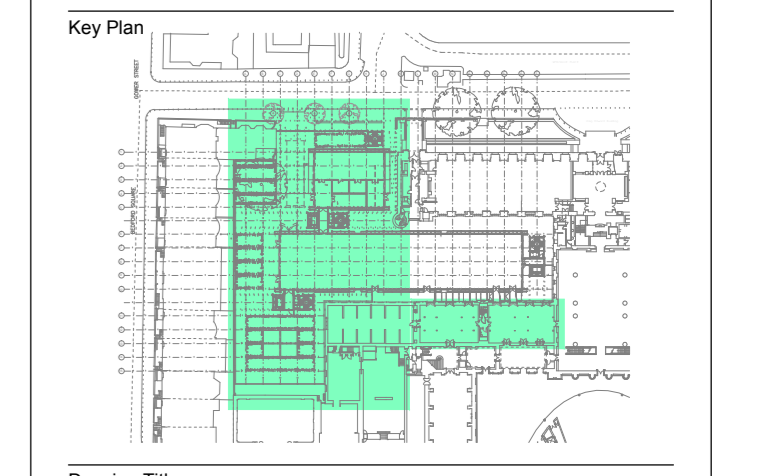

Drawing Title
**Electrical Services
 Level 6 Layout - High Level**

Sheet F Building 1, 2 & 5

Scale of A0: 1:50

Discipline: Electrical

Job No: 124020
 Drawing Status: Construction

Drawing No: ARUP-60-DR-062F

Issue: C1