

# Appendix 6: CCL Arboricultural Report Ref 08475/C

# Tree Protection Plan (Proposals Overlaid)

Poorly formed, low quality laburnum trees dia 15cm

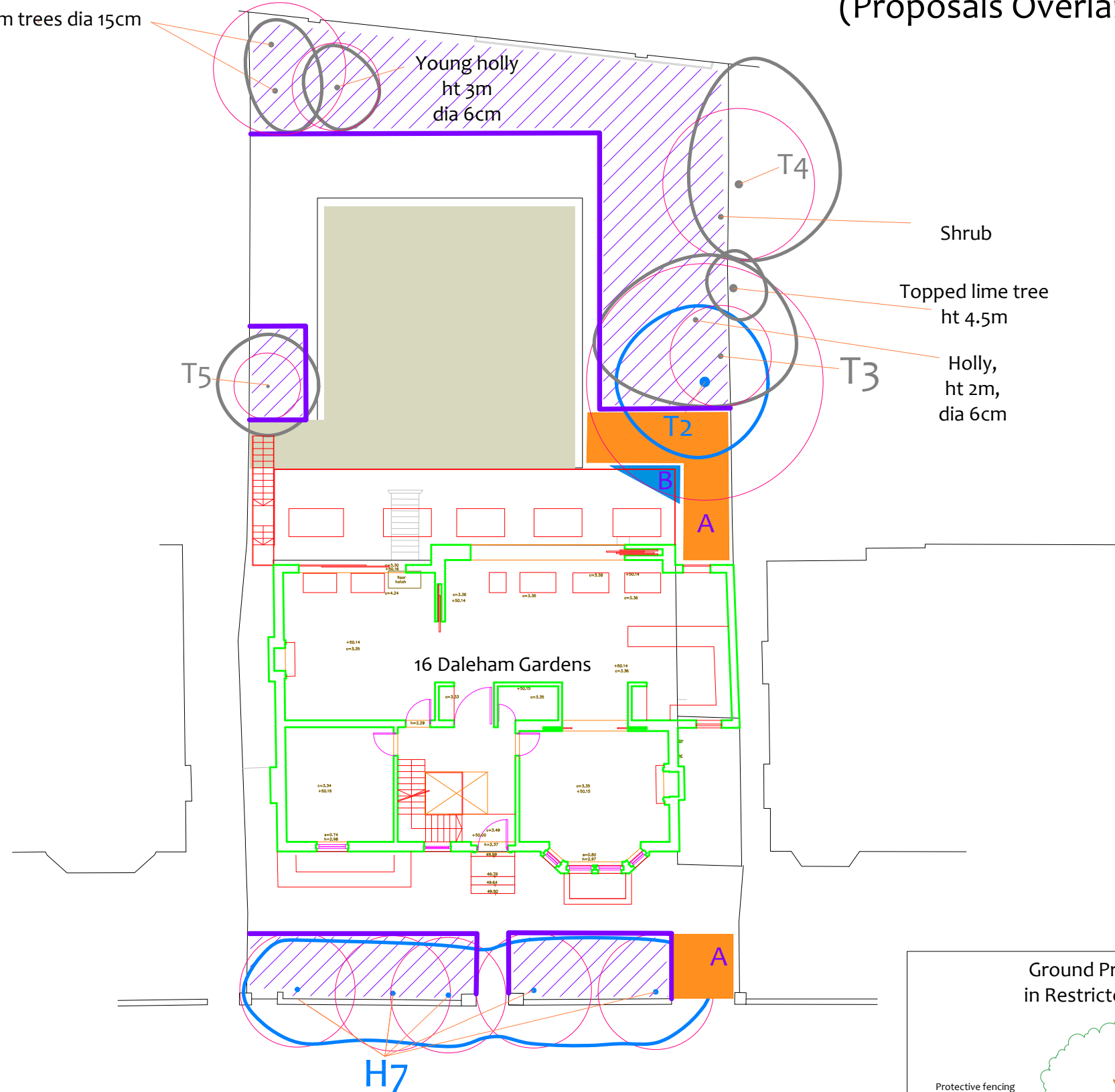

## Tree Protection Fencing The 'In-Ground' System

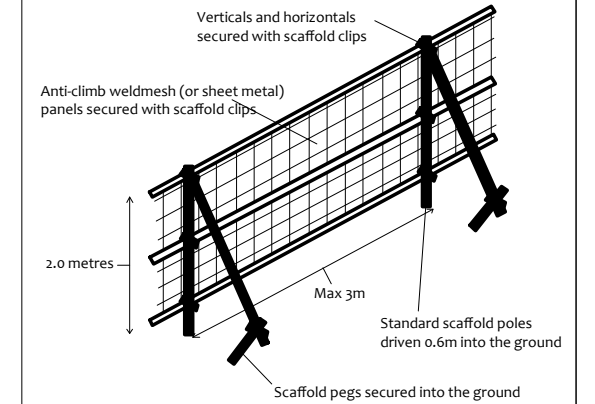

## The 'Back Stay System' (an alternative to 'The In-Ground System')

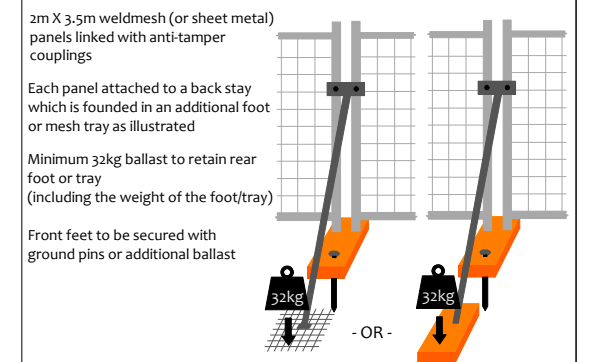

## Construction Exclusion Zone

- Within this area the following restrictions shall apply:
- No excavation or land regrading whatsoever.
  - No storage of materials, rubble, soil or spoil.
  - No fires within the exclusion zone or within 10m of any tree canopy.
  - No site cabins or other temporary structures.
  - No discharge of polluted water, cement or chemicals of any kind.
  - No use of any machinery, or passage or parking of vehicles.
  - No tree works without council consent.

## Restricted Activity Zones A and B

Within these zones construction activity is restricted. Restrictions are detailed within the accompanying Method Statement Report (Sections 5.11 and 5.12)

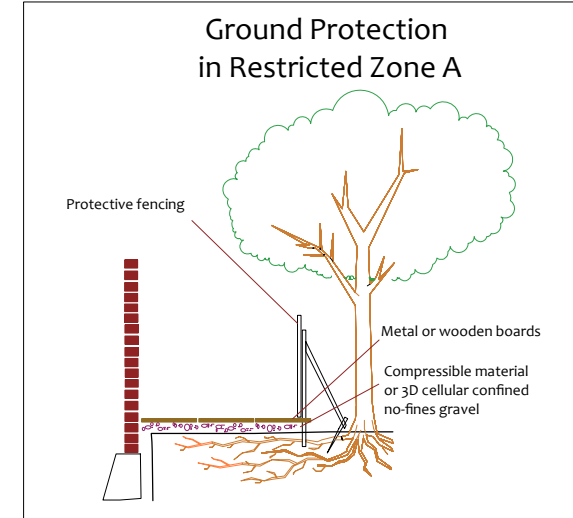

## Dedicated Mixing and Cleaning Area

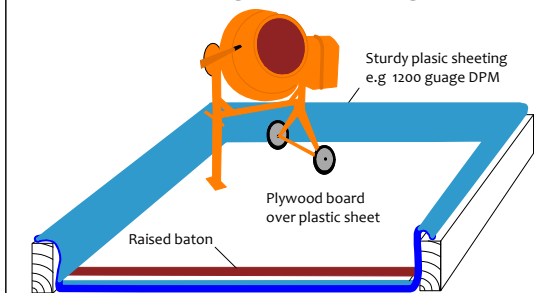

Site: 16 Daleham Gardens  
Ref No: 08475C/TPP  
Scale: 1:200  
Paper Size: A3

	BS 5837 Root Protection Area		Stem & canopy of Category A tree		Fixed protective fencing The 'In-Ground System' or the 'Backstay System' To remain in place for all construction activity
	T1 Tree number 1		Stem & canopy of Category B tree		Restricted Activity Zones
	G2 Group number 2		Stem & canopy of Category C tree		Construction Exclusion Zones
	H3 Hedge number 3		Stem & canopy of Category R tree		

