

Appendix 2: Drawings Submitted for Approval

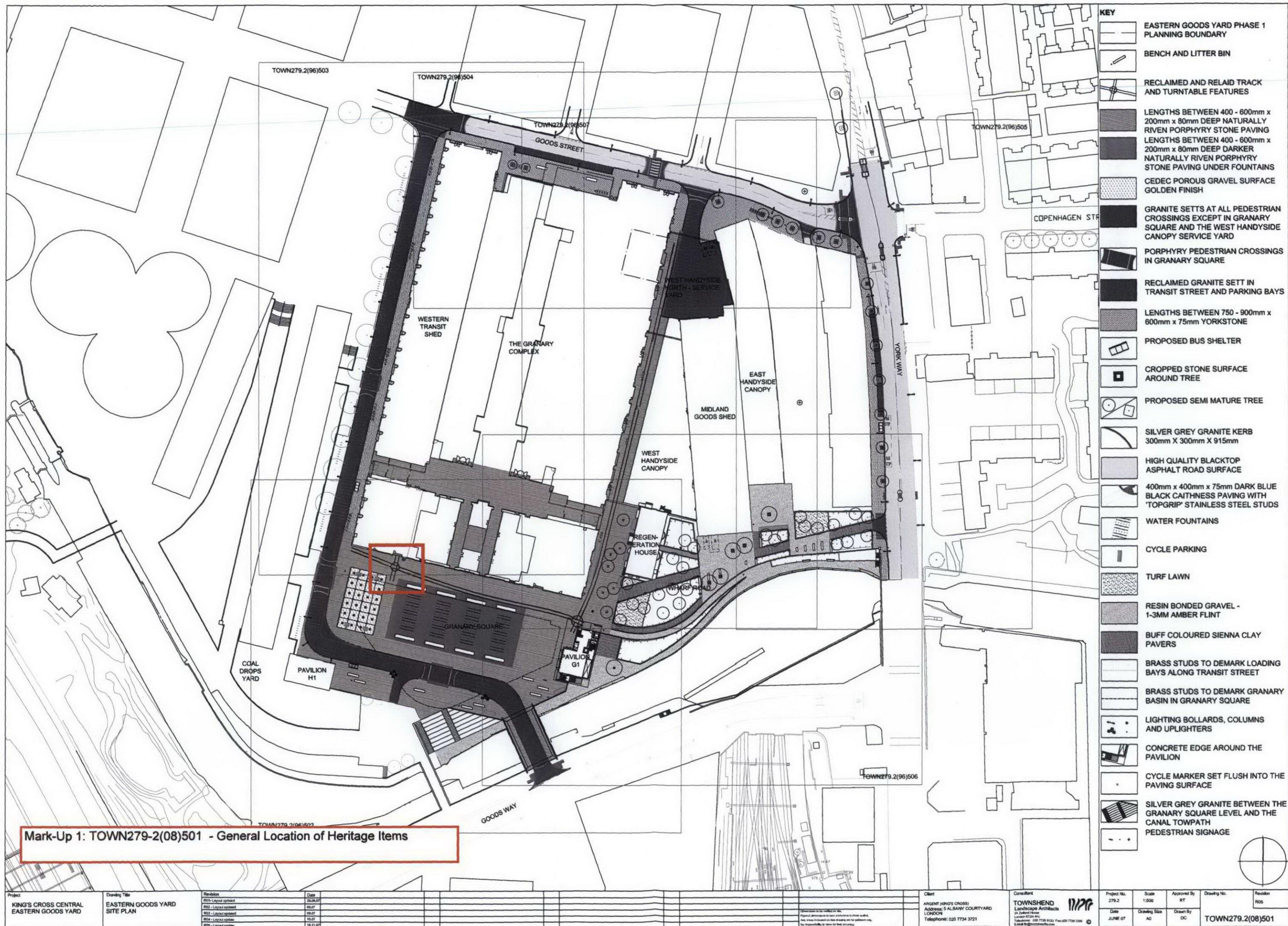



- Mark-Up 1: TOWN279-2(08)501 – General Location of Heritage Items Pursuant to Current Application
- 308/07 LD9736_P03 – Heritage items layout
- 308/07 LD9737_P01 – Crane base plan layout
- 308/07 LD9939_P02 – Capstan detail
- 308/07 LD9972_P02 – Turntable plan layout
- 308/07 LD9973_P01 – Turntable sections

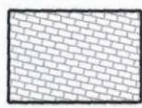

- KEY**
- EASTERN GOODS YARD PHASE 1 PLANNING BOUNDARY
 - BENCH AND LITTER BIN
 - RECLAIMED AND RELAID TRACK AND TURNABLE FEATURES
 - LENGTHS BETWEEN 400 - 600mm x 200mm x 80mm DEEP NATURALLY RIVEN PORPHYRY STONE PAVING
 - LENGTHS BETWEEN 400 - 600mm x 200mm x 80mm DEEP DARKER NATURALLY RIVEN PORPHYRY STONE PAVING UNDER FOUNTAINS
 - CEDEC POROUS GRAVEL SURFACE GOLDEN FINISH
 - GRANITE SETTS AT ALL PEDESTRIAN CROSSINGS EXCEPT IN GRANARY SQUARE AND THE WEST HANDYSIDE CANOPY SERVICE YARD
 - PORPHYRY PEDESTRIAN CROSSINGS IN GRANARY SQUARE
 - RECLAIMED GRANITE SETT IN TRANSIT STREET AND PARKING BAYS
 - LENGTHS BETWEEN 750 - 900mm x 600mm x 75mm YORKSTONE
 - PROPOSED BUS SHELTER
 - CROPPED STONE SURFACE AROUND TREE
 - PROPOSED SEMI MATURE TREE
 - SILVER GREY GRANITE KERB 300mm X 300mm X 915mm
 - HIGH QUALITY BLACKTOP ASPHALT ROAD SURFACE
 - 400mm x 400mm x 75mm DARK BLUE BLACK CAITNESS PAVING WITH 'TOPGRIP' STAINLESS STEEL STUDS
 - WATER FOUNTAINS
 - CYCLE PARKING
 - TURF LAWN
 - RESIN BONDED GRAVEL - 1-3MM AMBER FLINT
 - BUFF COLOURED SIENNA CLAY PAVERS
 - BRASS STUDS TO DEMARK LOADING BAYS ALONG TRANSIT STREET
 - BRASS STUDS TO DEMARK GRANARY BASIN IN GRANARY SQUARE
 - LIGHTING BOLLARDS, COLUMNS AND UPLIGHTERS
 - CONCRETE EDGE AROUND THE PAVILION
 - CYCLE MARKER SET FLUSH INTO THE PAVING SURFACE
 - SILVER GREY GRANITE BETWEEN THE GRANARY SQUARE LEVEL AND THE CANAL TOWPATH PEDESTRIAN SIGNAGE

Project KING'S CROSS CENTRAL EASTERN GOODS YARD	Drawing Title EASTERN GOODS YARD SITE PLAN	Revision R001 - Layout updated R002 - Layout updated R003 - Layout updated R004 - Layout updated R005 - Layout updated	Date 26.06.07 29.07 09.07 10.07 16.11.07	Client ARGENT (KING'S CROSS) ADDRESS: 5 ALBANY COURT YARD LONDON Telephone: 020 7734 3721	Consultant TOWNSEND Landscape Architects 11777 London EC2A 4NE Telephone: 020 7729 9333 Fax: 020 7729 1000 E: info@townsend.co.uk	Project No. 279.2 Scale 1:500 Date JUNE 07 Approved By RT Drawn By DC	Drawing Size A0 Revision R05 Drawing No. TOWN279.2(08)501
--	---	--	--	--	--	---	---

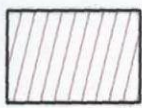
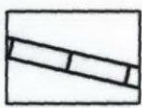
KEY

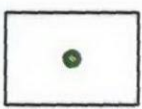
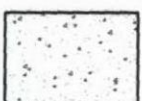
-  GRANARY MARGIN THRESHOLDS, BETWEEN RAILTRACKS AND AROUND PdM BENCHES
RECLAIMED GRANITE SETTS - SAWN TOP
120-250mm long x 90-140mm wide x 100mm deep
-  GRANARY MARGIN / INFILL TO HERITAGE ITEMS
RECLAIMED GRANITE SETTS - ROUGH TOP
120-250mm long x 90-140mm wide x 100mm deep
-  GRANARY SQUARE (Inside of canal basin)
PORPHYRY PAVING (UNIFORM LENGTHS)
200mm wide x 394 & 594mm long x 55mm thick.
-  GRANARY SQUARE (Outside of canal basin)
PORPHYRY PAVING (RANDOM LENGTHS)
200mm wide x 400-600mm long x 55mm thick.
-  GRANARY SQUARE (Canal basin demarcation)
PORPHYRY DEMARCATION BAND
900mm long x 300mm wide x 80mm thick
with specials at corners
-  GRANARY SQUARE (Tree planting grid demarcation)
GRANITE KERB
900mm long x 300mm wide x 200mm thick
-  GRANARY SQUARE (Tree planting grid)
CEDEC GRAVEL
Colour: Red
-  GRANARY SQUARE (Tree planting grid)
TREE LOCATION
-  PdM BENCH FOUNDATIONS
NEW CAST INSITU CONCRETE

REFER TO FOLLOWING DRAWINGS FOR HERITAGE DETAILS:

TURNTABLE: LD9972 & LD9973
CAPSTAN: LD9939
CRANE BASE: LD9737

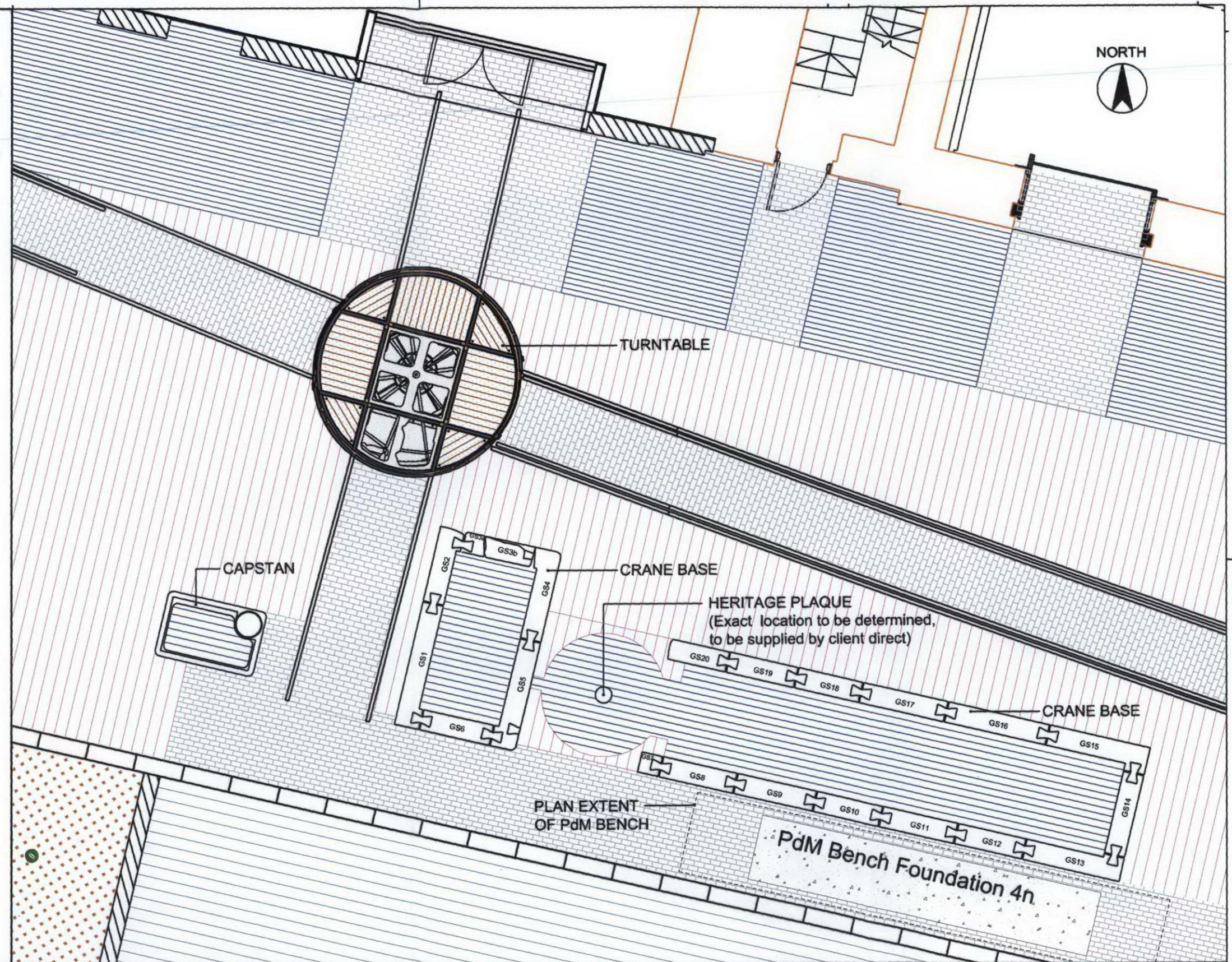

LANDSCAPE ARCHITECT:

APPLIED LANDSCAPE DESIGN

The Threshing Barn, Bignell Park Bams,
Chesterton, Oxfordshire, OX26 1TD
Tel: 01869 249776 Fax: 01869 327513
Email: mail@appliedlandscape.co.uk

© 2011 Applied Landscape Design Limited. All rights reserved.

P03	Key added. Granite hatch revised.	25.11.11
P02	Porphyry paving revised.	23.11.11
P01	First issue for comment.	22.11.11

no.	revision	date
-----	----------	------

PROJECT:

King's Cross Central
Eastern Goods Yard

CLIENT:



drawn:

HL

scale:

1:75 A3

status:

Approval

checked:

AB

date:

22.11.2011

xref file ref:

ald-egy-paving

DRAWING TITLE:

EGY GRANARY SQUARE
HERITAGE ITEM LOCATIONS

PROJECT NO.

308/07

DRAWING NUMBER:

LD9736

REVISION:

P03

ORIGINAL A3 SIZE SHEET

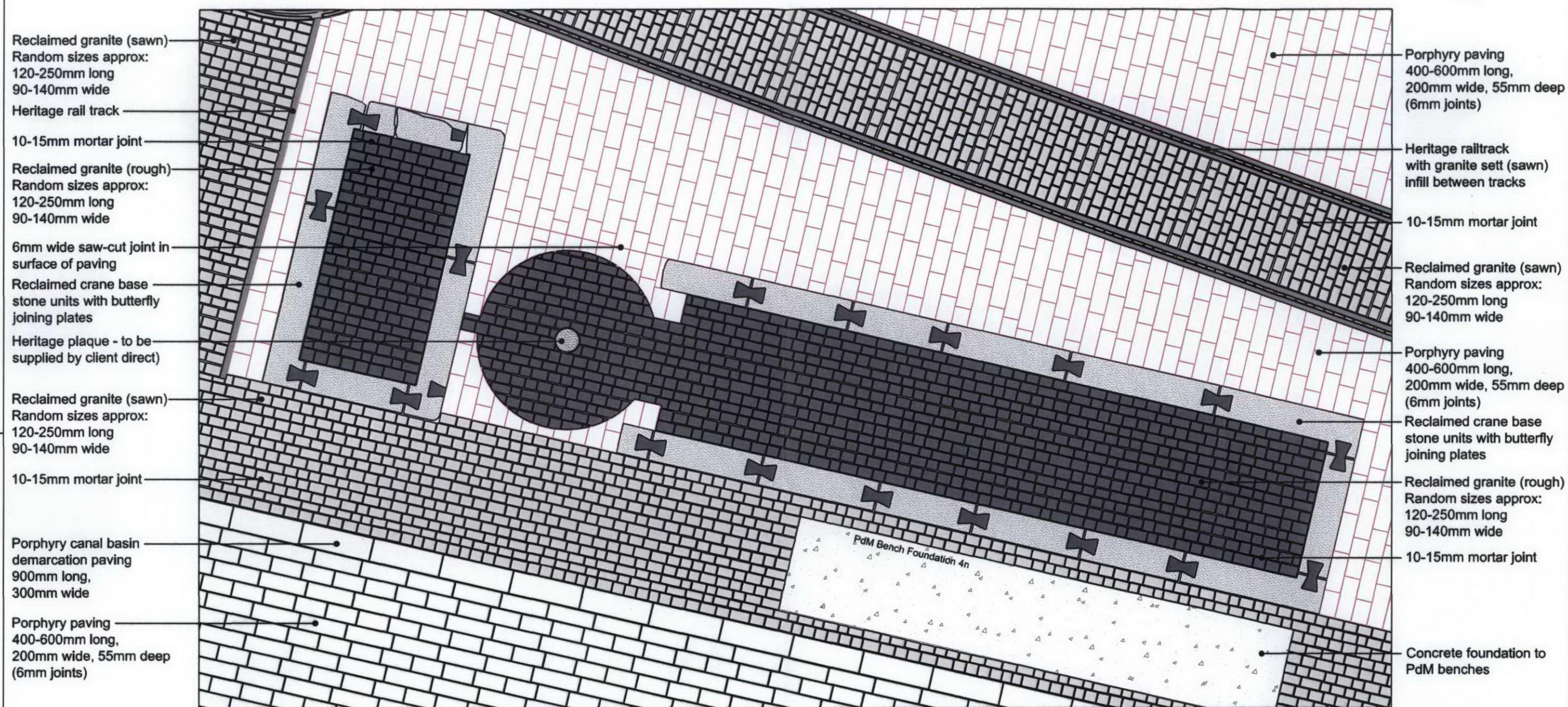

LANDSCAPE ARCHITECT:

APPLIED LANDSCAPE DESIGN

The Threshing Barn, Bignell Park Barns,
Chesterton, Oxfordshire, OX26 1TD
Tel: 01869 249776 Fax: 01869 327513
Email: mail@appliedlandscape.co.uk

© 2011 Applied Landscape Design Limited. All rights reserved.

P01	First issue for comment.	25.11.11
no.	revision	date

PROJECT: King's Cross Central
Eastern Goods Yard



drawn: AB	checked: KmJ
scale: 1:75 @ A3	date: 25.11.2011
status: Comment	xref file ref: ald-egy-crane base

DRAWING TITLE:
**EGY HERITAGE CRANE BASE
DETAILED PLAN LAYOUT**

PROJECT NO. 308/07	DRAWING NUMBER: LD9737	REVISION: P01
------------------------------	----------------------------------	-------------------------

ORIGINAL A3 SIZE SHEET

NOTE:
CAPSTAN EXTENTS APPROXIMATE

RECLAIMED ROUGH TOP GRANITE SETTS
CUT TO RADIUS OF CAPSTAN FRAME

HERITAGE CAPSTAN (RECOVERED FROM SITE)
CAPSTAN SURFACES TO BE CLEANED WITH STIFF
WIRE BRUSH PRIOR TO INSTALLATION.

EXTENT OF CAPSTAN FRAME

RECLAIMED ROUGH TOP GRANITE SETTS
120-250mm LONG x 110-140mm WIDE x 100mm
DEEP APPROX.

PORPHYRY PAVING, 400-600mm LONG,
200mm WIDE, 55mm DEEP

6mm TUFFGROUT MORTAR JOINT
COLOURED TO MATCH PAVING
BY STEINTEC OR EQUAL & APPROVED

RECLAIMED ROUGH TOP GRANITE SETTS
120-250mm LONG x 110-140mm WIDE x 100mm
DEEP APPROX.

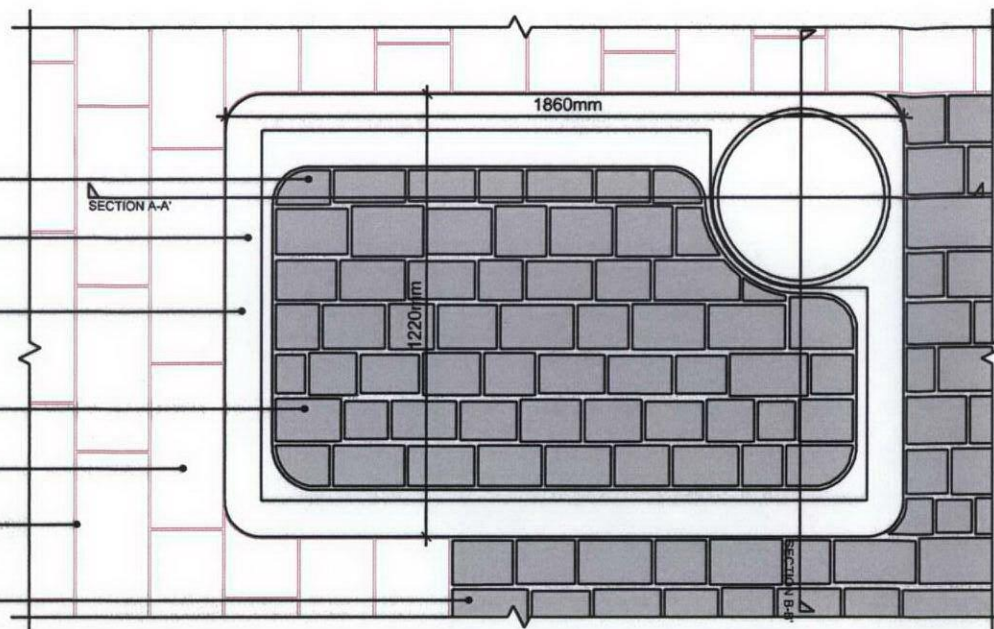

DETAIL 1.01 - CAPSTAN PLAN LAYOUT EXCERPT

HERITAGE CAPSTAN (RECOVERED FROM SITE)
CAPSTAN SURFACES TO BE CLEANED WITH STIFF
WIRE BRUSH PRIOR TO INSTALLATION.

RECLAIMED ROUGH TOP GRANITE SETTS
120-250mm LONG x 110-140mm WIDE x 100mm DEEP APPROX.

10-15mm TUFFGROUT MORTAR JOINT COLOURED TO
MATCH PAVING BY STEINTEC OR EQUAL & APPROVED

PORPHYRY PAVING, 400-600mm LONG, 200mm WIDE, 55mm DEEP

6mm TUFFGROUT MORTAR JOINT
COLOURED TO MATCH PAVING
BY STEINTEC OR EQUAL & APPROVED

40mm TUFFBED BEDDING MORTAR
WITH TUFFBOND PRIMING MORTAR
BY STEINTEC OR EQUAL & APPROVED

DRY MIX ROLLED CONCRETE ROADBASE
TO ENGINEER'S DETAIL AND SPECIFICATION

CAPSTAN FRAME

TYPE 1 SUB BASE
BUILD UP TO ENGINEERS DETAIL
AND SPECIFICATION (PBA F4)

CONCRETE BEDDING AND HAUNCHING
TO ENGINEER'S DETAIL AND SPECIFICATION.

MORTAR FILL TO VOID BENEATH CAPSTAN
TOP PLATE

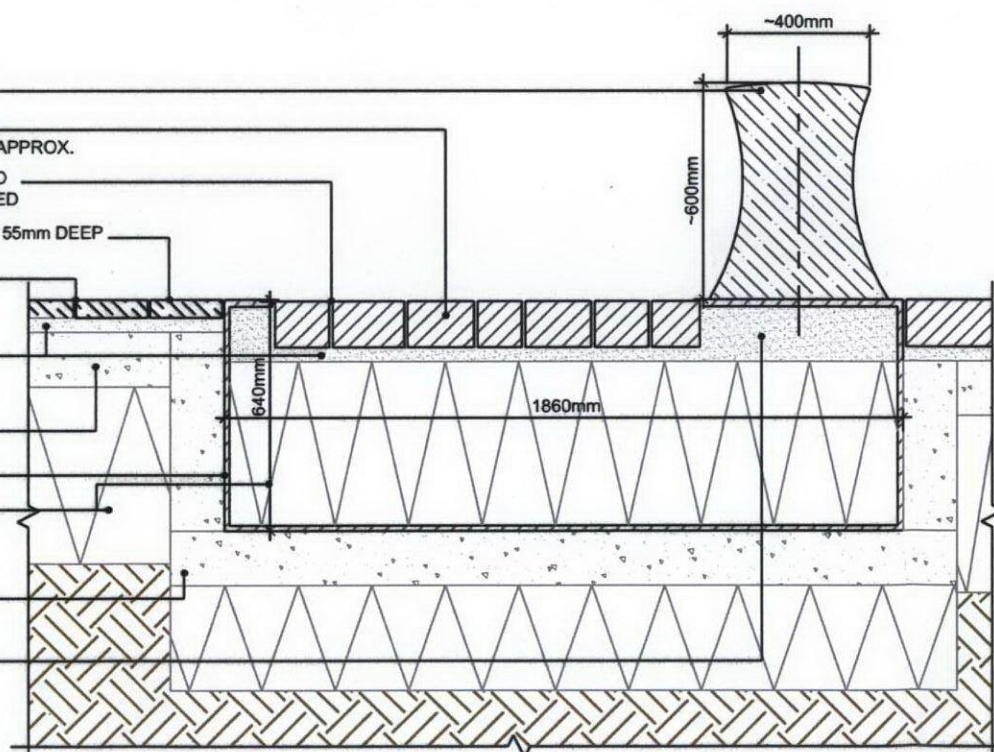

DETAIL 1.02 - SECTION A-A' CAPSTAN

RECLAIMED ROUGH TOP GRANITE SETTS
120-250mm LONG x 110-140mm WIDE x 100mm DEEP APPROX.

10-15mm TUFFGROUT MORTAR JOINT COLOURED TO
MATCH PAVING BY STEINTEC OR EQUAL & APPROVED

HERITAGE CAPSTAN (RECOVERED FROM SITE)
CAPSTAN SURFACES TO BE CLEANED WITH STIFF
WIRE BRUSH PRIOR TO INSTALLATION.

6mm TUFFGROUT MORTAR JOINT
COLOURED TO MATCH PAVING
BY STEINTEC OR EQUAL & APPROVED

PORPHYRY PAVING, 400-600mm LONG,
200mm WIDE, 55mm DEEP

40mm TUFFBED BEDDING MORTAR
WITH TUFFBOND PRIMING MORTAR
BY STEINTEC OR EQUAL & APPROVED

CONCRETE FOUNDATION
TO ENGINEER'S DETAIL & SPECIFICATION

CAPSTAN FRAME

TYPE 1 SUB BASE
BUILD UP TO ENGINEERS DETAIL
AND SPECIFICATION

CONCRETE BEDDING AND HAUNCHING
TO ENGINEER'S DETAIL AND SPECIFICATION.

MORTAR FILL TO VOID BENEATH CAPSTAN
TOP PLATE

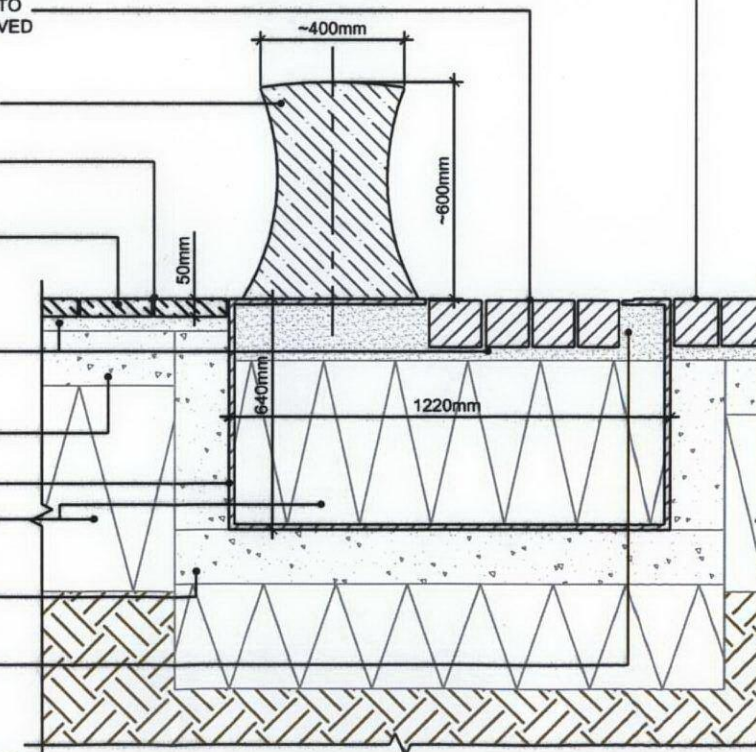

DETAIL 1.03 - SECTION B-B' CAPSTAN

LANDSCAPE ARCHITECT:

APPLIED LANDSCAPE DESIGN

The Threshing Barn, Bignell Park Barns,
Chesterton, Oxfordshire, OX26 1TD
Tel: 01869 249776 Fax: 01869 327513
Email: mail@appliedlandscape.co.uk

© 2011 Applied Landscape Design Limited. All rights reserved.

P02	Capstan frame dimensions revised and added.	23.11.11
P01	Issued for comment.	22.11.11
no.	revision	date

PROJECT:

**King's Cross Central
Eastern Goods Yard**

CLIENT:



drawn:

HL

scale:

1:20 @ A3

status:

Information

checked:

AB

date:

22.11.11

xref file ref:

egy-furniture details

DRAWING TITLE:

**RECLAIMED CAPSTAN
IN GRANARY SQUARE**

PROJECT NO.
308/07

DRAWING NUMBER:
LD9939

REVISION:
P02

ORIGINAL A3 SIZE SHEET

Reclaimed rail track

Reclaimed granite (smooth)
Random sizes approx:
120-250mm long
90-140mm wide

10-15mm 'Tuffgrout'
pavement jointing mortar
by Steintec or equal & app.

Curved timber infill to fill void
between outer and inner frame

34mm (pedestrian class)
toughened glass infill to centre
and southern panels of
turntable with tactile surface
(dot matrix pattern) finish.
To BS6399 (Part 1) and
EN12543 (Parts 1-6)

Timber plank infill to turntable
nominal 120mm wide x 40mm
thick. Timber type, fixings and
anti-slip surface treatment tbc.

Turntable outer frame

Turntable inner frame

Reclaimed granite (rough)
Random sizes approx:
120-250mm long
90-140mm wide

10-15mm 'Tuffgrout'
pavement jointing mortar
by Steintec or equal & app.

Porphyry paving
400-600mm long
200mm wide
55mm deep,

6mm 'Tuffgrout' pavement
jointing mortar by Steintec
or equal and approved.

Reclaimed granite (smooth)
infill between tracks
Random sizes approx:
120-250mm long
30mm wide approx.

6mm stainless steel frame to
glass and timber infill panels

4no. 'corner' panels secured
with surface accessed clamp
fixings. All other panels to be
clamped from underside, and
accessed by removing corner
panel/s first. Securing bolts to
be capped with timber plug.

NOTE:
Refer to ALD drawing LD9973 for section detail X-X'

LANDSCAPE ARCHITECT:

APPLIED LANDSCAPE DESIGN

The Threshing Barn, Bignell Park Barns,
Chesterton, Oxfordshire, OX26 1TD
Tel: 01869 249776 Fax: 01869 327513
Email: mail@appliedlandscape.co.uk

© 2011 Applied Landscape Design Limited. All rights reserved.

P01	First issue for comment.	10.11.11
no.	revision	date

PROJECT: King's Cross Central
Eastern Goods Yard

CLIENT: 

drawn: AB	checked: KmJ
scale: 1:25 A3	date: 10.11.2011
status: Approval	xref file ref: ald-egy-turntable

DRAWING TITLE:

EGY WEST TURNTABLE
PLAN LAYOUT DETAIL

PROJECT NO. 308/07	DRAWING NUMBER: LD9972	REVISION: P01
-----------------------	---------------------------	------------------

ORIGINAL A3 SIZE SHEET

Turntable inner frame

Curved timber infill to fill void
between outer and inner frame

Turntable outer frame

40mm10-15mm 'Tuffgrout'
pavement jointing mortar
by Steintec or equal & app.

Reclaimed granite (smooth)
Random sizes approx:
120-250mm long
90-140mm wide

20-40mm 'Tuffgrout' bedding mortar
by Steintec or equal & app.

Paving build-up to Engineer's detail & specification

Turntable foundation and ducting to
Engineer's detail and specification

2no. spotlights clamp-mounted on spoke
Spotlights located under timber panel sections
so as to be hidden from view from above

DETAIL A:

SECTION X-X' - LONG SECTION THROUGH TURNTABLE

1:25 @ A3

34mm (pedestrian class) toughened
glass infill to central and southern
panels of turntable with tactile surface
(dot matrix pattern) finish.
To BS6399 (Part 1) and
EN12543 (Parts 1-6).

Threaded bolt fixing attached to
underside of stainless steel frame,
with fixing plate and locking nut
accessed from underside.

Timber plank infill to turntable nominal
120mm wide x 40mm thick. Timber
type & anti-slip surface treatment tbc.

Railtrack in turntable

Timber plank infill to turntable. Nominal
120mm wide x 40mm thick, resin fixed
stainless steel frame. Timber type and
anti-slip finishes to specialist timber
manufacturers recommendation.

6mm thick stainless steel frame with
additional mesh reinforcement across base

Threaded bolt fixing attached to underside
of stainless steel frame, with fixing plate
and locking nut accessed from underside.

Packing to suit

30 x 6mm neoprene gaskets with
silicone joint over gasket between
stainless steel frame and railtrack

6mm silicone joint over glazing packer
between glass and SS frame

34mm (pedestrian class) toughened glass infill
to centre and southern panels of turntable with
tactile surface (dot matrix pattern) finish.
To BS6399 (Part 1) and EN12543 (Parts 1-6)
By specialist manufacturer.

30 x 6mm neoprene gasket

6mm thick stainless steel edge frame

Packing to suit

30 x 6mm neoprene gaskets with
silicone joint over gasket between
stainless steel frame and railtrack

DETAIL B:

INSET DETAIL ON RAILTRACK INTERFACE WITH INSET PANELS

1:5 @ A3

NOTE:
Refer to ALD drawing LD9972 for plan layout

LANDSCAPE ARCHITECT:

APPLIED LANDSCAPE DESIGN

The Threshing Barn, Bignell Park Barns,
Chesterton, Oxfordshire, OX26 1TD
Tel: 01869 249776 Fax: 01869 327513
Email: mail@appliedlandscape.co.uk

© 2011 Applied Landscape Design Limited. All rights reserved.

P01	First issue for comment.	10.11.11
no.	revision	date

PROJECT:

King's Cross Central
Eastern Goods Yard

CLIENT:



drawn:

AB

scale:

As shown @ A3

status:

Approval

checked:

KmJ

date:

10.11.2011

xref file ref:

ald-egy-turntable

DRAWING TITLE:

EGY WEST TURNTABLE
SECTION DETAILS

PROJECT NO.
308/07

DRAWING NUMBER:
LD9973

REVISION:
P01

ORIGINAL A3 SIZE SHEET