

**GHA trees**  
**1 Colinswood House**  
**Collinswood Road**  
**Farnham Common**  
**BUCKS**  
**SL2 3LN**



**t: 01753 643760**  
**e: [glen@ghatrees.co.uk](mailto:glen@ghatrees.co.uk)**  
**[www.ghatrees.co.uk](http://www.ghatrees.co.uk)**

**Glen Harding**  
**TECH CERT (ARBOR. A)**

## **Planting Specification & Aftercare Management Plan for: 2 Quickwood, London, NW3 3SJ**

28<sup>th</sup> October 2011

Ref: GHA/PS/69:11

# Tree / Shrub Planting Scheme

Location: 2 Quickswood, London, NW3 3SJ  
Ref: GHA/PS/69:11  
Client: Mr. Herzl Havakuk  
Date: 28<sup>th</sup> October 2011  
Report Prepared by: Glen Harding Tech Cert (Arbor.A)  
Date of Inspection: Thursday 20<sup>th</sup> October 2011

*Please note that abbreviations introduced in [Square brackets] may be used throughout the report.*

## **Instructions**

**Issued by – Mr. Herzl Havakuk**

**TERMS OF REFERENCE – To produce a planting scheme and maintenance schedule for the approved development at 2 Quickswood which plans for the future of the site in a sustainable manner.**

The writer retains the copyright of this report and its content is for the sole use of the client(s) named above. Copying of this document may only be undertaken in connection with the above instruction. Reproduction of the whole, or any part of the document without written consent from GHA Trees is forbidden.

## **Planting Specification & Aftercare Management Plan for: 2 Quickwood, London, NW3 3SJ**

### **1.Introduction**

GHA Trees have been asked to produce a planting specification and aftercare management plan for the above site, by Mr. Herzl Havakuk, the current owner of the site.

### **2.The Site**

The plan is to construct a basement beneath the existing building; this proposal has recently gained planning consent from the local planning authority.

### **3.The Soil**

The soil on site is a predominantly a clay soil; this must be considered when choosing tree / shrub species for planting to ensure their healthy establishment. The new planter (see section 5 and appended plan) will however be filled with good quality topsoil to ensure the establishment of any new trees, so it can be assumed that the soil will be of good quality.

### **4.Current Tree Cover**

No vegetation is currently growing within the site; however some plant pots are present.

### **5.Proposed New Planting Areas**

There is scope for new planting within the raised planter which will be constructed to the South of the site; the site owners wish to have a green screen in this area to obscure their vision of the existing boundary fence. The planting will include an informal tree line / hedge along the southern boundary; a map of the proposed locations can be viewed at Appendix 1. A table of trees is outlined below which includes species and approximate numbers.

<b>Species</b>	<b>Code on plan</b>	<b>Quantity</b>
<i>Ilex aquifolium</i> (Holly)	IA	10

### **6.Tree Stock & Nursery Specification**

- i. The new trees will be feathered heavy standards of a minimum: 10 - 12 cm girth. These specimens must be as those classified in section 7.1 and 7.4 of BS 3936 – Nursery Stock Part 1: Specification for Trees and Shrubs (see appendix 2).
- ii. A suitably qualified and experienced Arboriculturalist should select all trees and shrubs from a reputable Nursery / Tree supplier.

### **7.Timing of Planting**

Tree planting should be undertaken in the appropriate planting season between 1<sup>st</sup> November and 31<sup>st</sup> March.

## **8.Planting & Young Tree Protection**

- i. A representative from GHA Trees should meet with the tree-planting contractors on site to explain the scope of the planting scheme and ensure all work is done in line with industry best practice.
- ii. All trees are to be planted by suitably experienced persons using appropriate planting equipment and techniques.
- iii. Trees should be planted no deeper than the nursery mark and 'soil firmed' to ensure satisfactory interaction between the roots and the soil.
- iv. All tree roots are to covered and protected until such time that they are to be planted.
- v. All trees will be supported using two support stakes and rubber tie for the first 3 – 5 growing seasons.

## **9.Aftercare & Watering**

- i. The new specimens that are to be planted will require watering during dry periods. This should be done either early in the morning or late evening to allow the trees to gain full benefit. The timing and frequency of such watering will be dependent on climatic variations.
- ii. The scheme will include the installation of a 'leaky pipe' surrounding each tree which will be connected to a mains water supply, and water will then be regulated using a timer. During periods of heavy rainfall, the timer can be switched off as needed. The clients engineer is designing the raised planter in such a way that drainage will be good, and there will be no risk of soil waterlogging.
- iii. A 75mm deep layer of mulch is to be spread over a 1 meter square diameter around the trees. This will be maintained as such throughout the first three growing seasons.
- iv. The soil surrounding the new trees will be kept free from weed and grass competition, with elimination of all weeds within a 0.5m radius of the main stems for the first three growing seasons.
- v. All stakes are to be monitored and adjusted to allow the tree to grow freely. Stakes will only be removed when the trees no longer require them and having become sufficiently established.
- vi. If any plants fail within five years of planting they will be replaced in accordance with Section 6,7 & 8 of this document and to the satisfaction of the Local Planning Authority

## **10. Pruning Requirements for new Trees / Hedges**

- i. The new trees will be allowed to grow to 3metres in height and then pruned annually to maintain them at this size.
- ii. Any formative pruning will take place after three to five years of planting. Formative pruning will be undertaken in accordance with section 7.4 of BS3998:2010 Tree Work – Recommendations.

## **11. Conclusion**

- i. The new trees / hedging plants will improve the visual appearance of the site, and help the site to integrate with the adjoining properties.
- ii. All trees have been chosen to exist in harmony with the built structures.
- iii. Whilst GHA Trees has chosen trees suitable for growth at such a location, it cannot be guaranteed that all trees will establish successfully.

## **Appendix 1**

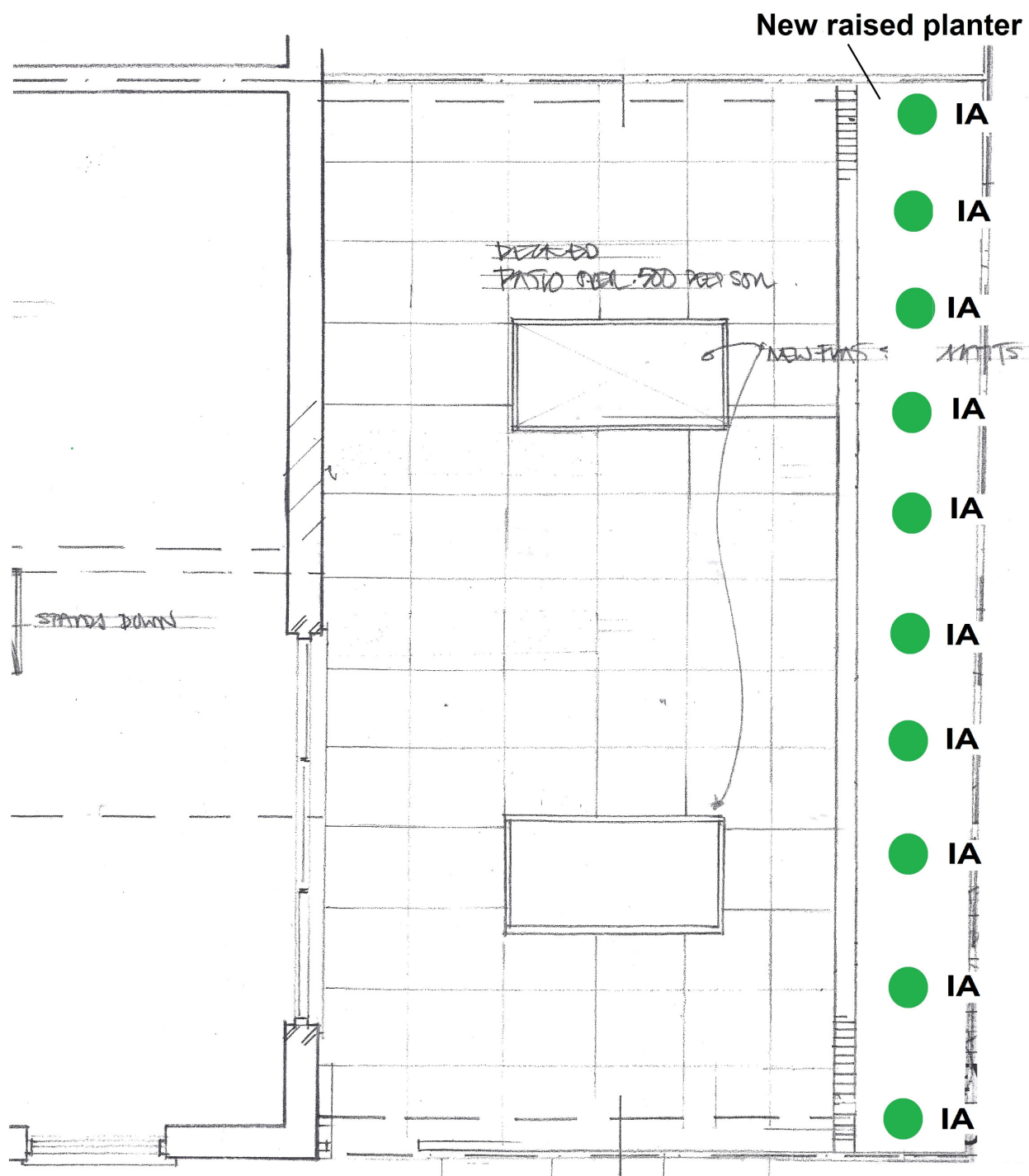

Ref: GHA/PS/69:11

Planting scheme in relation  
to: 2 Quickwood, London,  
NW3 3SJ

Edited: October 2011

## **Appendix 2**



Table 1. Dimensions of trees

Form	Girth (stem circumference) 1 m from ground	Overall height from the ground (other than top worked weeping standards)	Clear stem height from ground to lowest branch	Container size (if used)
Seedlings, cuttings and transplants	cm	cm 10 to 15 15 to 20 20 to 25 25 to 30 30 to 40 40 to 50 50 to 60 60 to 80 80 to 100 100 to 125 or any combinations of above according to species and age	cm — — — — — — — — —	L
Whips	— — — — —	100 to 125 125 to 150 150 to 175 175 to 200 over 200	— — — — —	
Feathered trees	— — — — 6 to 8 8 to 10 10 to 12	125 to 150 150 to 175 175 to 200 200 to 250 250 to 300 250 to 300 over 300	— — — — — — —	— — 10 10 15 15 15
Standard trees:				
Half	4 to 6	175 to 250	125 to 150	10
Extra light	4 to 6	200 to 250	150 to 175	15
Light	6 to 8	250 to 300	150 to 175	15
Standard	8 to 10	250 to 300	175 to 200	15
Selected	10 to 12	300 to 350	175 to 200	25
Heavy	12 to 14	350 min.	175 to 200	35
Extra heavy	14 to 16	350 min.	175 to 200	35

NOTE 1. The criteria normally used for tendering and ordering are:

for seedlings and transplants: age, treatment (see notes to 7.7) and overall height

for whips: overall height

for feathered trees: overall height

for standard trees: girth (stem circumference)

NOTE 2. The information given in this table differs from that given in BS 3936 : Parts 4 and 5.

## 6 Labelling and additional information

### 6.1 General

Each plant or group of plants of a single species or cultivar shall be legibly labelled or otherwise identified.

### 6.2 Information required

**6.2.1** The following information shall be stated on the label.

- (a) The name(s) of the plants.

NOTE. The name of a plant should be the botanical name, i.e. genus and species with variety or cultivar if appropriate. The common name may be given if there is no uncertainty.

- (b) The name of the supplier, unless the plants are sold expressly for resale.

**6.2.2** The following information shall also be provided.

- (a) The size of the plants and/or the size of container (except for retail sale) (see table 1 and appendix A).
- (b) The age, in years, and root system of seedlings/cuttings and transplants indicated as in note 2 to 7.7.
- (c) If the plants are containerized.
- (d) The number of this British Standard, i.e. BS 3936 : Part 1 : 1992<sup>1)</sup>.
- (e) A statement as to whether or not the country of origin is the UK.

**6.2.3** The supplier shall give the following information on request.

NOTE. This information may be included on the label or other means of identification

- (a) The country of origin.
- (b) The method of propagation, e.g. from cuttings, from seeds, by micropropagation, by grafting budding.
- (c) The name or designation of the rootstock of budded or grafted plants.
- (d) The type of container, e.g. polybag, rigid plastic, round or square shaped.

## 7 Forms of trees

NOTE. See figure 1 for outline diagrams of examples and table 1 for dimensions.

### 7.1 Standards

**7.1.1** Standards shall have clear, substantially straight stems. Grafted and budded trees shall have no more than a slight bend at the union.

**7.1.2** The head shall be developed for its type and evenly balanced, with no main branch crossing the crown. Standards shall have a central leader or a branch head according to species or cultivar.

**7.1.3** Standards shall be designated as half, extra light, light, standard, selected, heavy or extra heavy. The associated dimensions shall be as stated in table 1.

### 7.2 Feathered trees

**7.2.1** A feathered tree shall have a defined, upright central leader and a stem furnished with evenly spread and balanced lateral shoots down to near ground level, according to its species.

**7.2.2** Feathered trees shall be designated according to the dimensions in table 1.

NOTE. The description feathered standard is considered to be a contradiction in terms and its use is deprecated.

### 7.3 Whips

**7.3.1** A whip shall be without significant feather growth, as determined by visual inspection.

**7.3.2** Whips shall be supplied in the dimensions given in table 1.

### 7.4 Multistem trees

A multistem tree shall have two or more main stems originating at or near (above or below) ground level from one root system. If two or more root systems are grown together to form a multistem tree, this shall be indicated.

### 7.5 Seedlings

The age of seedlings (plants grown from seed and not transplanted) shall be specified when offered for sale and shall be expressed in accordance with note 2 to 7.7.

### 7.6 Cuttings

The age of cuttings (plants grown from shoots, stems or roots of a mother plant) shall be specified when offered for sale and shall be expressed in accordance with note 2 to 7.7.

### 7.7 Transplants and undercut seedlings/cuttings

The height of transplants (seedlings or cuttings that have been transplanted at least once) shall be stated (in cm). The number of growing seasons before and after transplanting or undercutting shall be expressed as shown in note 2. If the seedling/cutting has been undercut, it shall be described as an undercut seedling/cutting. (See also clause 6.)

NOTE 1. Undercutting is the severing of main roots of seedlings/cuttings in their seed or cutting bed at a suitable depth below the soil surface, thereby encouraging a fibrous root system without transplanting. Undercutting should be timed to allow root growth to take place prior to supply.

<sup>1)</sup> Marking BS 3936 : Part 1 : 1992 on or in relation to a product represents a manufacturer's declaration of conformity, i.e. a claim by or on behalf of the manufacturer that the product meets the requirements of the standard. The accuracy of the claim is therefore solely the responsibility of the person making the claim. Such a declaration is not to be confused with third party certification of conformity, which may also be desirable.

