

Replaced 1928 Extension

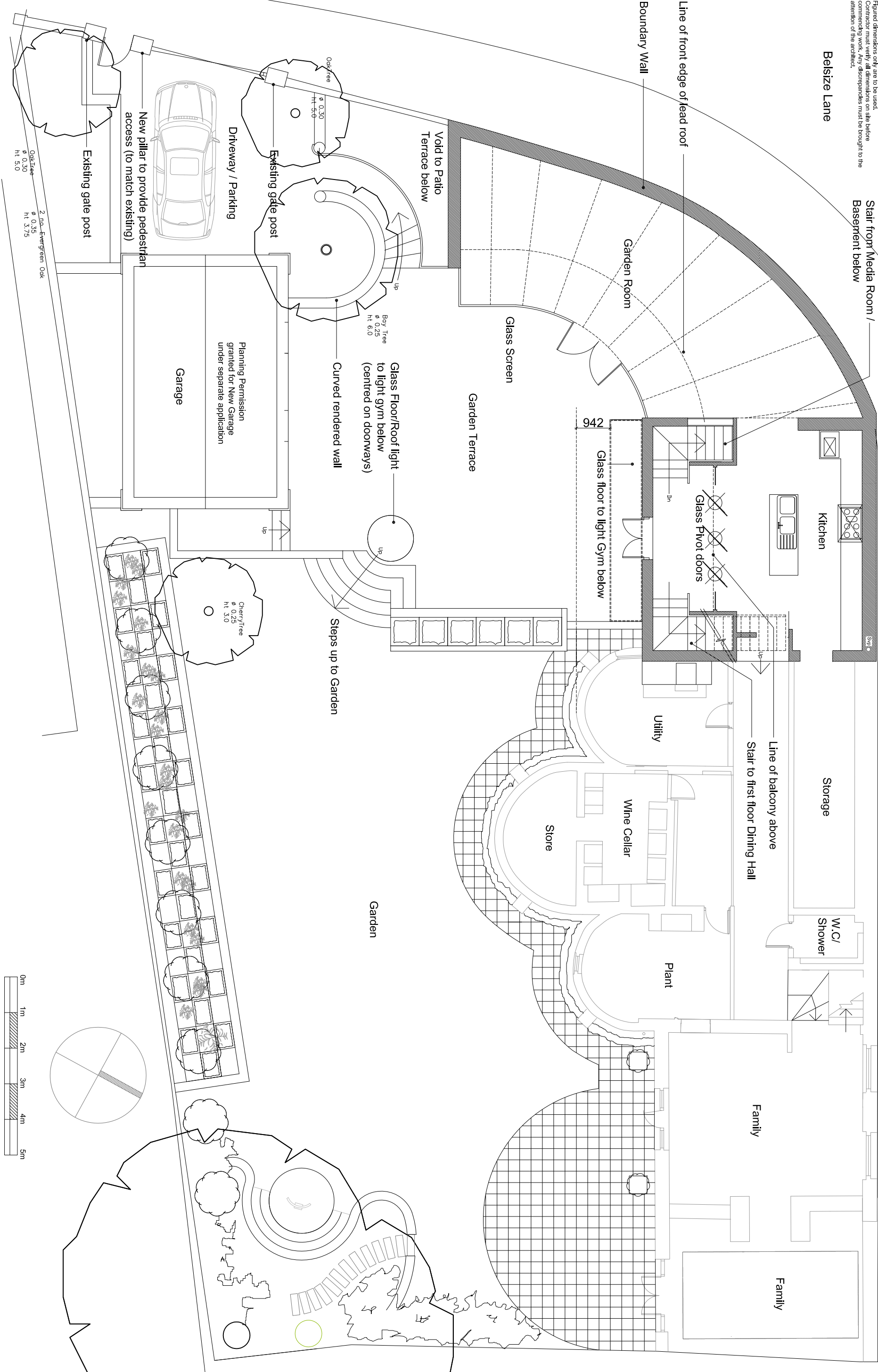

Hunters Lodge, Belsize Lane, London

Drawing: Lower Ground/Garden Floor Plan (Proposed)
Scale: 1:100@A3, 1:50@A1
Status: Planning
Date: December 2011
Ref: 1007 - 101

Clear Future : Architecture
Colebank Mews, 152 Westbury Road,
Westbury on Trym, Bristol, BS9 3AL
Telephone: +44 (0)117 962 1432
Mobile: +44 (0)7973264343
E-Mail: mark.watkins@cf-architecture.co.uk