

	+ 74.00
3125	ROOF LEVEL
2925	LEVEL 14 + 70.500
2925	LEVEL 13 + 67.575
2925	LEVEL 12 + 64.650
2925	LEVEL 11 + 61.725



PROPOSED MATERIALS KEY

- ① Facing brick
- ② Glazed red brick
- ③ Pre-cast concrete spandrels with a Portland stone colour and smooth finish.
- ④ Aluminium framed double glazed windows and doors.
- ⑤ Aluminium framed double glazed shopfronts.
- ⑥ Polyester Powder Coated aluminium balustrades.
- ⑦ Polyester Powder Coated aluminium Juliette balcony.
- ⑧ Polyester Powder Coated aluminium louvres.
- ⑨ Polyester Powder Coated aluminium spandrel with integral ventilation grille.

notes

- The contractor is responsible for checking dimensions, tolerances and references. Any discrepancy to be verified with the Architect before proceeding with the work.
- Where an item is covered by drawings to different scales the larger scale drawing is to be worked to.
- Do not scale drawing. Figured dimensions to be worked to in all cases.

CDM Regulations 2007

ALL current drawings and specifications for the project must be read in conjunction with the Designer's Hazard and Environmental Assessment Report.

Key plan

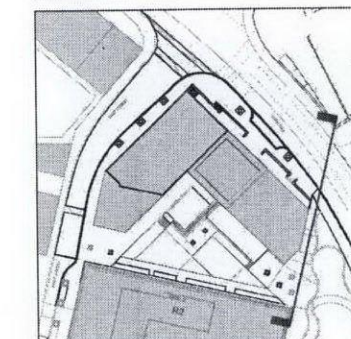
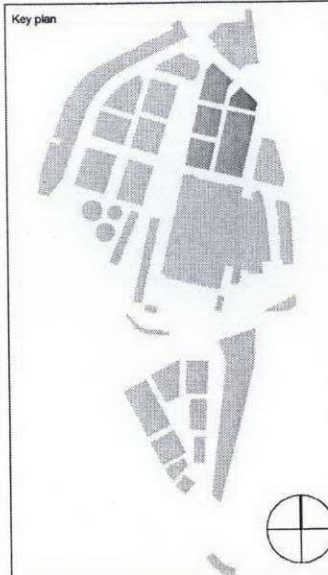

08-11-11	C	Shopfronts & South east balcony updated
14-04-11	B	Minor amendments as indicated on drawing
29-09-10	A	Minor amendments as indicated on drawing

date	rev	revision/author/checker
------	-----	-------------------------

purpose of issue
FOR APPROVAL

project
**KINGS CROSS CENTRAL
BLOCK R4**

drawing
EAST ELEVATION

drawing no
A6308-2.3-205

drawn KL checked JP

scale @ A3 1:250 date Apr 2011

PRP Architects ©
10 Lindsey Street
London
EC1A 9EP
T +44 (0)20 7633 1200
F +44 (0)20 7633 1201
lon.prp@prparchitects.co.uk

