



PROPOSED MATERIALS KEY

- 1 Facing brick
- 2 Glazed red terracotta facade panel.
- 3 Pre-cast concrete spandrels with a Portland stone colour and smooth finish
- 4 Aluminium framed double glazed windows and doors.
- 5 Aluminium framed double glazed shopfronts.
- 6 Polyester Powder Coated aluminium balustrades.
- 7 Polyester Powder Coated aluminium Juliette balcony.
- 8 Polyester Powder Coated aluminium louvres.
- 9 Polyester Powder Coated aluminium spandrel with integral ventilation grille

notes

- The contractor is responsible for checking dimensions, tolerances and references. Any discrepancy to be verified with the Architect before proceeding with the works.
- Where an item is covered by drawings to different scales the larger scale drawing is to be worked to.
- Do not scale drawing. Figured dimensions to be worked to in all cases.

CDM Regulations 2007

All current drawings and specifications for the project must be read in conjunction with the Designer's Hazard and Environmental Assessment, if issued.

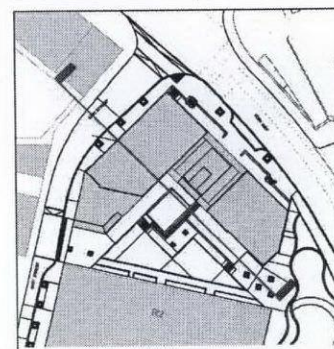
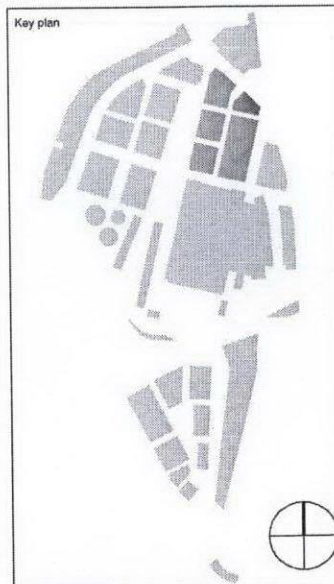

29-09-10 A Minor amendments as indicated on drawing

date	rev	revision/author/checker
------	-----	-------------------------

purpose of issue
FOR APPROVAL

project
**KINGS CROSS CENTRAL
BLOCK R4**

drawing
SOUTH WEST ELEVATION

drawing no A6308-2.3-204	rev A
drawn KL	checked JP
scale @ A3 1:250	date Sept 2010