

PROPOSED MATERIALS KEY

- ① Facing brick
- ② Glazed red brick
- ③ Pre-cast concrete spandrels with a Portland stone colour and smooth finish.
- ④ Aluminium framed double glazed windows and doors.
- ⑤ Aluminium framed double glazed shopfronts.
- ⑥ Polyester Powder Coated aluminium balustrades.
- ⑦ Polyester Powder Coated aluminium Juliette balcony.
- ⑧ Polyester Powder Coated aluminium louvres.
- ⑨ Polyester Powder Coated aluminium spandrel with integral ventilation grille.

notes

- The contractor is responsible for checking dimensions, tolerances and references. Any discrepancy to be verified with the Architect before proceeding with the work.
- Where a plan is covered by drawings to different scales the larger scale drawing is to be worked to.
- Do not scale drawing. Figured dimensions to be worked to in all cases.

CDM Regulations 2007

ALL current drawings and specifications for the project must be read in conjunction with the Designer's Hazard and Environmental Assessment Report.

Key plan

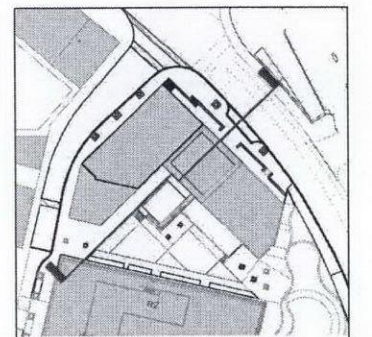
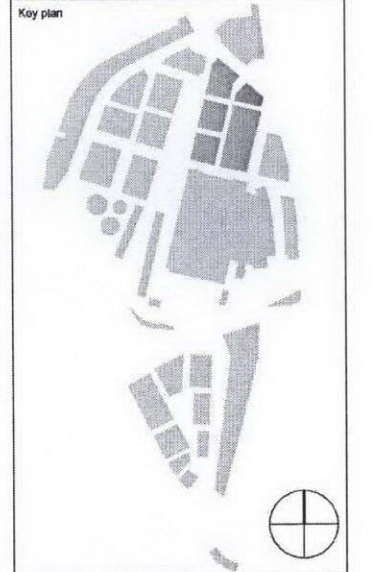

08-11-11 D Parapet updated
14-04-11 C Minor amendments
14-02-11 B Minor amendments as indicated on drawing
29-09-11 A Minor amendments as indicated on drawing

date	rev	revision/author/checker
purpose of issue		
FOR APPROVAL		
project		
KINGS CROSS CENTRAL BLOCK R4		
drawing		
SOUTH EAST ELEVATION		

purpose of issue
FOR APPROVAL

project
KINGS CROSS CENTRAL
BLOCK R4

drawing
SOUTH EAST ELEVATION

drawing no	rev
A6308-2.3-203	D

drawn	KL	checked	JP
scale @ A3	1:250	date	Apr 2011

PRP Architects ©
10 Lindsey Street
London
EC1A 9HP
T +44 (0)20 7653 1200
F +44 (0)20 7653 1201
lon.prp@prparchitects.co.uk

