

DO NOT SCALE THIS DRAWING
CONTRACTORS ARE TO CHECK ALL DIMENSIONS PRIOR TO COMMENCEMENT ON SITE AND NOTIFY THE ARCHITECT OF ANY ERRORS, OMISSIONS, OR DISCREPANCIES.
TATE & HINDLE DESIGN LIMITED RETAIN COPYRIGHT OF THIS DRAWING. IT MAY NOT BE COPIED, ALTERED OR REPRODUCED IN ANY WAY WITHOUT THEIR WRITTEN AUTHORITY.

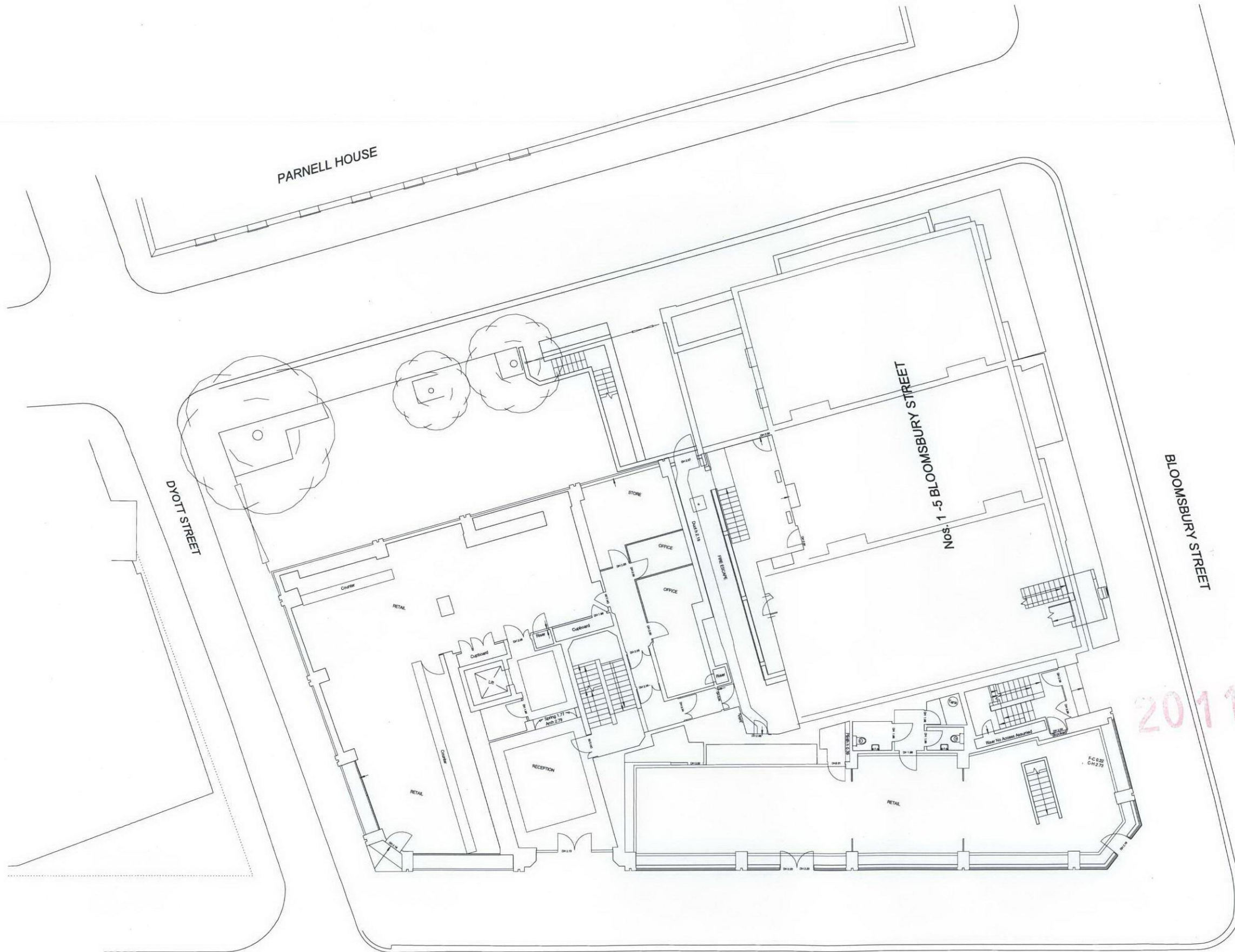

2011/ 5823/P COPY

NEW OXFORD STREET



rev	description	date	checked
	FOR INFORMATION		
client	ARTILLERY PROPERTIES Ltd		
project	ISIS HOUSE 64-76 New Oxford Street		

drawing
EXISTING
GROUND FLOOR PLAN

scale	drawn	checked	date
1:100@A1 1:200@A3	DS	X	24-05-11
project no.	drawing	revision	
10730	P-EX(03)010	00	

TATE HINDLE
ARCHITECTURE + DESIGN

1 Lindsey Street, Smithfield, London EC1A 9HP T 020 7332 4850
mail@tatehindle.co.uk www.tatehindle.co.uk F 020 7332 4888
© Tate and Hindle Design Limited