

existing panelling brought forward 50mm to accommodate flow / return AC pipes

AC unit within new cupboard

u/s 1.12

u/s 2.80

**PROPOSED
GROUND FLOOR REAR RECEPTION
PART PLAN OF WEST WALL**
scale 1:20

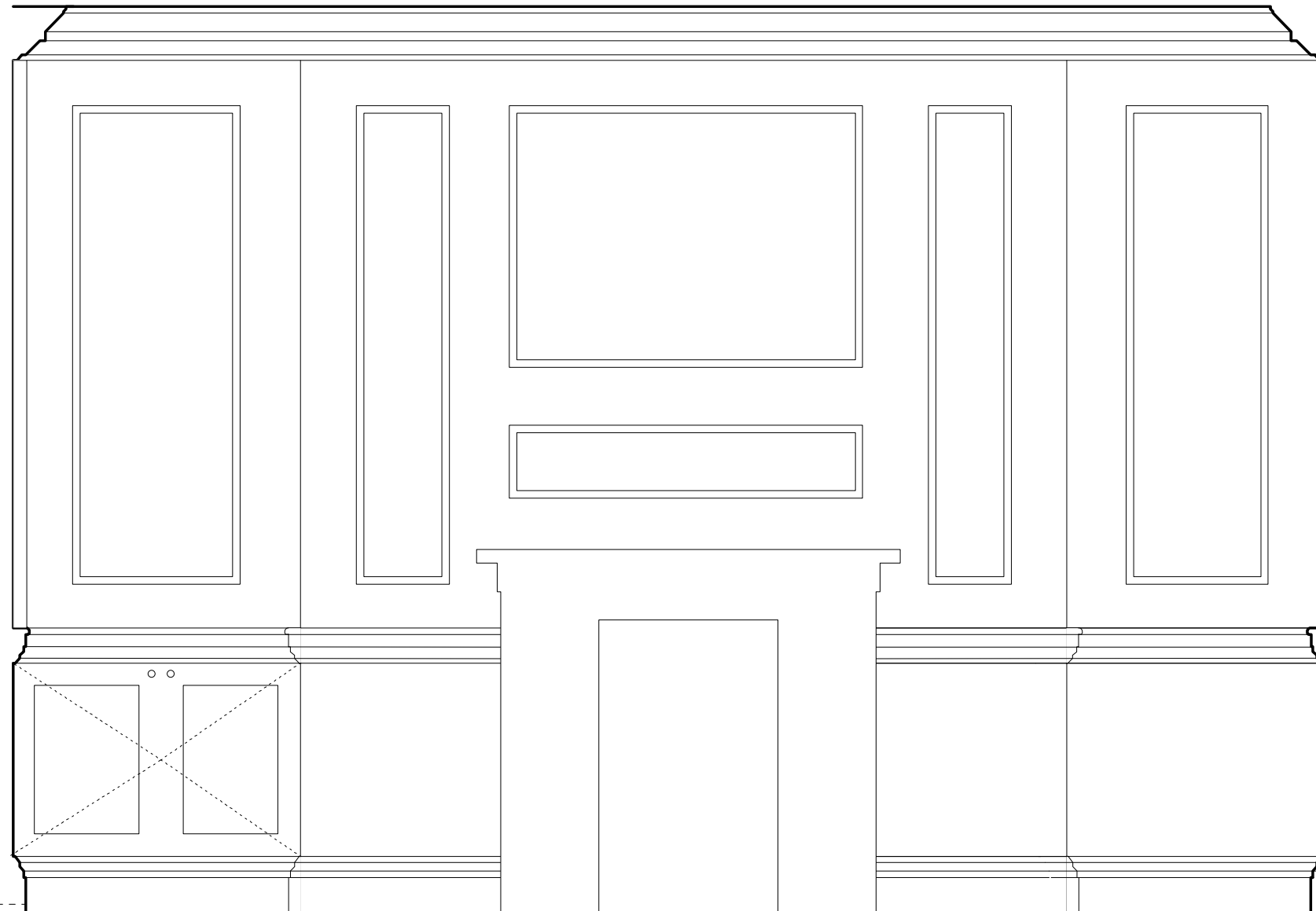

**PROPOSED
GROUND FLOOR REAR RECEPTION
ELEVATION OF WEST WALL**

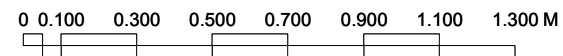

**DO NOT SCALE THIS DRAWING.
CHECK ALL DIMENSIONS ON SITE**

THIS DRAWING IS ISSUED TO ESTABLISH THE FEASIBILITY OF THE PROPOSED WORKS AND IS BASED ON UNCORRECTED SURVEY INFORMATION PROVIDED BY OTHERS. THE DRAWINGS ARE NOT TO BE USED AND ALL WORKS OR DIMENSIONS ARE TO BE REPORTED TO THE ARCHITECT. FORD ARCHITECTURE DOES NOT ACCEPT ANY LIABILITY FOR THE CONSEQUENCES OF ACTION BASED ON THE INFORMATION PROVIDED.
ALL PROPOSALS SHOWN ARE SUBJECT TO PLANNING AND A DETAILED STRUCTURAL SURVEY.

no.	date	revised notes

**FORD
ARCHITECTURE**
HUDDLESTONE CLOSE
LYE LANE CLEEVE HILL
CHELTENHAM GL52 3DD
T: +44(0)1242 673103
E: INFO@FORDARCH.CO.UK

CLIENT: MR K V TULSIANI
PROJECT: 6 LINCOLN'S-INN-FIELDS
CAMDEN, LONDON
DRAWING TITLE: PROPOSED WEST P WALL
SCALE: 1:20
DATE: 9/2011
PAPER: A3
PROJECT NO: GROUND REAR RECEPTION
DRAWING NUMBER: P814_03/649A