

Notes
 1. This drawing is the property of Fabrik Ltd. It must not be copied or reproduced without written consent.
 2. Only figured dimensions are to be taken from this drawing. All contractors must visit site and be responsible for laying and checking all dimensions related to the works shown on the drawing.

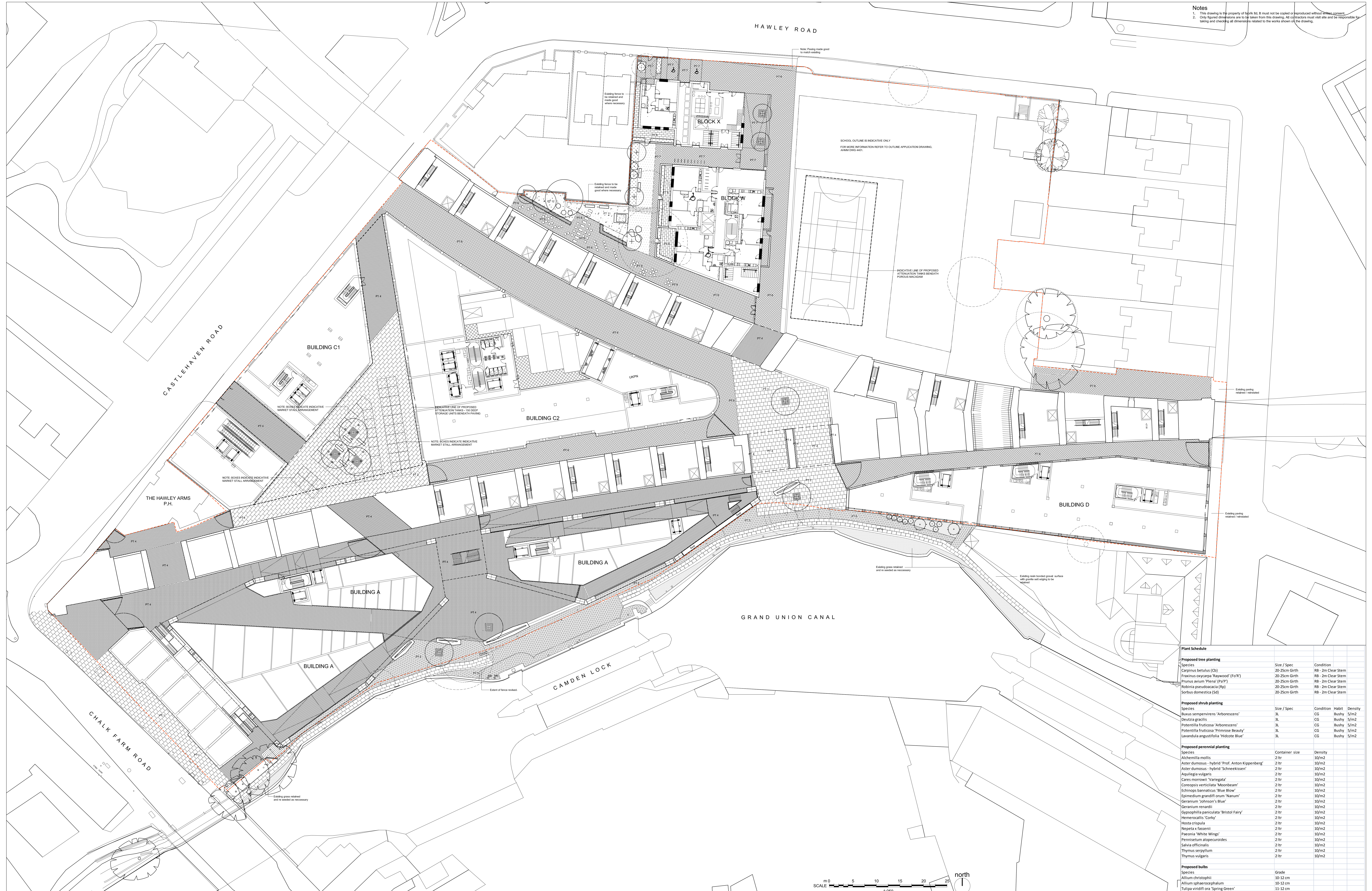

Plant Schedule

Species	Size / Spec	Condition	Habit	Density
Proposed tree planting				
Carpinus betulus (Cb)	20-25cm Girth	RB - 2m Clear Stem		
Fraxinus oxycarpa 'Raywood' (F'R)	20-25cm Girth	RB - 2m Clear Stem		
Prunus avium 'Pienza' (Pa/P)	20-25cm Girth	RB - 2m Clear Stem		
Rubus plicatifolius (Rp)	20-25cm Girth	RB - 2m Clear Stem		
Sorbus domestica (Sd)	20-25cm Girth	RB - 2m Clear Stem		
Proposed shrub planting				
Buxus sempervirens 'Arborescens'	3L	CG	Bushy	5/m2
Deutzia gracilis	3L	CG	Bushy	5/m2
Potentilla fruticosa 'Arborescens'	3L	CG	Bushy	5/m2
Potentilla fruticosa 'Primrose Beauty'	3L	CG	Bushy	5/m2
Lavandula angustifolia 'Hidcote Blue'	3L	CG	Bushy	5/m2
Proposed perennial planting				
Species	Container size	Density		
Alchemilla mollis	2 tr	10/m2		
Aster dumosus - hybrid 'Prof. Anton Kipperberg'	2 tr	10/m2		
Aster dumosus - hybrid 'Schneekissen'	2 tr	10/m2		
Aquilegia vulgaris	2 tr	10/m2		
Carex morrowii 'Variegata'	2 tr	10/m2		
Coneopsis verticillata 'Moonbeam'	2 tr	10/m2		
Echinops bannaticus 'Blue Blow'	2 tr	10/m2		
Epimedium grandiflorum 'Nanum'	2 tr	10/m2		
Geranium 'Johnson's Blue'	2 tr	10/m2		
Geranium rostratum	2 tr	10/m2		
Gypsophila paniculata 'Bristol Fairy'	2 tr	10/m2		
Hemerocallis 'Corky'	2 tr	10/m2		
Hosta crispula	2 tr	10/m2		
Nepeeta x fassenii	2 tr	10/m2		
Paeonia 'White Wings'	2 tr	10/m2		
Penstemon alpestris	2 tr	10/m2		
Salvia officinalis	2 tr	10/m2		
Thymus serpyllum	2 tr	10/m2		
Thymus vulgaris	2 tr	10/m2		
Proposed bulbs				
Species	Grade			
Allium christophii	10-12 cm			
Allium sphaerocephalum	10-12 cm			
Tulipa viridiflora 'Spring Green'	11-12 cm			
Crocus tommasinianus	5-6 cm			

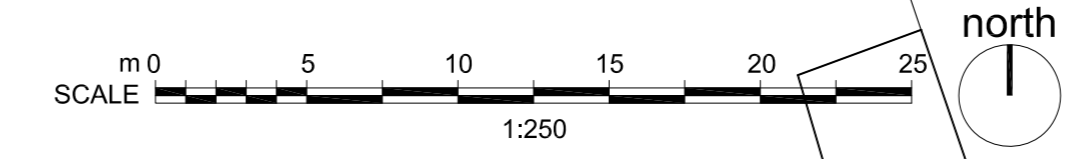

fabrik
 First Floor
 4-6 Emerson Street
 LONDON
 SE1 1DU
 T: 0207 633 1483
 F: 0207 261 9126
 E: london@fabrik.com
 W: www.fabrik.com

Legend

- Planting: Planting Type 1 (Various tree symbols), Planting Type 2 (Various shrub symbols), Planting Type 3 (Various perennial symbols), Planting Type 4 (Various bulb symbols), Planting Type 5 (Various tree symbols), Planting Type 6 (Various shrub symbols), Planting Type 7 (Various perennial symbols), Planting Type 8 (Various bulb symbols), Planting Type 9 (Various tree symbols), Planting Type 10 (Various shrub symbols), Planting Type 11 (Various perennial symbols), Planting Type 12 (Various bulb symbols).
- Structural: Existing fence to be retained and made good where necessary, Existing fence to be removed and made good where necessary, Existing fence to be retained and made good where necessary, Existing fence to be removed and made good where necessary, Existing fence to be retained and made good where necessary, Existing fence to be removed and made good where necessary.
- Other: Existing trees to be retained, Existing trees to be removed, Existing trees to be retained, Existing trees to be removed, Existing trees to be retained, Existing trees to be removed.

Project: Camden Lock Village, Camden
 Drawing: Ground Floor Hard and Soft Landscape General Arrangement
 Date: 16.12.11
 Scale: 1:250
 Drawing No: D1807 L.210
 Date: September '11
 Revision: A
 Issued for Design Information
 Issued for Planning Approval
 Issued for Construction
 Issued for Tender
 As Built
 Drawing sheet size - A0
 Copyright Reserved