



62 BELLAMY DRIVE
STANMORE
MIDDLESEX
HA7 2DA
TEL:0208 907 3590
FAX:0208 907 7332
www.homesdesignltd.co.uk

title		PROPOSED FLOOR'S SECTION FOR SOUND PROOFING		
project		17-21 & 23-27 HATTON WALL - LONDON EC1N 8JE		
drawing no		HD517/2008	rev:	scale N.T.S
drawn by		R. L	contract no.	HD517
			date	01/2012

**SOUND INSULATION SPECIFICATION TO BUILDING
REGULATION PART-E:**

INTERNAL PARTITION WALLS BETWEEN ROOMS TO BE INSULATED INNER STUD LINING:100x50-C16 @ 600c/cs WITH NOGGIN'S @ 450c/c VERT PLUS INFILL INSULATION (50mm ROCKWOOL DRYTHERM-50 POSITIONED CENTRALLY TO THE JOIST TO ACHIEVE 25mm CAVITY GAP TO EACH SIDE) WITH 2x12.5mm PLASTER BOARD TO INSIDE FACE (1-SOUND BOARD + 1-FIRE BOARD) & FULLY SKIMMED IN ORDER TO PROVIDE SOUND INSULATION BETWEEN EACH ROOMS TO PART-E COMPLIANCE (48db @ MIN 3db ABOVE MIN. REQUIREMENTS)

EXISTING GROUND FLOOR CEILING JOISTS TO BE RETAINED & ANY DEFECTED MEMBERS TO BE REPLACED WITH 225x50-C16 JOISTS. PROVIDE 200mm ROCKWOOL-50kg/m³ INSULATION BETWEEN THE JOISTS WITH 25mm GAP TO U/S OF THE 1st FLOOR DECKING TO CREATE A CAVITY GAP. FIXING 25mm METAL INSERT TO U/S OF THE JOISTS THEN INSTALL 12.5mm SOUND BOARD PLUS 12.5mm FIRE BOARD TO THE CEILING. PROVIDE FULL DEPTH NOGGINGS AT 3RD SPAN. SAP REPORT TO BE PROVIDED WITHIN FIVE DAYS OF COMPLETION OF THE WORKS & FORWARDED TO BUILDING CONTROL TO COMPLY WITH PART-L. A SOUND TESTING BY INDEPENDENT CERTIFIED COMPANY TO ALL AREAS IN ORDER TO CERTIFY THE BUILDING AND THE DESIGNATED AREAS UNDER BUILDING REGULATION PART-E COMPLIANCE (MIN. 48db @ 3db ABOVE REQUIREMENTS). (Upon completion of the works the sound test to be carried out by accredited and approved independent certified contractor who will forward the test results to Building Control for approval)

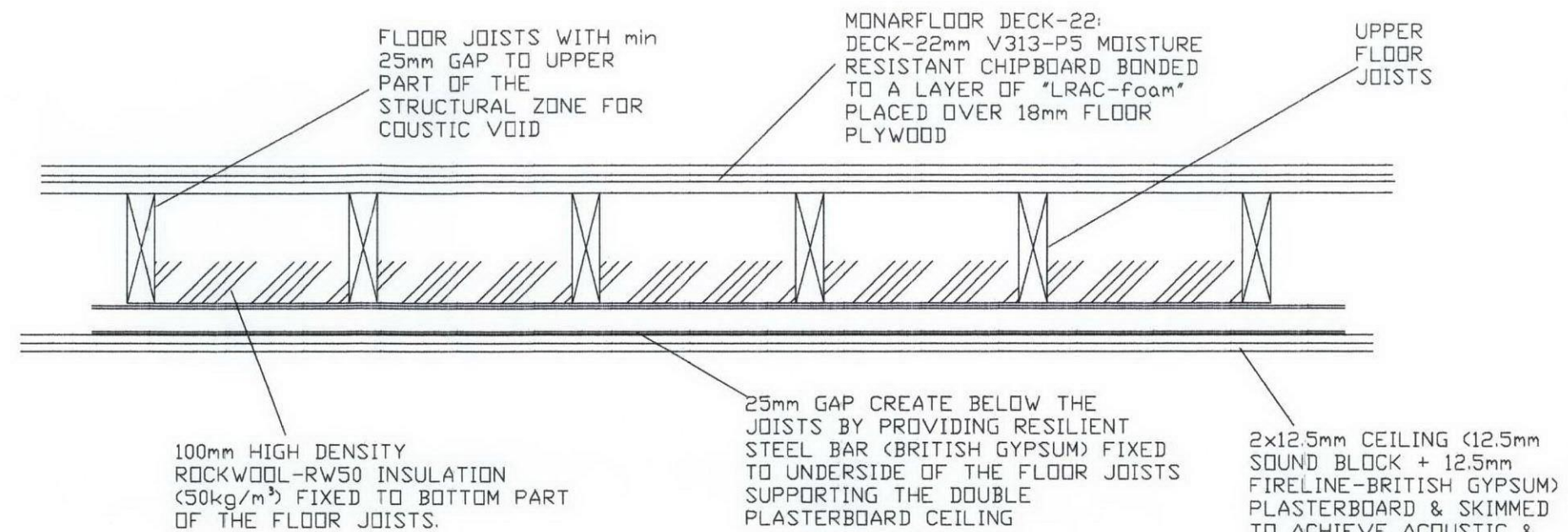

CEILING DETAILS WITH ACOUSTIC
INSULATIONS & SOUND PROOFING

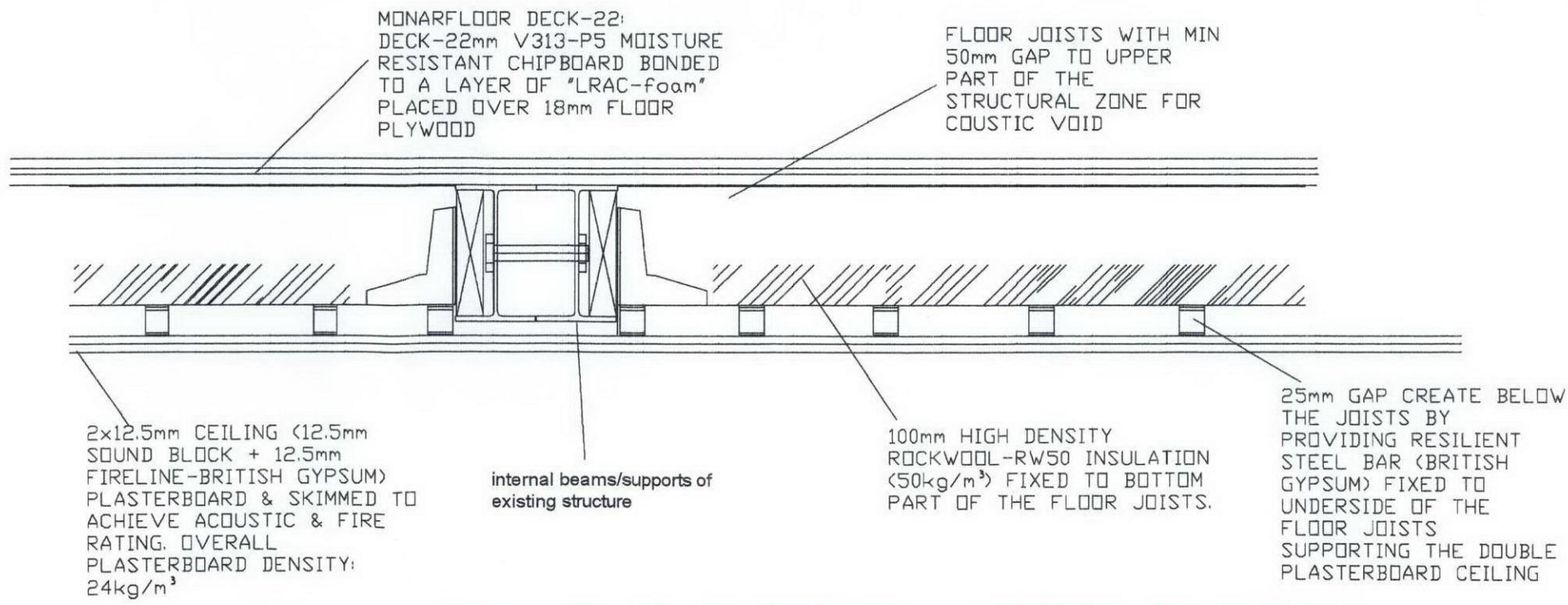

section B-B THROUGH UPPER FLOOR'S
CONSTRUCTION