



62 BELLAMY DRIVE  
STANMORE  
MIDDLESEX  
HA7 2DA  
TEL:0208 907 3590  
FAX:0208 907 7332  
info@homedesignltd.co.uk  
www.homedesignltd.co.uk

title	PROPOSED PLANS (SHEET-2)		
project	17-21 & 23-27 HATTON WALL - LONDON EC1N 8JE		
drawing no	HD517/2001	rev:	
drawn by	R. L	contract no.	HD517
scale	1:100 @ A3	date	01/2012

Symbol	DETAIL
	DOUBLE THERMOSTATIC RADIATORS (MIN. 1200mm LONG - SUBJECT TO PLUMBER'S CONFIRMATION & CLIENT'S SPECIFICATION)
	SMOKE DETECTOR SYSTEM CONNECTED TO INDEPENDENT CIRCUIT & TO BRITISH STANDARDS. THE SMOKE ALARM TO COMMON AREA TO BE LINKED WITH INTERNAL FLAT AREAS
	1/2 HOUR FIRE RATED CEILING MOUNTED FITTING TO CLIENT'S SPECIFICATION. IF USING SPOTLIGHTS THEN FITTINGS MUST BE IN COMPLIANCE WITH CONDENSATION RESISTANT SPECIFICATION (R-80 CEILING (RECESSED) SPOTLIGHT FIRERATED)
	DOUBLE SOCKETS AT 450mm ABOVE THE FLOOR LEVEL. ALL FIXTURES TO CLIENT SPECIFICATIONS. THE DOUBLE SOCKETS TO KITCHEN WORKTOP AT 250mm ABOVE SURFACE FINISH LEVELS
	HEAT DETECTORS TO ALL KITCHEN AREAS & CONNECTED TO SMOKE DETECTOR'S CIRCUIT LINKED TO ALL LEVELS
	emergency light fitting linked with battery backup for power failure in landlord cupboard. fire escape sign within all landing & 1/2 landing levels to underside of emergency light fittings

STAIRCASE REQUIREMENTS:

- (I) ALL RISERS TO BE AT MINIMUM OF 208mm WITH 231mm MINIMUM GOING @ 42° PITCH. HANDRAIL TO BE POSITIONED @ 900mm-MIN ABOVE PITCH LINE & 900mm MIN ON LANDING RETURN. INFILL BALUSTERS @ 100mm MAXIMUM SPACING VERTICALLY. MINIMUM WIDTH OF ANY TAPERED TREAD TO BE 50mm WHERE CONSECUTIVE TAPERED TREADS ARE USED, THEN A UNIFORM GOING TO BE MAINTAINED.
- (II) ALL TO PART OF "K-1" OF THE BUILDING REGULATION. PITCH OF STAIRS NOT EXCEEDING 42° & COMPLY WITH BS-585. MINIMUM HEADROOM TO BE 2000mm MEASURED VERTICALLY ABOVE PITCH. ALL STUD PARTITIONS TO HAVE 12.5mm PLASTER BOARD ON BOTH SIDE WITH 6mm PLASTER FINISH.
- (III) INTERNAL PARTITION WALLS TO BE 100x50 STUD@ 600mm c.cs, NOGGINS & PLATES @ 1200mm c.cs WITH 100x50mm FIRST HEAD/BASE PLATES & DIAGONAL CROSS BRACING. LINED ON OUTSIDE FACE WITH 12.5mm PLASTERBOARD & ON INSIDE WITH 500g POLY VAPOUR BARRIER WITH 100mm FIBREGLASS INSULATION INFILL (ROCKWOOL DRYTHERM-32). PROVIDE STAINLESS STEEL STRAPS TO ROOF/FLOOR CONNECTING TO EXISTING & NEW WALL @ MAX-1500mm c/cs

RESTAURANT & SEATING AREAS

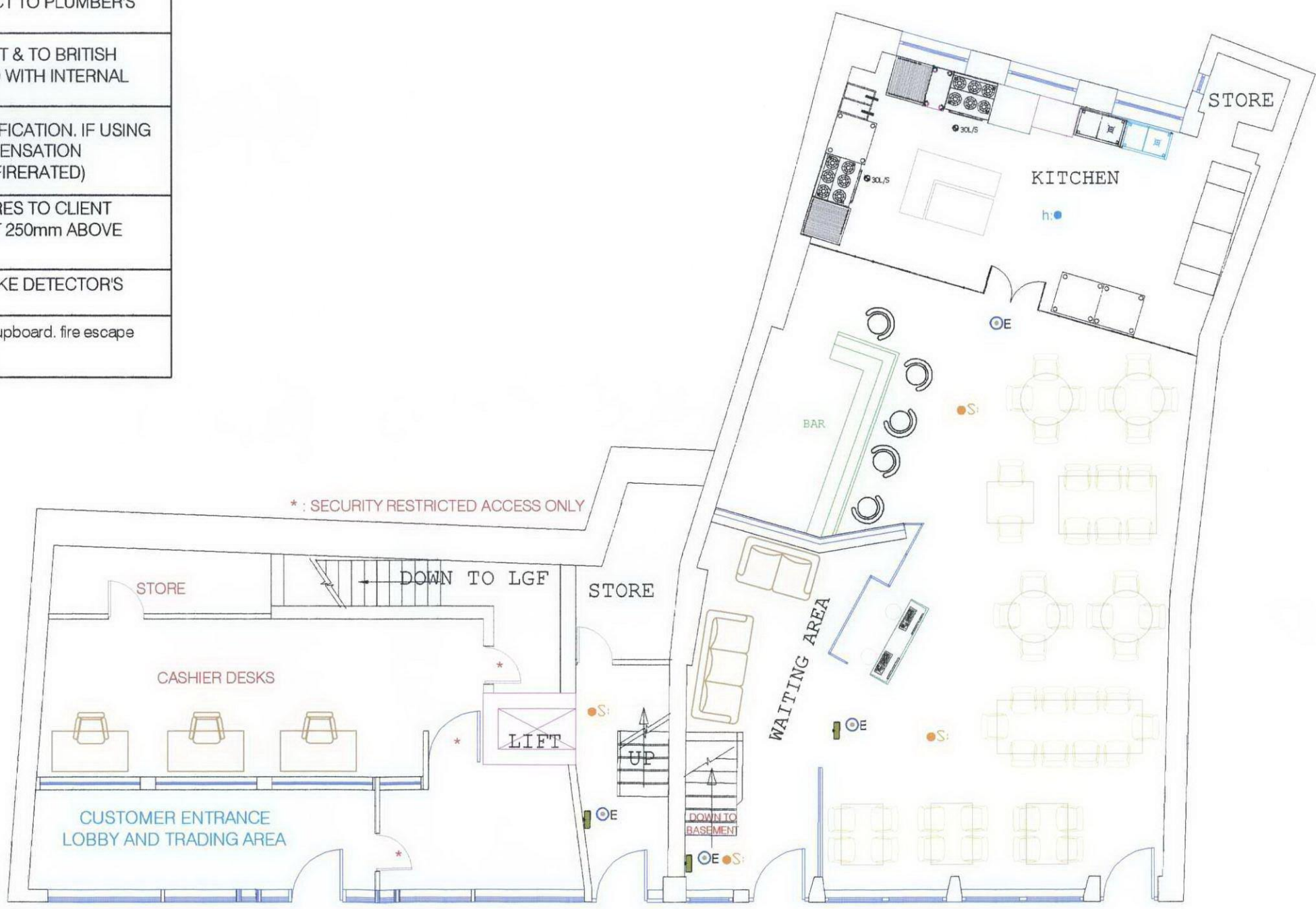

17 TO 21 HATTON WALL

23 TO 27 HATTON WALL

GROUND FLOOR LEVEL