

## PART-B: FIRE REGULATIONS AND MEANS OF OPENINGS

1- ALL LOADBEARING ELEMENTS OF THE STRUCTURE ARE REQUIRED TO HAVE A FIRE RESISTANCE OF AT LEAST 30MINUTES UNDER APPENDIX-A OF APPROVED DOCUMENT-B OF BUILDING GUIDELINES. STEELWORKS TO RECEIVE EITHER 1x15mm LAYER FIRE LINE & SKIMMED OR 2x12.5mm SRAGGEDRED PALSTER BOARD & SKIMMED TO ACHIEVE 30min FIRE RATING.

2- PROVIDE AUTHOMATIC SMOKE DETECTORS ALARM SYSTEM INTERCONNECTED & TO A SEPERATE FUSED CIRCUIT TO BS 5446. THE FIRE & SMOKE DETECTION SYSTEM MUST BE A L1 TYPE SYSTEM BS-5839-PART:1 PROVIDING FULL COVERAGE TO THE UPPER FLOOR AREAS A VENTILATION OPENING EQUAL TO ONE SQUARE METER IS REQUIRED AT THE TOP OF THE STAIRCASE ENCLOSURE.

3- ALL DOORS TO BE FD-30 & PROVIDE 30min FIRE RATING TO BUILDING REGULATION STANDARD WITH MIN. 775mm OPENING & 3 HINGES, EXCEPT ENTRANCE DOORS TO BE 900mm WIDE. ALL ESCAPE DOORS ARE TO BE PROVIDED WITH SIMPLE FASTENINGS THAT CAN BE REALLY OPERATED FROM THE SIDE OF APPROACH WITH OUT THE USE OF A KEY & WITHOUT HAVING TO MANIPULATE FOR MORE THAN ONE MECHANISM.

4- All fire door assemblies to comply with BS8214-1990 with regards to construction, design & installation & shall be proven by test to BS476-Part 22 or expert assessment based upon appropriate & relevant tests. Fire doors identified by suffix "S" should be fitted with an edge seal proven satisfactory when tested in accordance with BS476-Part3. A test documents to be provided before installation of the doors. any alteration in the door set to accommodate modification from the original tested door assembly must be tested or assessed by a qualified assessor & the report submitted with any other rest documents, this includes any changes of ironmonger or brassware. Individual entrance doors to rooms should be provided with a lock whose latch bolt is operated by a handle or knob from either side & whose dead bolt is locked & unlocked by a key from the outside & by manually operated turn handle from the inside.

### FIRE REGULATION NOTES:

1- Bin storages required inside the flats & away from common areas to avoid any fire hazard. Storage to have 20minutes fire door enclosures to compliance with PART-B

2- The entrance doors to all flats to be FD30s and then inside the flat's habitable rooms to have FD30 doors with all doors to be fitted with 3-hinges. The key structural elements and also the main common parts and staircase plus the internal party walls and the separating floors to have 60minutes fire rating. All flats to have independant interlinked smoke detectors.

3- The common stairs to have open able windows of 1M \* 1M dimension as top parts and within the reach from common staircase to compliance with means of escape and ventilation.

4- Emergency lighting provide at every landing and ½ landing levels with 2-fitting at ground floor entrance hall. The emergency light to have battery back up within the Landlord fuse circuit for emergency in case of power failure. The emergency signage (green colour with escape notes/pictures) noted over every landing & ½ landing to underside of all emergency lighting

### All new & existing ceiling beams to be within floor construction to create flushed ceilings

ALL INTERNAL WALLS AREA EFFECTED BY THE WORK TO BE MADE GOOD & NEW AREAS PLASTERED THEN PAINTED WITH 2-COATS OF PRIMER & A FINAL COAT TO CLIENT SPECIFICATIONS.

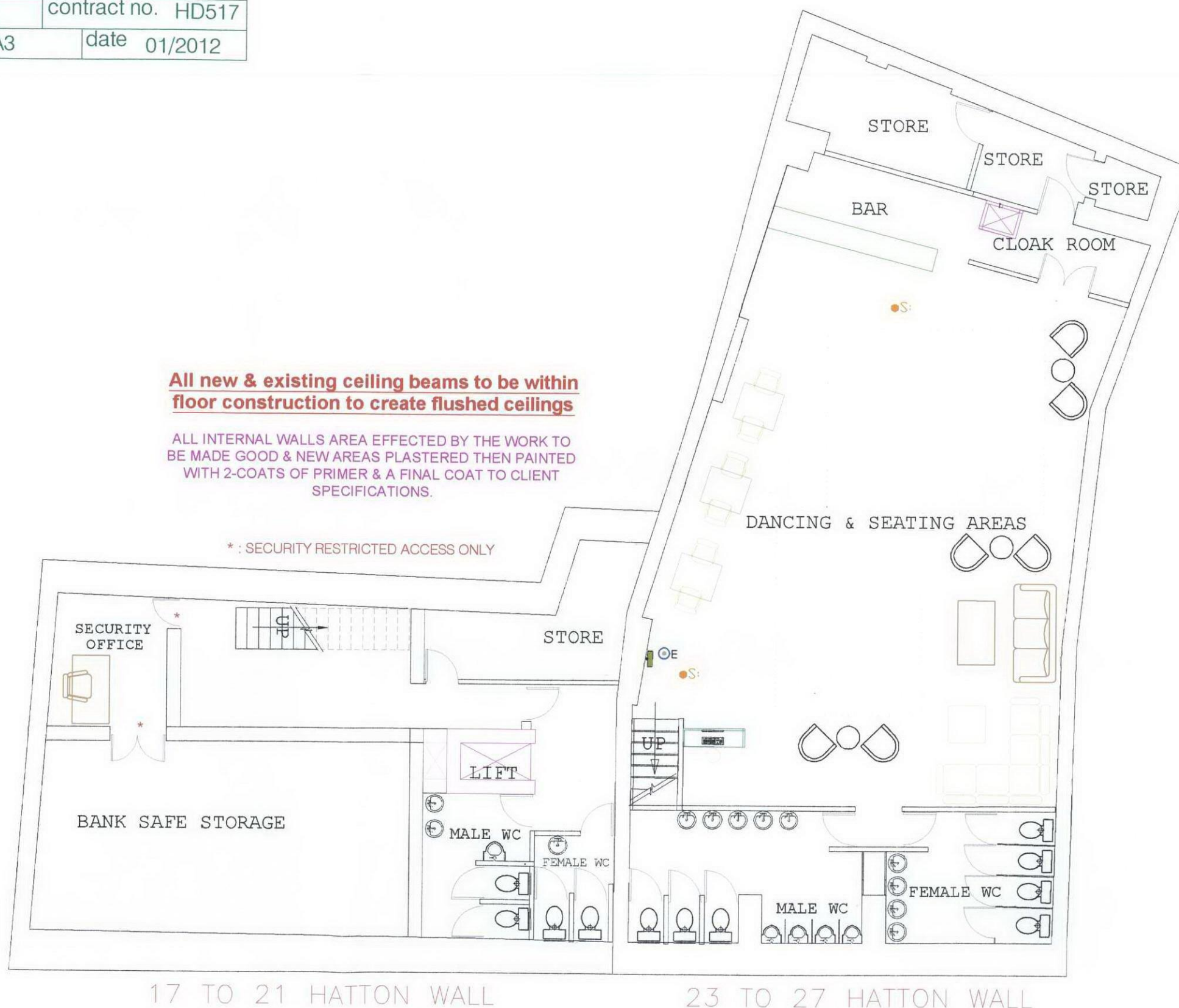

## BASEMENT LEVEL