

00. INDEX

Drawing Number	Drawing Title	Description
E12005/00	Index	Index of Drawings.
E12005/01	Location Plan	Scale 1:1250 at A4.
E12005/02	Block Plan	Photo of Site from above.
E12005/03	Roof Plan	Drawing of block from above, showing equipment positions.
E12005/04	South West Elevation 1	Description and location of the antenna, dishes and Main Cabinet + mounting
E12005/05	South West Elevation 2	Description of cable routes, colour and loom sizes per flats at entry points for each drops
E12005/06	South West Elevation 3	Description of cable routes, colour and loom sizes per flats at entry points for each drops (Remote)
E12005/07	South East Elevation 1	Description of cable routes, colour and loom sizes per flats at entry points for each drops
E12005/08	South East Elevation 2	Description of cable routes, colour and loom sizes per flats at entry points for each drops
E12005/09	Existing Equipments	View and location of existing equipment on site
E12005/10	Antenna, Dish Sizes & Typical Mounting Heights	Antenna and Dishes description, mounting, position, height and measurements.

Form No. SCC 013 SCC International – 1 Fieldings Road, Cheshunt, Herts, EN8 9TL, . Tel: 01992 642255. Website: www.scci.co.uk

Drawing No.	E12005/00	Site Address:	1-26 ASCOT LODGE, GREVILLE ROAD LONDON NW6 5JD		
Date:	17/10/2011	Site Ref:	LBC 0233.0	Surveyed By:	G. Henebery
Number of Points:	26	System Type	9Wire IRS Sky Plus	Drawn By:	W. Kisala



Please consider the environment before printing this document – Recycle Wherever Possible



02. Block Plan



Form No. SCC 013 SCC International – 1 Fieldings Road, Cheshunt, Herts, EN8 9TL, . Tel: 01992 642255. Website: www.scci.co.uk

Drawing No.

E12005/02

Site Address:

1-26 ASCOT LODGE, GREVILLE ROAD LONDON NW6 5JD

Date:

17/10/2011

Site Ref:

LBC 0233.0

Surveyed By:

G. Henebery

Number of Points:

26

System Type

9Wire IRS Sky Plus

Drawn By:

W. Kisala



Please consider the environment before printing this document – Recycle Wherever Possible



- All cables + Link cable (brown) to run horizontally from the Main cabinet located on the rear wall of flat 26 then below/ above 1st floor level and vertically Up/down to all lounge points at the rear of the building.
- Link cables to run from Main Cabinet at the same level (1st floor) to the remote cabinet rear wall of flat 8
- 2 cables to feed each flat at entry points.

Proposed position of the Antenna and Dishes located on roof on the side wall of flat 26 at high

Proposed position and location of light grey metal Main cabinet. Sized 80x80cm on the rear wall of flat 26

Proposed position and location of light grey metal Remote cabinet. Sized 80x80cm on the rear wall of flat 5

Cable to run below balcony at 1st floor level

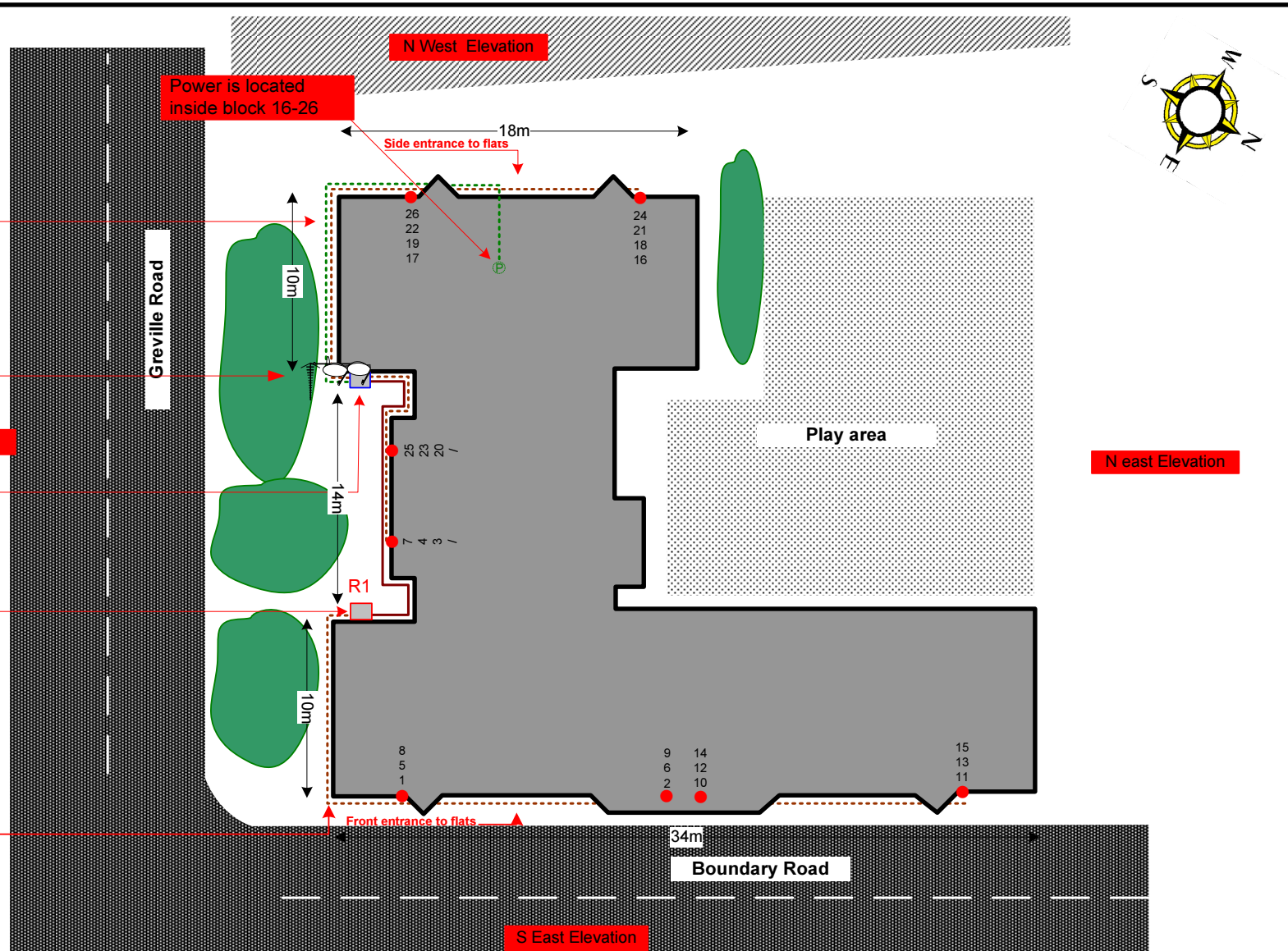

Form No. SCC 013 SCC International – 1 Fieldings Road, Cheshunt, Herts, EN8 9TL, . Tel: 01992 642255. Website: www.scci.co.uk



Please consider the environment before printing this document – Recycle Wherever Possible



Drawing No.	E12005/03	Site Address:	1-26 ASCOT LODGE, GREVILLE ROAD LONDON NW6 5JD	
Date:	17/10/2011	Site Ref:	LBC 0233.0	Surveyed By: G. Henebery
Number of Points:	26	System Type	9Wire IRS Sky Plus	Drawn By: W. Kisala



Each property will have two cables to lounge position.

Cable Harness sizes

2-4 cables = 15mm

6-8 cables = 20mm

10-14 cables = 30mm

16-18 Cables = 35mm

20 cables = 40mm

40 cables = 65mm

60 cables = 90mm

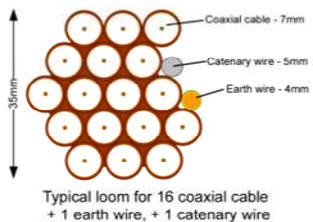

04. South West Elevation 1

Proposed location of UHF Aerial on a 4m pole mounted using wall bracket and 80cm dishes mounted using lashing kits. All installed off the rear wall of flat 26 at high.

Brown Pvc cable to run from the main cabinet above ground and 1st floor then up vertically to feed entry points

Proposed position and location of light grey metal Main cabinet. Sized 80x80cm on the side wall of flat 26.

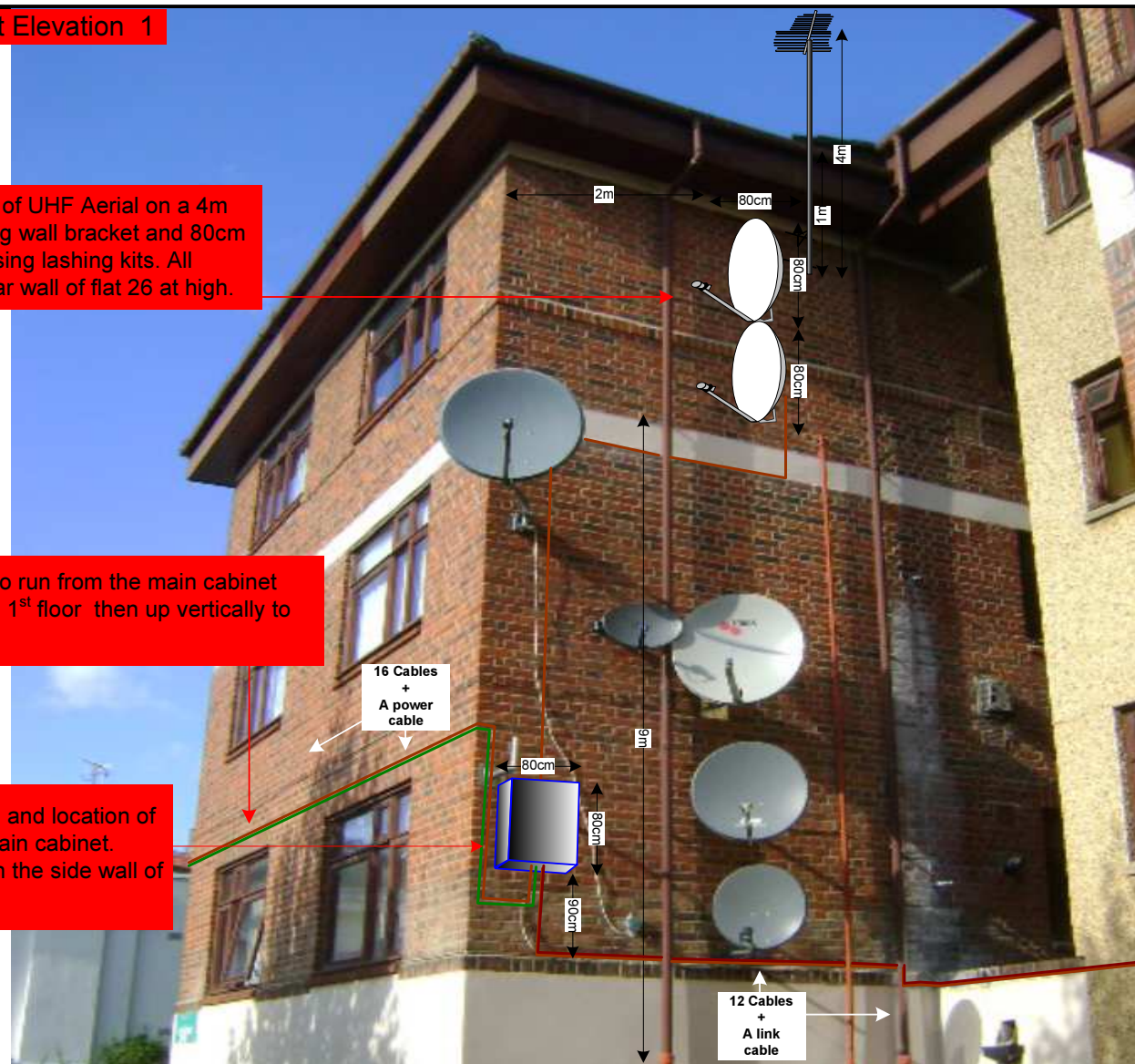

Form No. SCC 013 SCC International – 1 Fieldings Road, Cheshunt, Herts, EN8 9TL. . Tel: 01992 642255. Website: www.scci.co.uk

Drawing No.	E12005/04	Site Address:	1-26 ASCOT LODGE, GREVILLE ROAD LONDON NW6 5JD
Date:	17/10/2011	Site Ref:	LBC 0233.0
Number of Points:	26	System Type	9Wire IRS Sky Plus
		Surveyed By:	G. Henebery
		Drawn By:	W. Kisala



Please consider the environment before printing this document – Recycle Wherever Possible



Each property will have two cables to lounge position.

Cable Harness sizes

2-4 cables = 15mm

6-8 cables = 20mm

10-14 cables = 30mm

16-18 Cables = 35mm

20 cables = 40mm

40 cables = 65mm

60 cables = 90mm

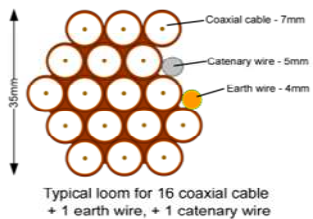

05. South West Elevation 2



Form No. SCC 013 SCC International – 1 Fieldings Road, Cheshunt, Herts, EN8 9TL, . Tel: 01992 642255. Website: www.scci.co.uk

Drawing No.	E12005/05	Site Address:	1-26 ASCOT LODGE, GREVILLE ROAD LONDON NW6 5JD
Date:	17/10/2011	Site Ref:	LBC 0233.0
Number of Points:	26	System Type	9Wire IRS Sky Plus
		Drawn By:	W. Kisala



Please consider the environment before printing this document – Recycle Wherever Possible



Each property will have two cables to lounge position.

Cable Harness sizes

2-4 cables = 15mm

6-8 cables = 20mm

10-14 cables = 30mm

16-18 Cables = 35mm

20 cables = 40mm

40 cables = 65mm

60 cables = 90mm

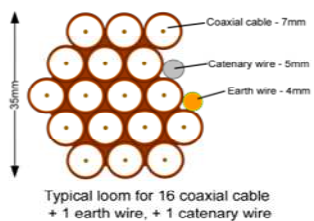

Form No. SCC 013 SCC International – 1 Fieldings Road, Cheshunt, Herts, EN8 9TL, . Tel: 01992 642255. Website: www.scci.co.uk

Drawing No. E12005/06 Site Address: 1-26 ASCOT LODGE, GREVILLE ROAD LONDON NW6 5JD

Date: 17/10/2011 Site Ref: LBC 0233.0 Surveyed By: G. Henebery

Number of Points: 26 System Type: 9Wire IRS Sky Plus Drawn By: W. Kisala



Please consider the environment before printing this document – Recycle Wherever Possible



Each property will have two cables to lounge position.

Cable Harness sizes

2-4 cables = 15mm

6-8 cables = 20mm

10-14 cables = 30mm

16-18 Cables = 35mm

20 cables = 40mm

40 cables = 65mm

60 cables = 90mm

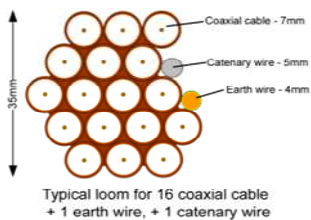

07. South East Elevation 1

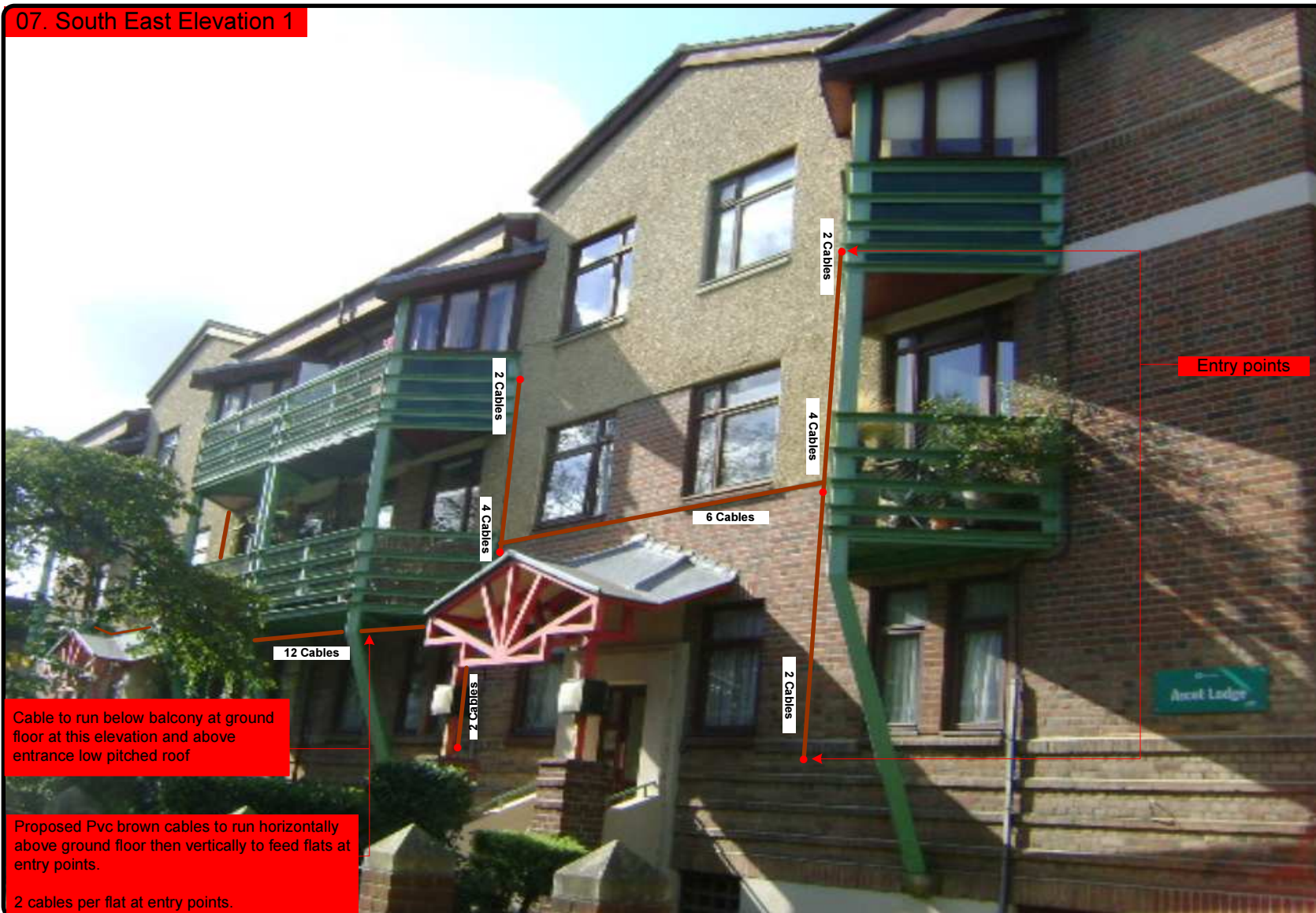

Form No. SCC 013 SCC International – 1 Fieldings Road, Cheshunt, Herts, EN8 9TL, . Tel: 01992 642255. Website: www.scci.co.uk

Drawing No.	E12005/07	Site Address:	1-26 ASCOT LODGE, GREVILLE ROAD LONDON NW6 5JD
Date:	17/10/2011	Site Ref:	LBC 0233.0
Number of Points:	26	System Type	9Wire IRS Sky Plus
		Surveyed By:	G. Henebery
		Drawn By:	W. Kisala



Please consider the environment before printing this document – Recycle Wherever Possible



Each property will have two cables to lounge position.

Cable Harness sizes

2-4 cables = 15mm

6-8 cables = 20mm

10-14 cables = 30mm

16-18 Cables = 35mm

20 cables = 40mm

40 cables = 65mm

60 cables = 90mm

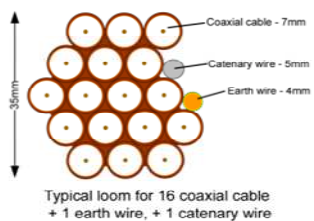

08. South East Elevation 2



Form No. SCC 013 SCC International – 1 Fieldings Road, Cheshunt, Herts, EN8 9TL, . Tel: 01992 642255. Website: www.scci.co.uk

Drawing No.	E12005/08	Site Address:	1-26 ASCOT LODGE, GREVILLE ROAD LONDON NW6 5JD
Date:	17/10/2011	Site Ref:	LBC 0233.0
Number of Points:	26	System Type	9Wire IRS Sky Plus
		Surveyed By:	G. Henebery
		Drawn By:	W. Kisala



Please consider the environment before printing this document – Recycle Wherever Possible



Each property will have two cables to lounge position.

Cable Harness sizes

2-4 cables = 15mm

6-8 cables = 20mm

10-14 cables = 30mm

16-18 Cables = 35mm

20 cables = 40mm

40 cables = 65mm

60 cables = 90mm

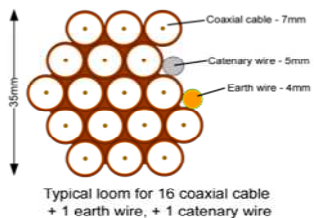

09. Existing Equipments

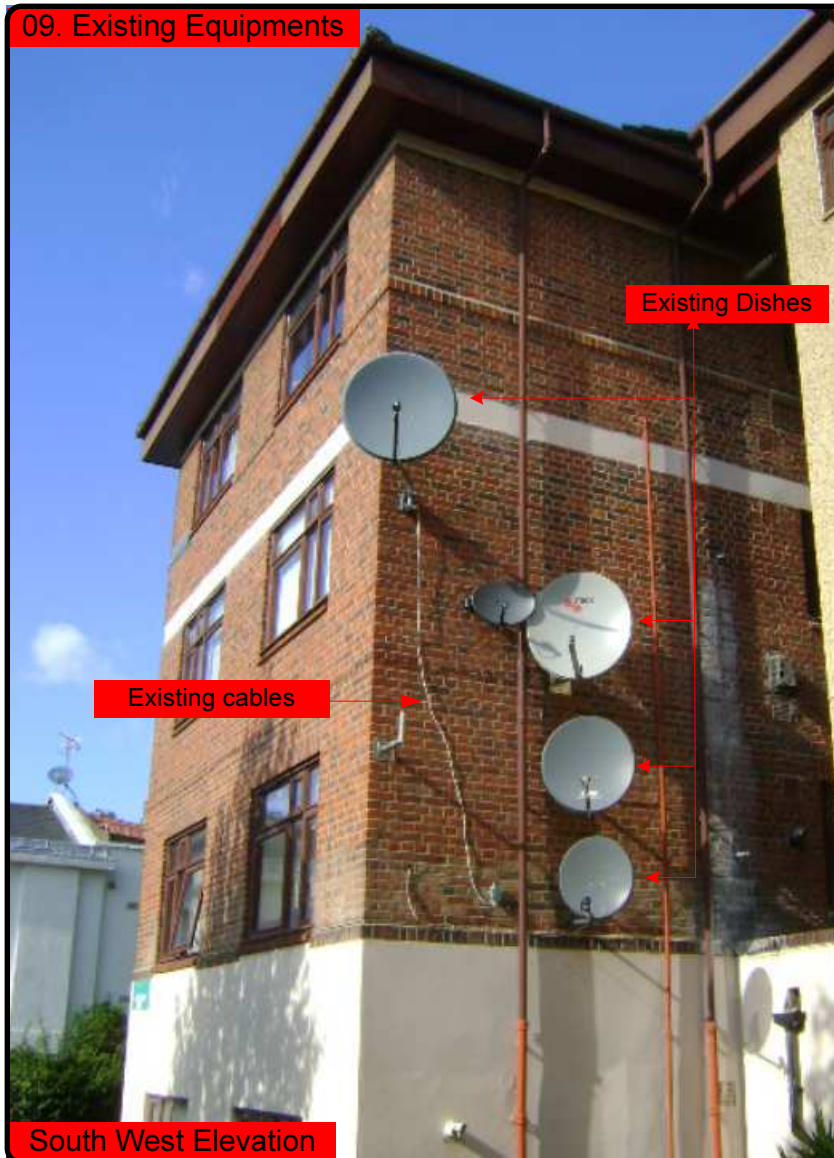

South West Elevation



South East Elevation

Form No. SCC 013 SCC International – 1 Fieldings Road, Cheshunt, Herts, EN8 9TL, . Tel: 01992 642255. Website: www.scci.co.uk

Drawing No.

E12005/09

Site Address:

1-26 ASCOT LODGE, GREVILLE ROAD LONDON NW6 5JD

Date:

17/10/2011

Site Ref:

LBC 0233.0

Surveyed By:

G. Henebery

Number of Points:

26

System Type

9Wire IRS Sky Plus

Drawn By:

W. Kisala



Please consider the environment before printing this document – Recycle Wherever Possible



10. Antenna and Dishes Measurements

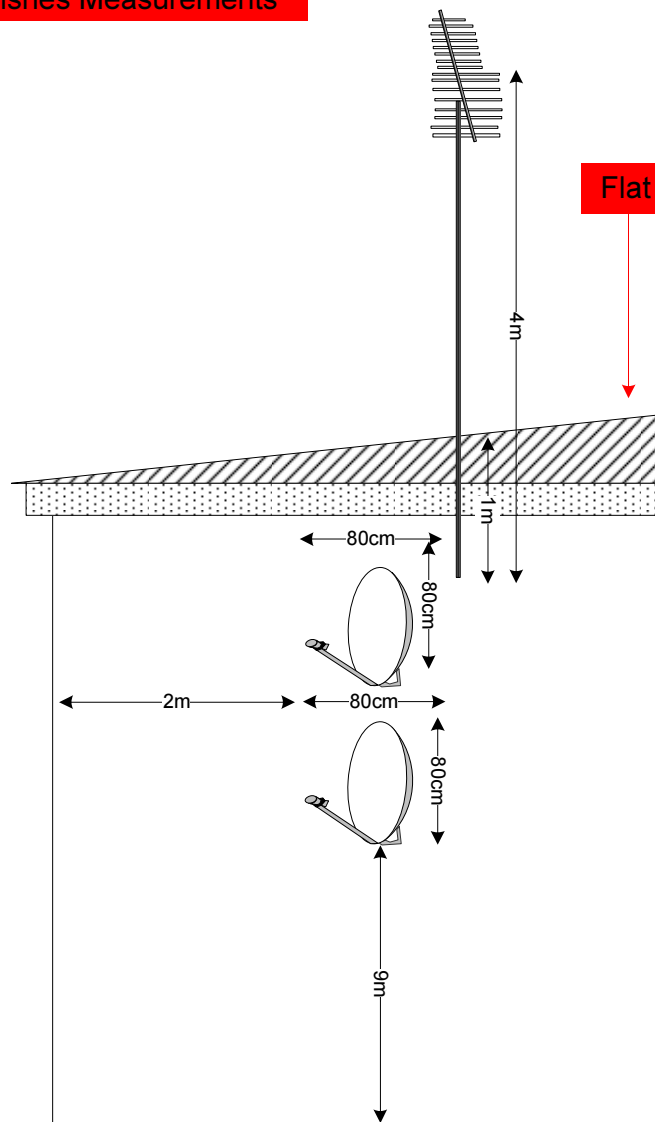

Flat roof apex.

Digital TV,
FM & DAB Radio
Aerials

Proposed location of UHF Aerial on a 3m pole mounted using wall bracket and 80cm dishes mounted using lashing kits. all installed on the rear wall of flat 26 at high.

Form No. SCC 013 SCC International – 1 Fieldings Road, Cheshunt, Herts, EN8 9TL, . Tel: 01992 642255. Website: www.scci.co.uk

Drawing No.	E12005/10	Site Address:	1-26 ASCOT LODGE, GREVILLE ROAD LONDON NW6 5JD
Date:	17/10/2011	Site Ref:	LBC 0233.0
Number of Points:	26	System Type	9Wire IRS Sky Plus
		Drawn By:	W. Kisala



Please consider the environment before printing this document – Recycle Wherever Possible

