



THIS DRAWING IS THE COPYRIGHT OF THE ANGLIA DESIGN LLP AND CAN ONLY BE REPRODUCED WITH THEIR EXPRESS PERMISSION.

WRITTEN DIMENSIONS MUST BE USED IN PREFERENCE TO SCALED. IF DOUBT EXISTS PLEASE CONTACT AD LLP FOR CLARIFICATION.

PARTICULAR CARE TO BE TAKEN WHEN DRAWINGS HAVE BEEN RECEIVED ELECTRONICALLY. AD LLP CANNOT GUARANTEE SCALING INFORMATION UNLESS DRAWINGS HAVE BEEN PRINTED IN HOUSE.

CONTRACTORS MUST CHECK ALL DIMENSIONS ON SITE. ANY DISCREPANCIES TO BE REPORTED TO AD LLP BEFORE PROCEEDING.

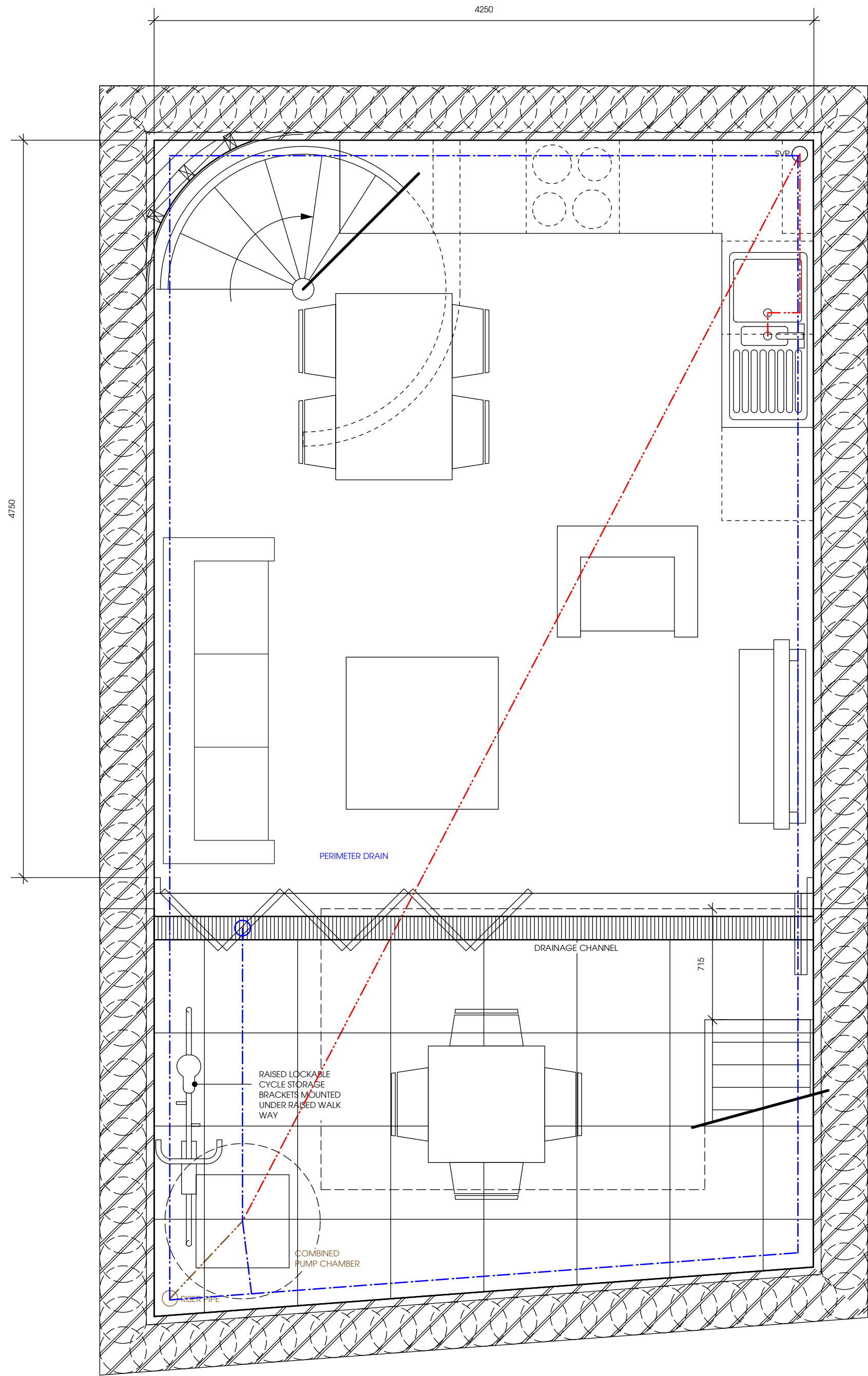

BASEMENT PLAN 1:25 @ A1

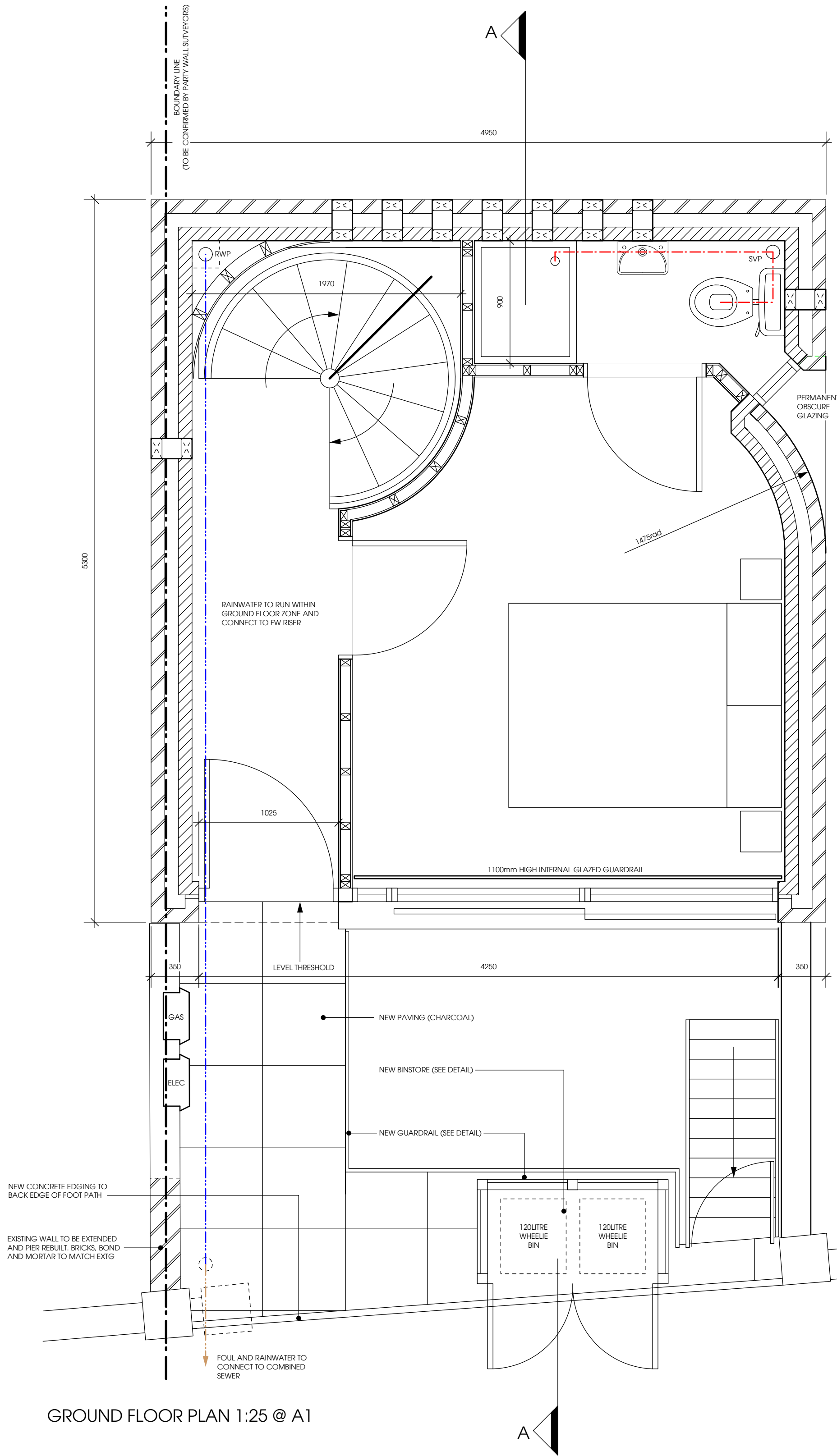

GROUND FLOOR PLAN 1:25 @ A1

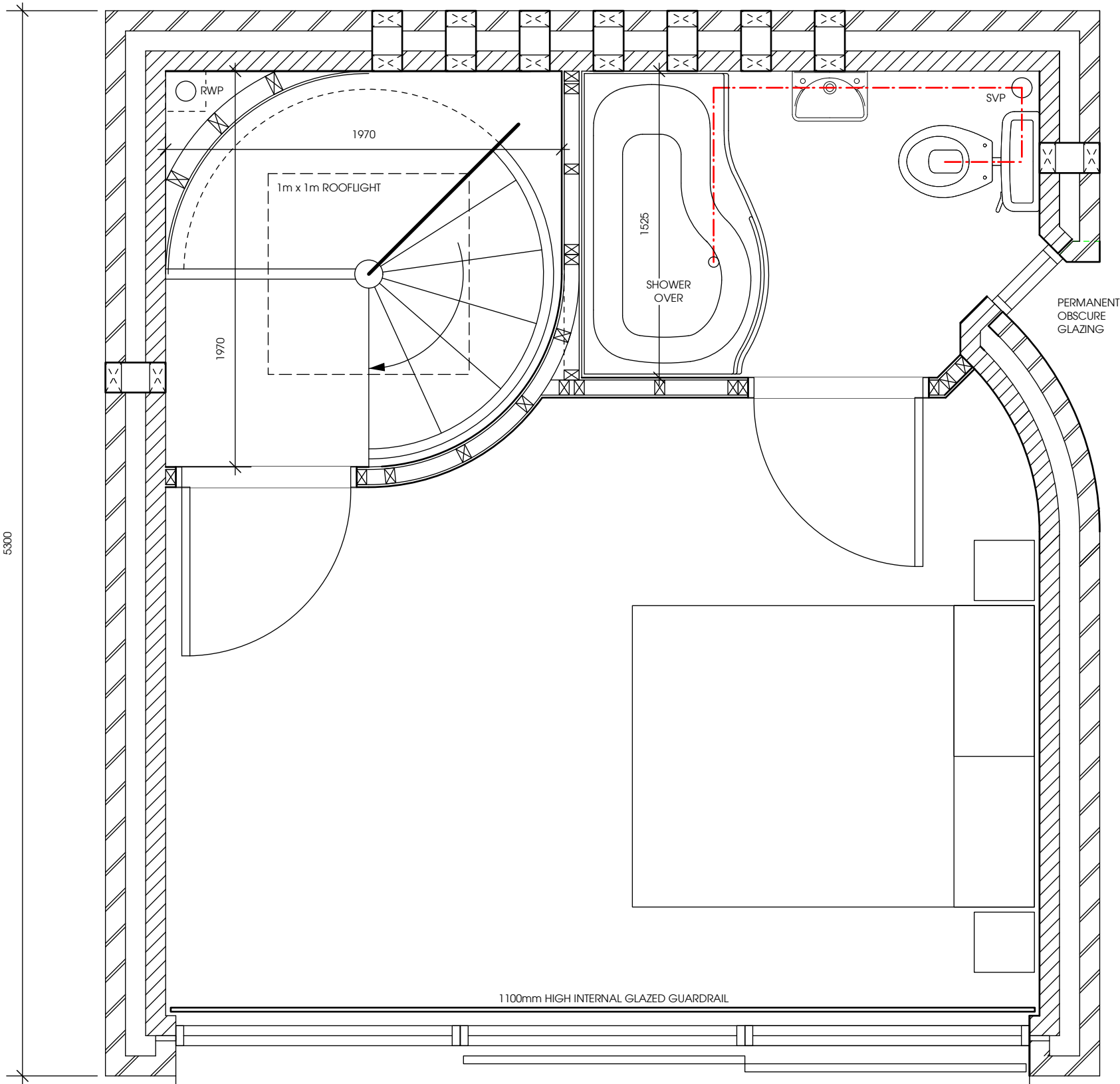

FIRST FLOOR PLAN 1:25 @ A1

- D 09-03-12 PLANNING RESUBMISSION
- C 13-10-11 BOUNDARY LINE CONFIRMED
- B 11-10-11 BUILDING REGULATIONS ISSUE
- A 21-09-11 PLANNING RESUBMISSION ISSUE

Anglia Design
architects . surveyors **LLP**

11 Charing Cross Norwich Norfolk NR2 4AX
tel: 01603 666576 fax: 01603 764535
em: mail@angliadesign.co.uk

FLOOR PLANS

98b SUMATRA ROAD,
London, NW6 1PP

Drawing No: RS/3155/11/01

Date: August 2011