

GENERAL NOTES

1. Do not scale this drawing for Construction purposes.
2. All dimensions in this dwg. are metric.
3. This drawing & all other drawings & schedules, specifications, details etc. relating to this project are copyright of **PMA**.
4. This drawing shall be read in strict conjunction with all other relevant architects' structural engineer's & services engineer's drawings, calculations, details & specifications.
5. The contractor shall check all dimensions & setting out information on this or other related drawings prior to placing work in hand. Any errors or discrepancies between documents shall be reported to the architect & seek clarification.
6. All proprietary products shall be used & fixed in strict accordance with manufacturers' printed recommendations, notes, specifications etc.
7. Only drawings stamped 'ISSUED FOR CONSTRUCTION' shall be used on site.

KEY TO SECTIONS:

Existing Structure retained

New structure proposed

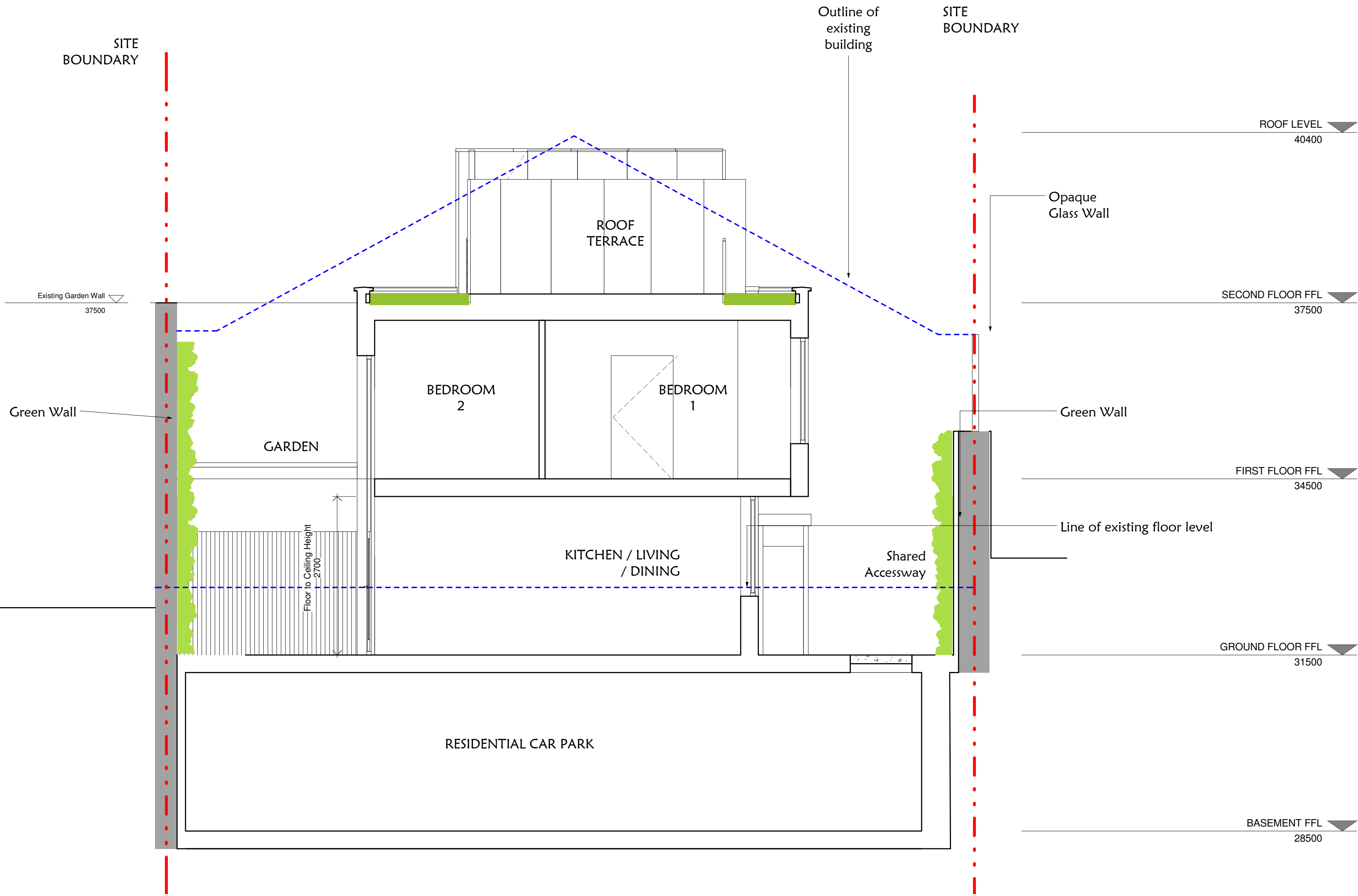

HOUSES ON
GLOUCESTER AVENUE

APPLICATION SITE

RAILWAY
SIDINGS

SECTION L-L
1 : 50

No. Revision	Date	Description	Chk.
--------------	------	-------------	------

Originator/Author
pma chartered architects
PO Box 1034 Wembley, Middlesex HA9 9GY. e: pma@pm-architects.com
T: +44 (0) 7887 646 957; T +44 (0) 78130 202 130. w: www.pm-architects.com

Client
IZABELLE INVESTMENTS LTD.

Job Title
1 DUMPTON PLACE, PRIMROSE HILL NW1 8JB

Job Number: 01DP

Drawing Title
SECTION L-L

Scale 1 : 50@A1	Date Drawn 13/03/2012 08:43:14	Drawn By MK
Date of Issue 10/01/2012		Checked By NP

Drawing Originator	Project Reference	Drawing Number	REV.
PM	A	01DP	5028

TOWN PLANNING
Drawing Status