

**GENERAL NOTES**

1. Do not scale this drawing for construction purposes.  
2. All dimensions in this dwg, are metric.  
3. This drawing & all other drawings & schedules, specifications, details etc. relating to this project are copyright of **PMA**.  
4. This drawing shall be read in strict conjunction with all other relevant architects' structural engineer's & services engineer's drawings, calculations, details & specifications.  
5. The contractor shall check all dimensions & setting out information on this or other related drawings prior to placing work in hand. Any errors or discrepancies between documents shall be reported to the architect & seek clarification.  
6. All proprietary products shall be used & fixed in strict accordance with manufacturers' printed recommendations, notes, specifications etc.  
7. Only drawings stamped 'ISSUED FOR CONSTRUCTION' shall be used on site.

KEY TO SECTIONS:

- Existing Structure retained
- New structure proposed

HOUSES ON  
GLOUCESTER AVENUE

SECTION H-H

1 : 50

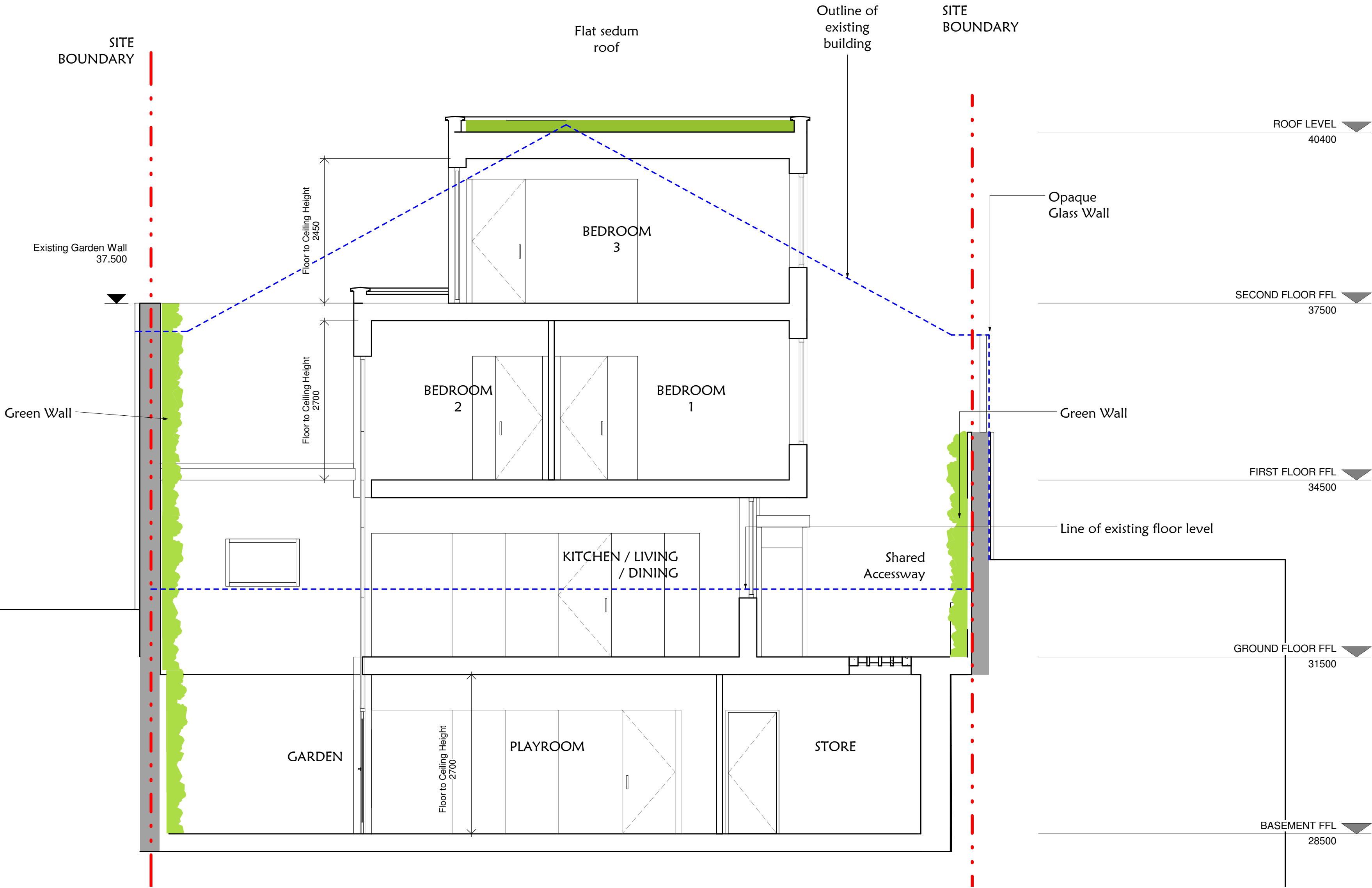

No. Revision	Date	Description	Chk.
--------------	------	-------------	------

Originator/Author

**pma**

chartered architects

PO Box 1034 Wembley, Middlesex HA0 9GY. e: pma@pm-architects.com  
T: +44 (0) 7887 646 957; T +44 (0) 78130 202 130. w: www.pm-architects.com

Client

IZABELLE INVESTMENTS LTD.

Job Title  
1 DUMPTON PLACE, PRIMROSE HILL NW1 8JB

Job Number: 01DP

Drawing Title  
SECTION H-H

Scale 1 : 50@A1	Date Drawn 13/03/2012 08:39:50	Drawn By MK
Date of Issue 10/01/2012		Checked By NP

Drawing Originator PM	Project Reference A	Drawing Number 01DP	REV. 5025
--------------------------	------------------------	------------------------	--------------

TOWN PLANNING

Drawing Status