

NOTES

Existing windows are single glazed steel Crittall type windows in timber subframes that are themselves linings to further substructure that has replaced the original Georgian timber frames.

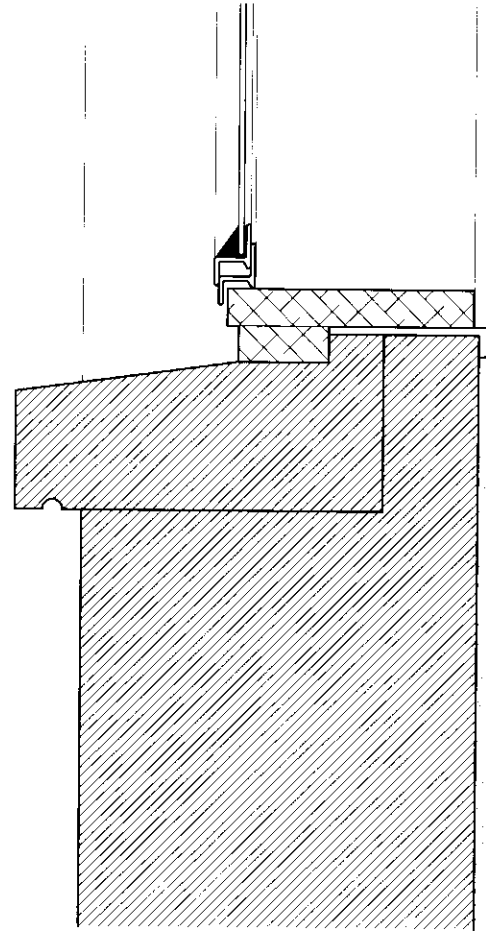

OUTSIDE

INSIDE

Client

G AND A GORRARA LTD

Project

31-32 ARGYLE SQUARE
LONDON W1H 8AP

Title

TYPICAL EXISTING WINDOW DETAIL

Job No

11024

Date

27/2/12

Dwg No

E/2-J01

Scale

1:5 @ A3

Rev

-

Drwn

DI

Stage

-

Chkd

-

R O H ARCHITECTS

25 Lonsdale Road
London NW6 6RA

Tel +44 [0]20 7372 7576
Fax +44 [0]20 7372 0078

info@roh-architects.com

www.roh-architects.com