

15.00m ABOVE ORDANANCE DATUM

SECTION E - E

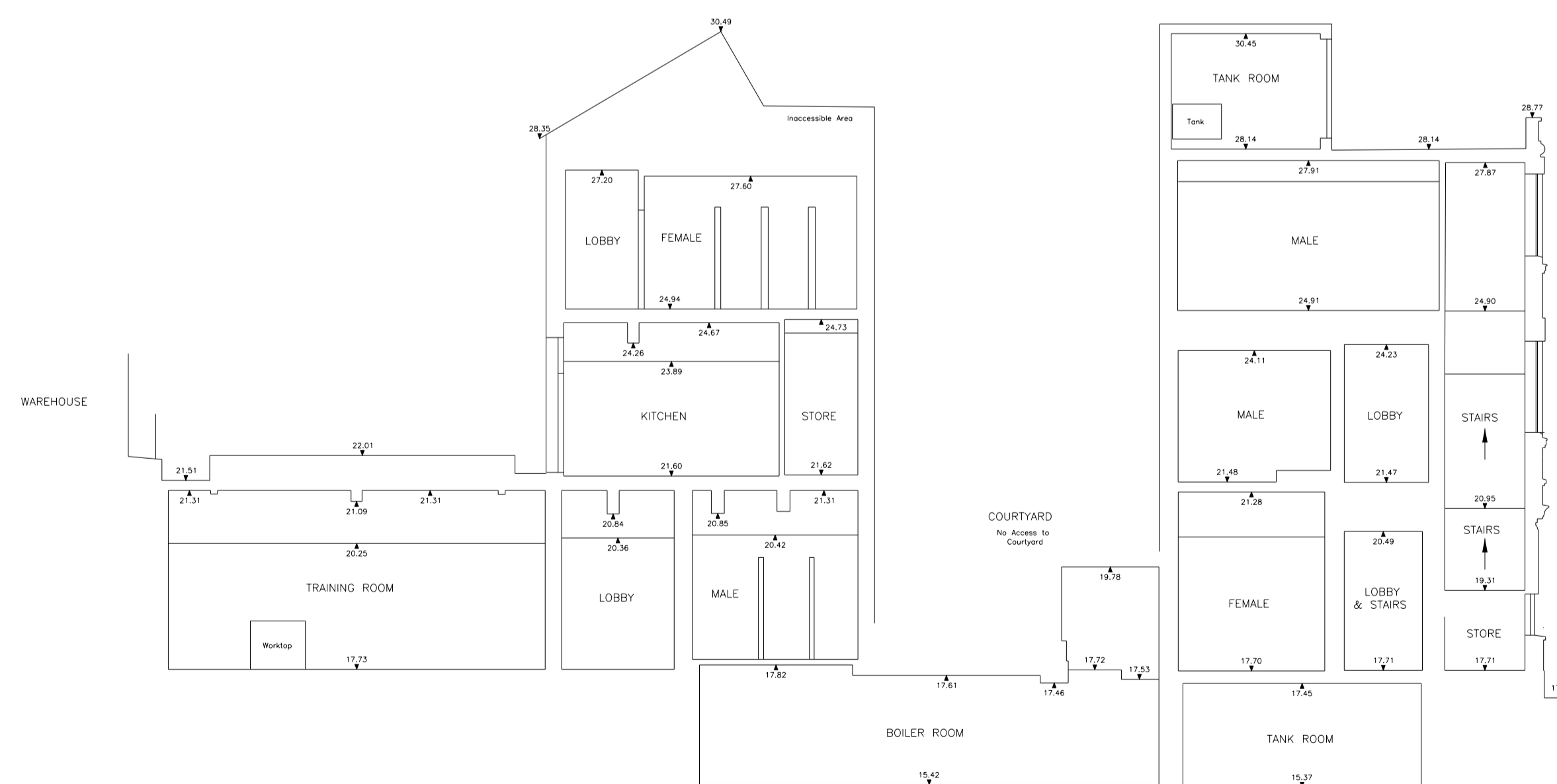

15.00m ABOVE ORDANANCE DATUM

SECTION F - F

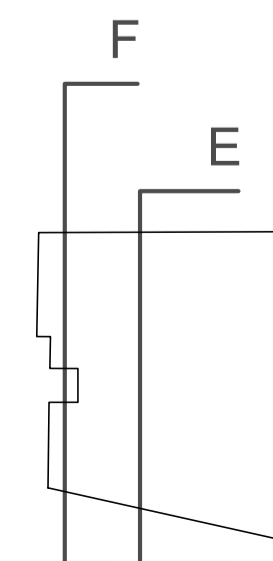

Note:
 Survey information contained in this drawing has been created by
 Plowman Craven Ltd.
 All survey information is issued in good faith.
 Feilden Clegg Bradley Studios LLP will not be held responsible for any
 inaccuracies identified.



FeildenCleggBradleyStudios
 LLP
 Bath Brewery
 Toll Bridge Road
 Bath BA1 7DE
 t 01225 852545
 f 01225 852528
 e bath@fcbstudios.com

A SUBMITTED FOR PLANNING 28.02.12
 Amendment Date

APPLICATION FOR
 FULL PLANNING CONSENT

BRITISH POSTAL MUSEUM & ARCHIVE
 MOUNT PLEASANT, LONDON
 CALTHORPE HOUSE
 SECTIONS AS EXISTING
 SHEET 1 OF 3
 Do not scale
 Original printed at A1

Job/Drawing No
 1625/SU/100
 Amendment
 A
 Scale 1:100 (1:200 @ A3)
 Date OCTOBER 2011
 Drawn STUDIO 8
 All dimensions to be checked on site