

189 SUMATRA ROAD EXISTING SINGLE STOREY REAR EXTENSION

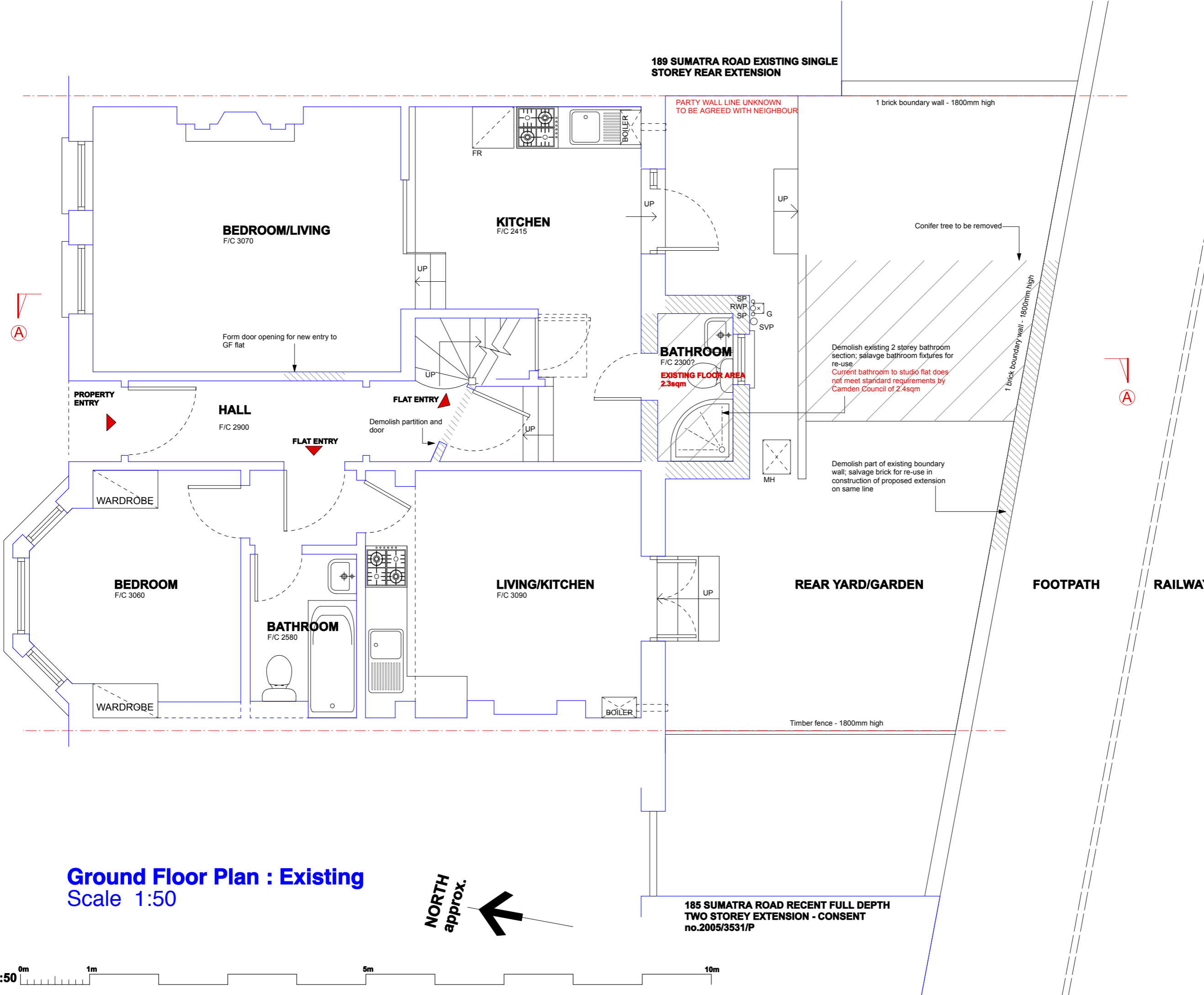

Ground Floor Plan : Existing
Scale 1:50

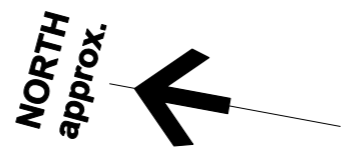

185 SUMATRA ROAD RECENT FULL DEPTH TWO STOREY EXTENSION - CONSENT
no.2005/3531/P

REVISIONS	Date	Int
-----------	------	-----

Job: 187 Sumatra Road - Rear Extension
Client: Ms Hamideh Guest
Title: Ground Floor Plan : Existing
Scale: 1 : 50 @ A3
 Drawing No: **12/01/02**
 Rev: **B**
 Drawn by: NB
 Date: 12/04/12