

Section and plan of typical replacement slimlite glazing 1:10

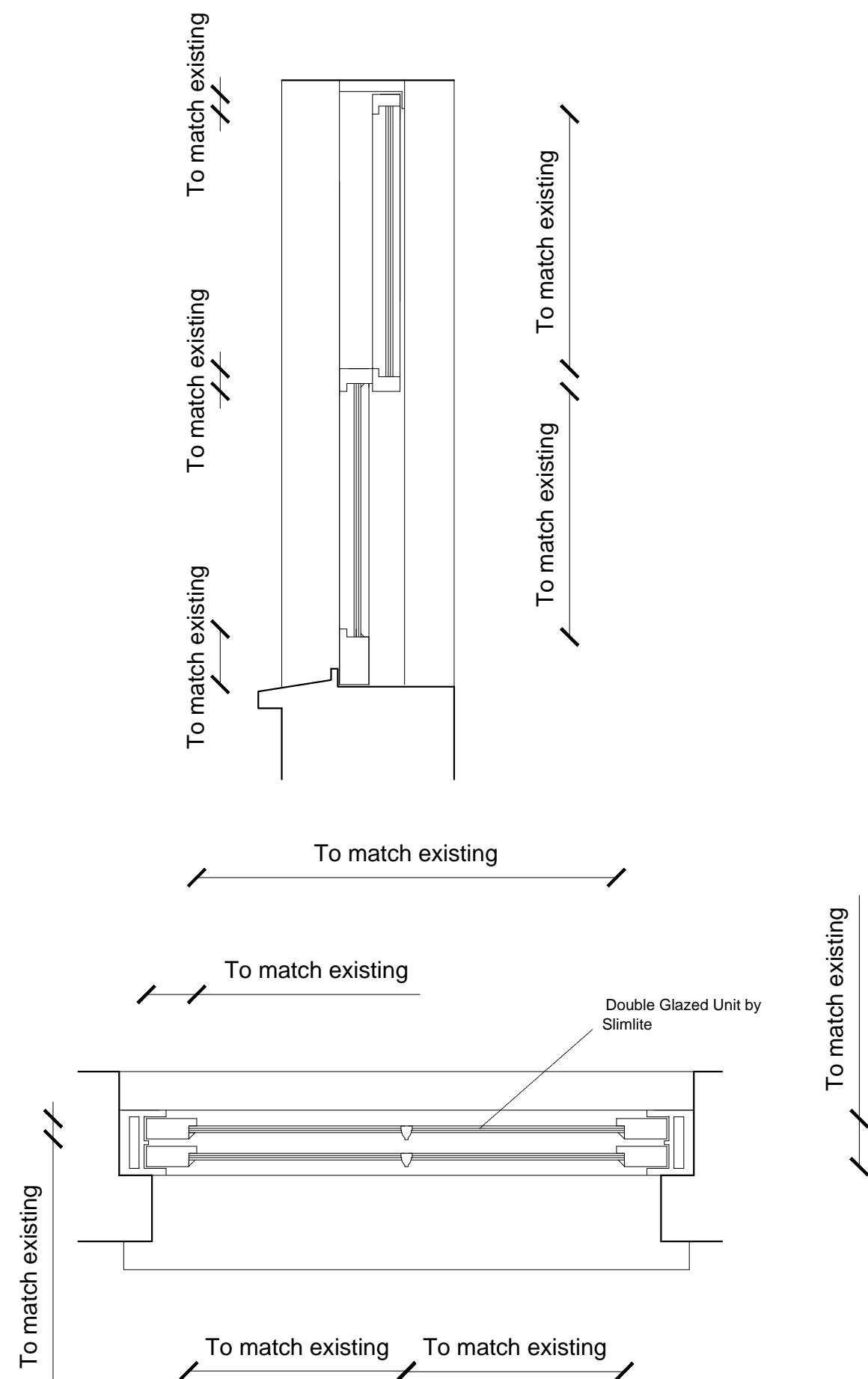

Typical glazing bar/astragal detail 1:1

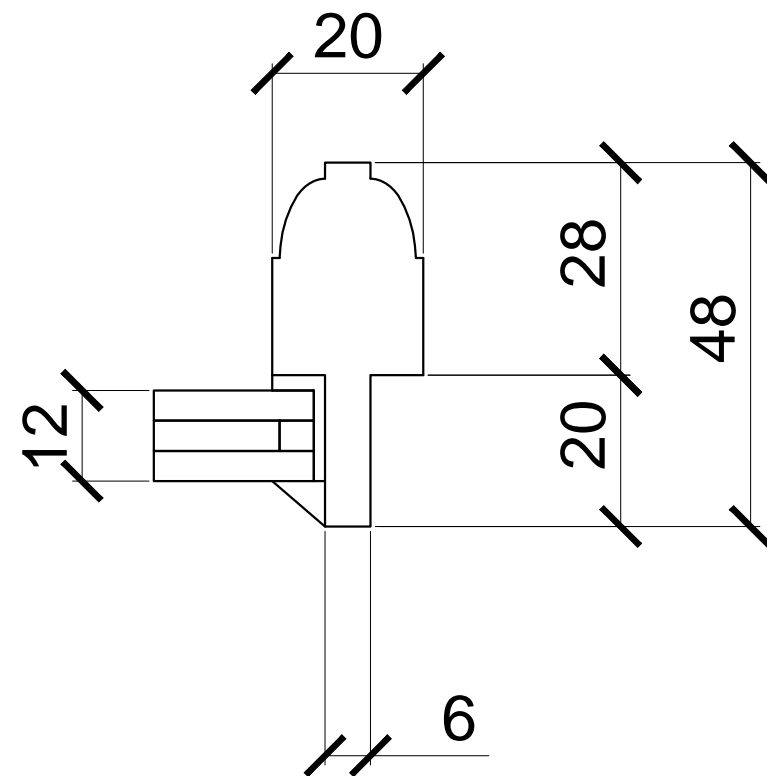

PROPOSED TYPICAL TIMBER
SLIDING SASH WINDOW DETAILS

1. All frames, sashes, sills, glazing bars and mullions to match existing windows, in style, scale and proportions.
2. All windows to be painted white timber to match existing timber sliding sash windows in Lawford Road
3. New Windows to be fitted with new 'SlimLite - Double Glazing'.

rev.	date	description		revit
revisions				
stage		drawing title		
PLANNING		PROPOSED TYPICAL REPLACEMENT WINDOW SECTION AND		
Lipton Plant Architects		Do not scale from this drawing. This drawing is copyright		
		Islington Green Studios 81-83 Essex Road Islington London N1 2SF		
		T +44 (0)20 7288 1333 E mail@lparc F +44 (0)20 7288 0333 W www.lparc		
		client Sarah Roeder & Richard Wald		
		project 3 Lawford Road Camden London NW5		
scale	date issued	drawn by	drawing no	revit
1:10 & 1:1 @A3	2012.05.10	BC	247.(1).4.003	--