

Enclosure Construction Details

The enclosure is constructed of internal and external 9mm exterior grade plywood sheets and the cavity will be filled with 50mm Rockwool insulation at 100kg/cubic M.

The plywood is to be painted charcoal grey on the exterior face with 40 x 20mm timber slats mounted in a horizontal configuration. These will be stained a suitable colour TBC.

The enclosure is accessed through a purpose built door which will be built in an identical construction and have suitable seals on all sides to maintain the acoustic performance.

Internally the enclosure will have a suitable softwood timber framework to support all aspects.

Note that all materials in the enclosure and the construction will provide min 1 hour fire protection.

The 'roof' of the enclosure will have a proprietary felt roof construction over plywood sheets and have a suitable fall to allow the removal of rainwater. This will in turn be ejected by the existing drainage on the flat roof.

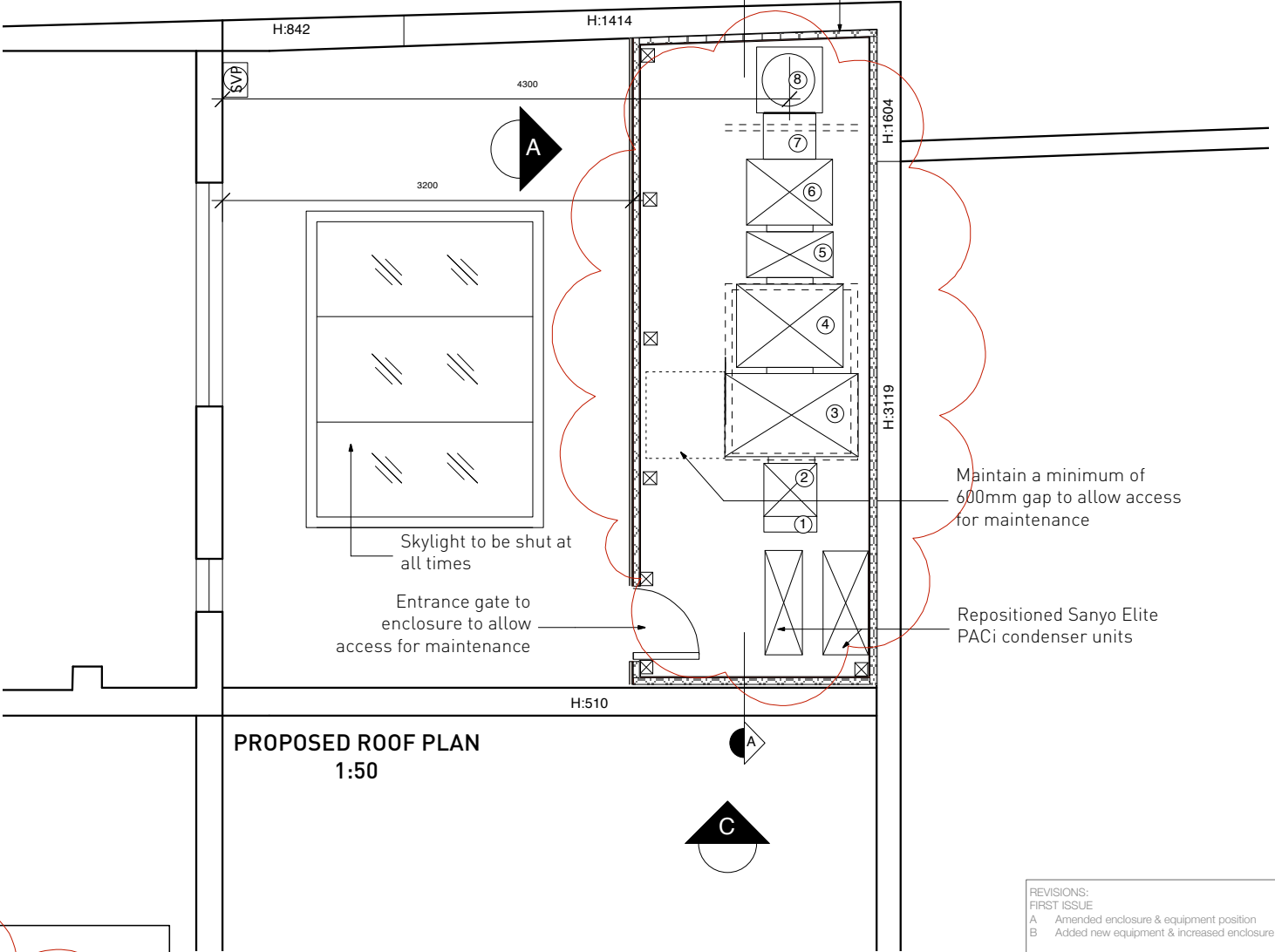
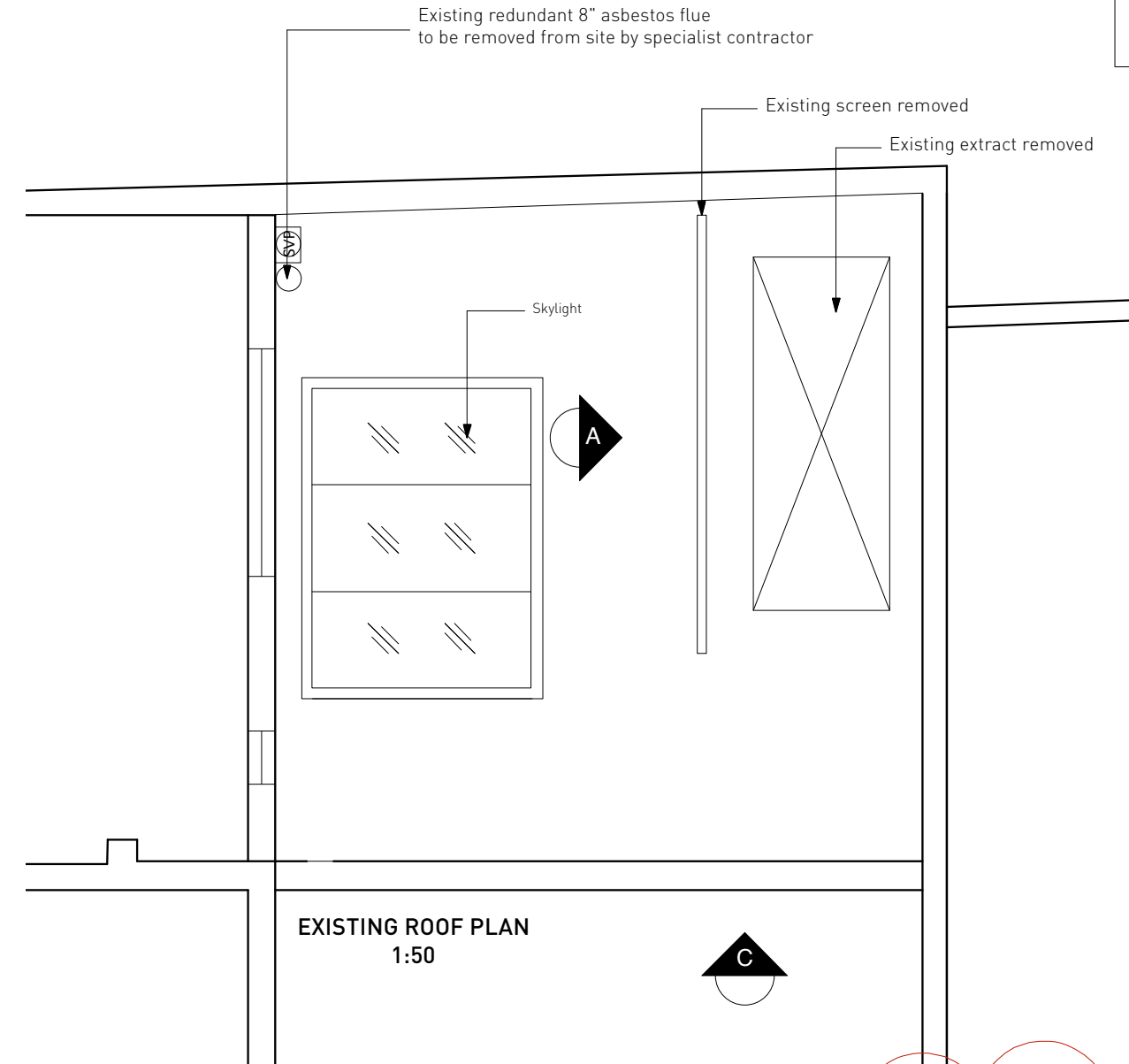

Schedule of kitchen extract equipment

- 1 Existing air duct rising from kitchen
- 2 Connecting duct 400 x 400
- 3 Electrostatic Precipitator ESP 3000E from Purified Air
- 4 UV-C Odour Control Technology UVC 3000 from Purified Air
- 5 Flackwoods 56 JM axial fan Motor ref: 50JM DX 511466
- 6 Flackwoods axial fan Silencer ref: SB271401
- 7 Connecting duct 400 x 400
- 8 Elbow directing trickle feed through to exit
- 9 Metal platform table to support equipment
- 10 'Big foot' legs to support elbow

NOTE: Existing ON 100 odour neutraliser equipment to remain positioned in the kitchen

REVISIONS:		
FIRST ISSUE		25.07.11
A	Amended enclosure & equipment position	11.10.11
B	Added new equipment & increased enclosure	18.05.12

TITLE EXISTING AND PROPOSED PLANS	
CLIENT GREENLEAF INVESTOR	
PROJECT 48 RED LION STREET, WC1	
DRAWING NO. 100	REVISION B
JOB NO. 1075	DATE 19.05.11
DRAWN BY: SE	SCALE 1: 50 @A3
<small>This drawing is the copyright of SEED Design. Figured dimensions to be taken in preference to those stated. All dimensions to be checked on site before any work proceeds. The contractor is to provide full site setting out drawings based on the information contained in this drawing for the designers approval prior to commencing manufacture. The drawing is issued on the condition that it is not reproduced, related or disclosed to any unauthorised person either wholly or in part without the consent in writing from SEED Design.</small>	
SEED Studio Ltd, 1 Queens Square, Bath, BA1 2HA Tel. 01225 904554 info@seeddesign.net	