

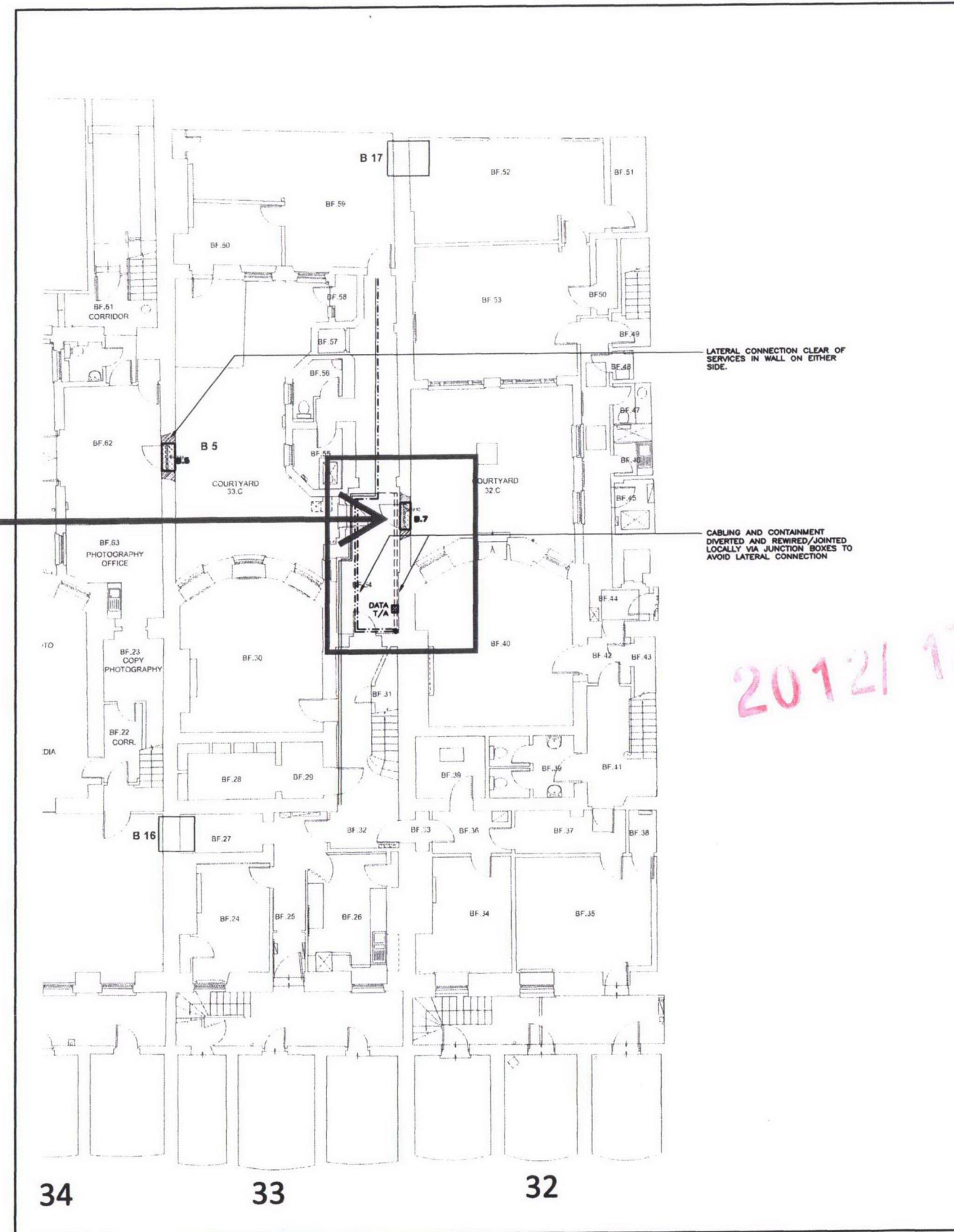

--- Indicative location of lateral connection

IMAGE 1

EXTRACT FROM WW DRAWING P1B-406-LC  
(REFER TO DRAWING FOR FURTHER INFORMATION)



DIVERSIONS AGAINST  
FUTURE LAYOUT

- NOTES:
1. TO BE READ IN CONJUNCTION WITH ALL OTHER MF DOCUMENTATION ACCOMPANYING THIS DRAWING IN ISSUED PACKAGE OF INFORMATION.
  2. THE ENTIRE LV DISTRIBUTION SYSTEM SHALL BE DESIGNED, INSTALLED, TESTED AND COMMISSIONED IN ACCORDANCE WITH THE REQUIREMENTS OF THE IEE WIRING REGULATIONS (17TH EDITION BS 7671:2001).
  3. LOCATIONS OF EXISTING SERVICES TO BE CONFIRMED BY SURVEY BY CONTRACTOR.
  4. DO NOT SCALE FROM THIS DRAWING. SETTING OUT OF BUILDERSWORK AND ARCHITECTURAL ELEMENTS TO BE TAKEN FROM ARCHITECT'S DRAWINGS.
  5. M&E CONTRACTOR TO PRODUCE FABRICATION DRAWINGS IN ADVANCE OF COMMENCEMENT ON SITE DESCRIBING EXACT ROUTES OF NEW INSTALLATION.

- LEGEND:
- EXISTING SERVICES TO BE RETAINED
  - EXISTING SERVICES TO BE REMOVED
  - NEW SERVICES RUNNING ALONG EXISTING ROUTES AT LOW LEVEL
  - NEW SERVICES RUNNING ALONG EXISTING ROUTES AT HIGH LEVEL
  - NEW SERVICES CONCEALED AT LOW LEVEL IN FLOOR
  - T/A NEW SERVICES RISING TO ABOVE
  - T/B NEW SERVICES DROPPING TO BELOW

PHASE  
1B

30/01/12 FOR PLANNING - PHASE 1B  
04/10/11 FOR PRICING - PHASE 1B  
DRAWING REF CHANGE FROM V(---)3307  
rev date description eng

MAX FORDHAM

Max Fordham LLP  
42-43 Gloucester Crescent  
London  
NW1 7PE  
T: +44 (0) 20 7667 5161  
F: +44 (0) 20 7482 0329  
maxfordham.com

Registered in England No. 03300026  
Registered Office 42-43 Gloucester Crescent London W61 7PE

architect  
WRIGHT AND WRIGHT  
ARCHITECTS

Job title  
ARCHITECTURAL ASSOCIATION  
WORKSHOP PROJECTS

project leader date scale (at A1)  
JR JUN 2011 1:100

drawing title  
ELECTRICAL INSTALLATION  
& DIVERSIONS  
BASEMENT Nr. 32 & 33

Job no dwg no rev  
4328 V(---)9200 /\*