

SITE LOCATION

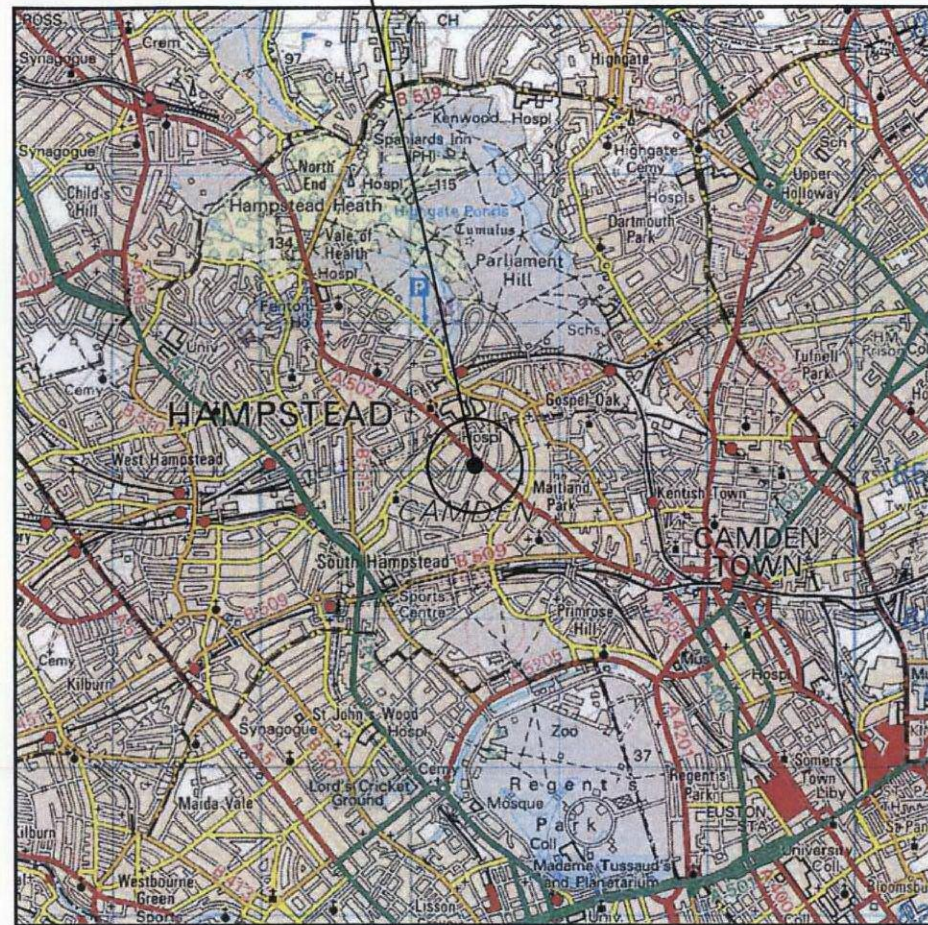

0 1km 2km
Scale

SITE LOCATION
(Scale 1:50000)

Ordnance Survey map extract based upon Landranger map series with the permission of the controller of Her Majesty's Stationery Office
Mono Consultants Limited licence no. ES100017753
Crown copyright.

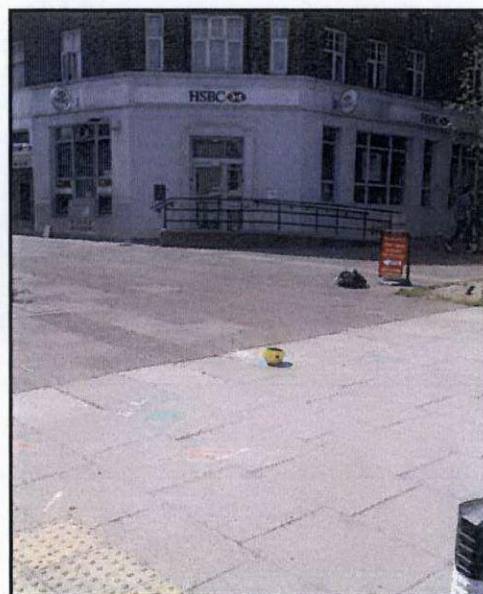

SITE PHOTOGRAPH

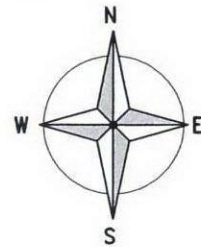

SITE LOCATION

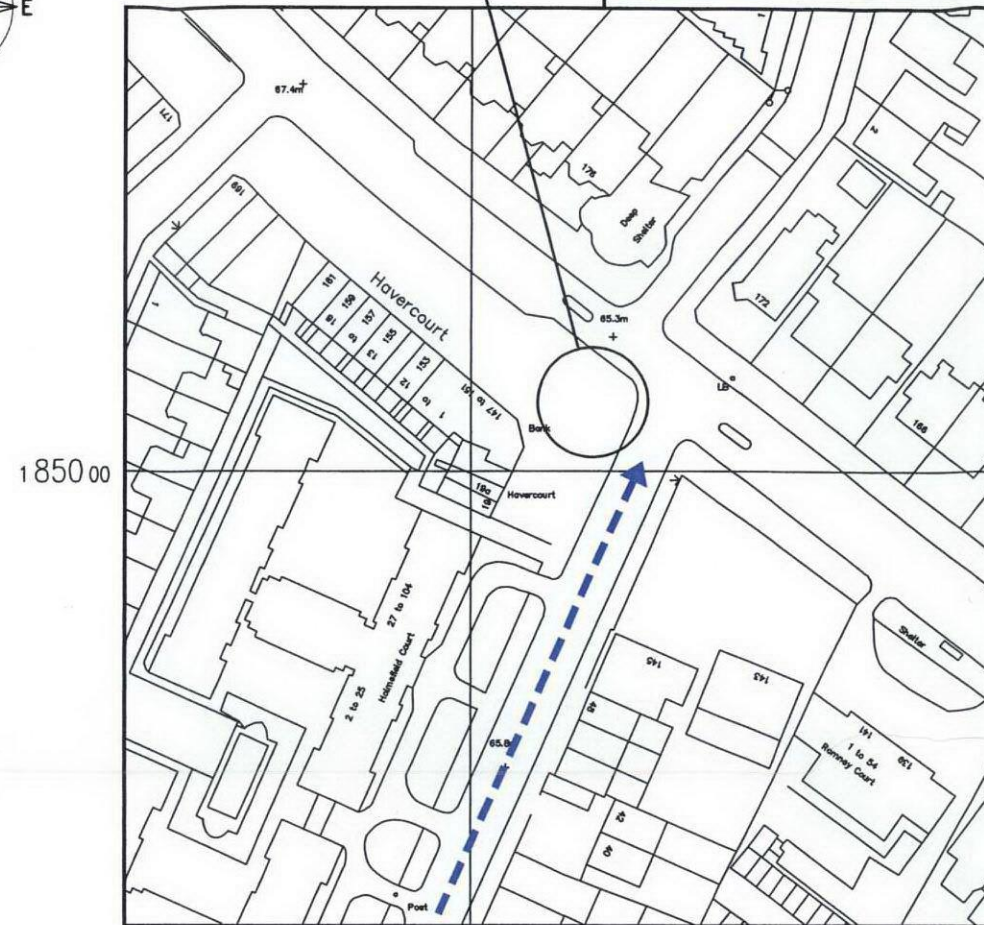

1850 00

5274 00

DETAILED SITE LOCATION
(Scale 1:1250)

Based upon Ordnance Survey map extract with the permission of the Controller of Her Majesty's Stationery Office.
Crown copyright.
Mono Consultants Limited licence no. ES100017753
Promap licence no. A152065A0001

← - Access Route
← - Directions to Site

Notes:
1 ALL DIMENSIONS ARE IN MM UNLESS NOTED OTHERWISE

N.G.R. E: 527422 N: 185014

DIRECTIONS TO SITE

From the M1 Junction 1 exit onto the N.Circular Road/A406 towards C.London/Wood Green. Follow for approx. 0.4 mile and take the A41 exit towards Aylesbury. At the roundabout take the 3rd exit onto Brentfield Gardens and continue for approx. 0.3 mile. Follow onto Brent Cross Flyover/A41, continue for approx. 1.4 miles and turn right onto Finchey Road/A41. Follow for approx. 1.3 miles and turn left onto College Crescent. Turn right onto the B511 and then 1st left onto Belsize Park. Turn left to stay on Belsize Park, take 3rd right onto Belsize Park Gardens and then 2nd left onto Belsize Park Grove. The site is located on the left hand side at the junction with Haverstock Hill.

A	Issued for Approval	JT	DL	30.05.12
REV	MODIFICATION	BY	CH	DATE

mono #
MONO CONSULTANTS LIMITED
No. 58 Cygnet Court
Timothy's Bridge Road
Stratford-upon-Avon
Warwickshire
CV37 9NW
t. 44 (0)1789 206500
f. 44 (0)1789 206529
www.monoconsultants.com



Cell Name	Opt
HAVERSTOCK HILL SW	A

Cell ID No		
Cornerstone	Host	Sharer
(CS) 10381	(VF) 47008	(O2) 044424

Site Address / Contact Details
JCT OF HAVERSTOCK HILL & BELSIZE DRIVE
LONDON
NW3 4TX

Drawing Title: **SITE LOCATION MAPS**

Purpose of issue: **PLANNING**

Drawing Number: **100**

Scale:	As Shown	Drawn:	JT	Date:	30.05.12	Issue:	A
Checked:	DL	Date:	30.05.12	Approved:	SRR	Date:	30.05.12