

ROOF COVERING - Proprietary single layer PVC system ('Derbigum Single Layer' or similar approved) laid over existing asphalt with additional rigid insulation board (to falls - 'Thermataper' insulation system or similar approved) on top for 0.25 U Value.

STATUTORY SIGNAGE - New statutory signage provided as required throughout. Illuminated signs to be provided as required.

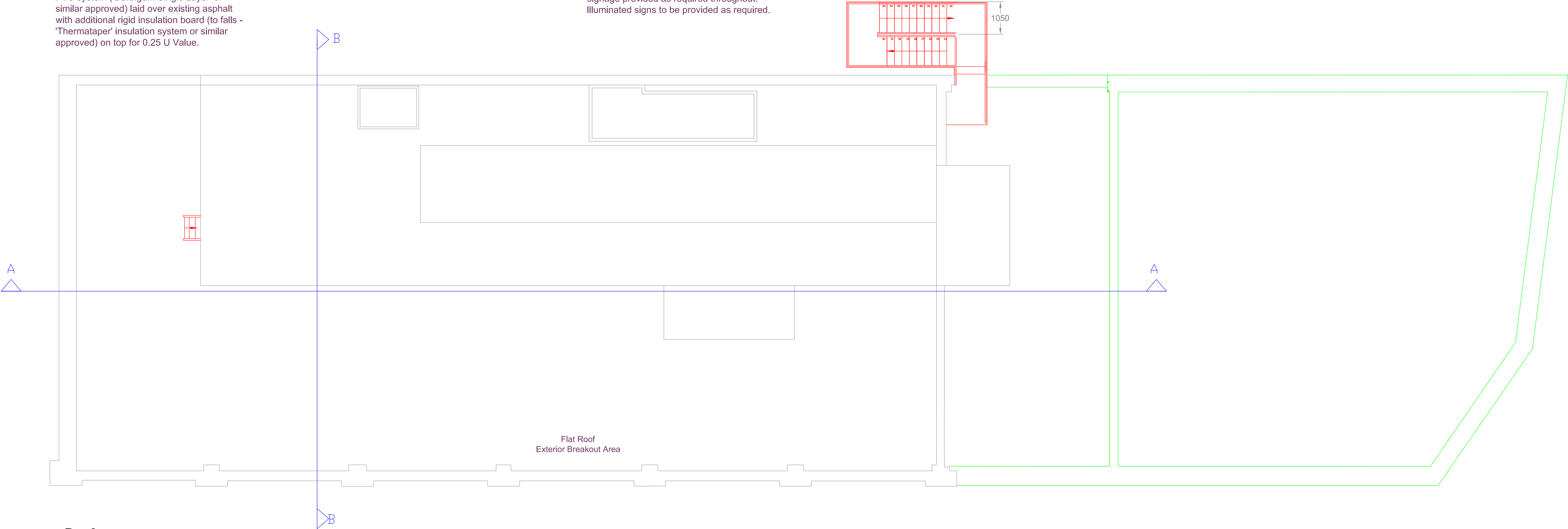

Roof

P O W E R L I N K H O U S E

H E A D H O U S E

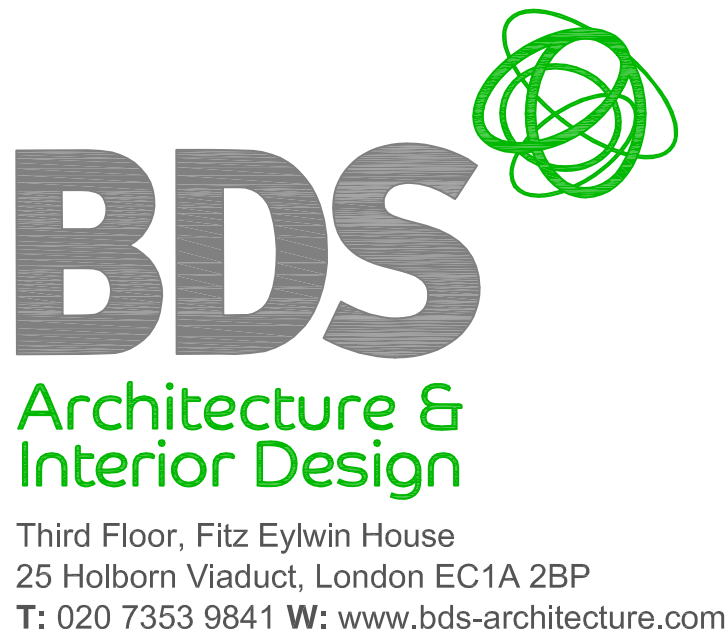

client:
UKPN

site:
Powerlink House
(57 Pratt Street), NW1
&
St. Pancras Head House

project:
Proposed Alterations
& Improvements

drawing title:
Proposed
Roof Plan

B. 04.05.12 - Revised for Planning.			
revisions			
date:	scale @ A0:	drawn:	Ck:
17.07.11	1:50	CC	
PRA.106.PR.06			rev.
			B