

CEILINGS - All ceilings on Ground Floor to be retained.

On 1st, 2nd & 3rd Floors - Armstrong square gridded system
600x600x18mm Dune Max Tegalur tiles (or similar approved).

LIGHTING - On 1st, 2nd & 3rd Floors:
600mm x 600mm recessed LG3 fluorescent fittings. Ref M&E
Products Lists.

WALLS - All walls to be decorated with three coats of matt
emulsion. The predominant colour is to be consistent, with feature
walls to be identified. Please refer to the finishes schedule and
walls finishes plan. Where appropriate all walls are to receive a new
MDF profile skirting to match existing.

GENERAL PARTITIONS - (Max. 3.7M High) from FFL to U/S of
ceiling. Two layers of plaster board (Wallboard) each side of 48mm
Gypframe "C" Sluds at 600mm centres and the addition of 25mm
Isowool APR 1200 within the cavity.
NB: Each side of partition up to be height of a standard board circa
2.4M, the internal skin is to be replaced of OSB for future flexibility of
fixing.

GLAZED FRONTS - Logica 5000 system single glazed partitioning
system (or similar approved);
Frame Colour - Ral 0096
Glass Thickness - 12mm

DOORS - Existing doors are to be retained at Ground Level. These
are to be made good of any damage, new ironmongery fitted where
required and decorated.

Existing front doors to be replaced for new identical doors to match.
Doors to be decorated and fitted with dead lock, push plates and
pull handles and catches to hold doors open during normal working
hours. Floor to be deep cleaned and matt well + matt retained.

STATUTORY SIGNAGE - New statutory signage on hungers or
fixed to walls/doors, etc. to be provided as required throughout.
Illuminated signs to be provided as required.

New Escape Staircase -
(W213 & W214 are to be $\frac{1}{2}$ hr.
FR. windows)
Ducts penetrating these
windows require fire dampers.

Meeting Room (partition opened)

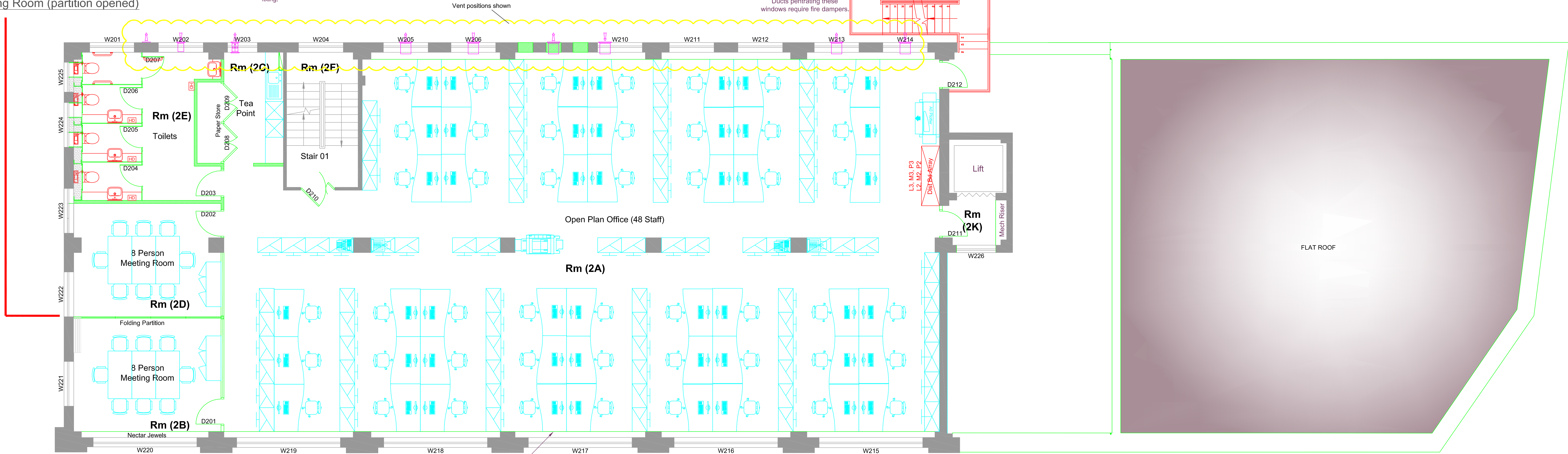

Second Floor

TEA POINTS - (1C), (2C) & (3A - Tea Point) to be
availed with Kitchen Units from Howden Joinery or
similar approved. Contractor to supply white goods -
dishwasher and larder fridge / freezer. Contractor to
supply white goods. Rows of ceramic tiles to the height
of the underside of the wall cpbd's to follow the line and
return of the base units. Please refer to Finishes
Schedule.

TOILETS - Floor to ceiling height proprietary,
laminated (oak) panel cubicle & wall ling
system by Thirlington Products Ltd. or
similar approved.
Sanitaryware from Armitage Shanks or
similar approved - Ref. Finishes Schedule

Front And Back Walls, Boxed Out Flush
Between Piers For Continuous Dado Rail

Around periphery, exterior walls to be dry lined on Gypframe (or
similar) "I" studs to create a flush fenestration without piers.

GLASS MANIFESTATION - Two rows of manifestation / circular dots
circa 65mm diameter set at 500mm & 1500mm height.

MEETING ROOMS - (GH), (GJ), (1B), (2B), (2D), (3E) & (3F) all to
have acoustic bats above suspended ceiling to underside of
structural slab.

SERVICES - Refer to M&E Products Lists, compiled Floor by
Floor (Room by Room)
Note: All pipes and cables to pass through a cable port and to be
intermiscently filled with foam wherte passing through
Compartment Walls

POWER, VOICE & DATA:
New three compartment proprietary dado trunking around
perimeter of space to provide power, data and voice to each
desk and room. MK Electrics Prestige 3d range or similar
approved - Ref. Finishes Schedule.

P O W E R L I N K H O U S E

H E A D H O U S E

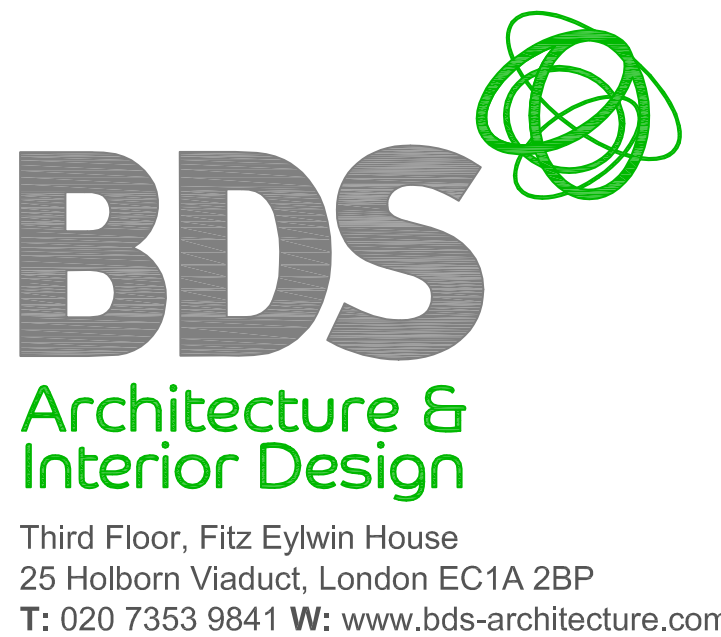

client:

UKPN

legend:

— New partitions

site:

Powerlink House
(57 Pratt Street), NW1
&
St. Pancras Head House

project:

Proposed Alterations
& Improvements

drawing title:

Proposed Second
Floor Plan

E. 10.09.11 - Meeting revisions
D. 22.08.11 - Section lines added
C. 16.08.11 - M&E notes
B. 10.08.11 - Meeting modifications
A. 21.07.11 - Client modifications
revisions

H. 04.05.12 - Revised for Planning.
G. 04.04.12 - Vent positions shown
F. Tender issue

date:	scale @ A0:	drawn: Ck:
17.07.11	1:50	

PRA.106.PR02	rev.
	H