

PROPOSED

GROUND FLOOR

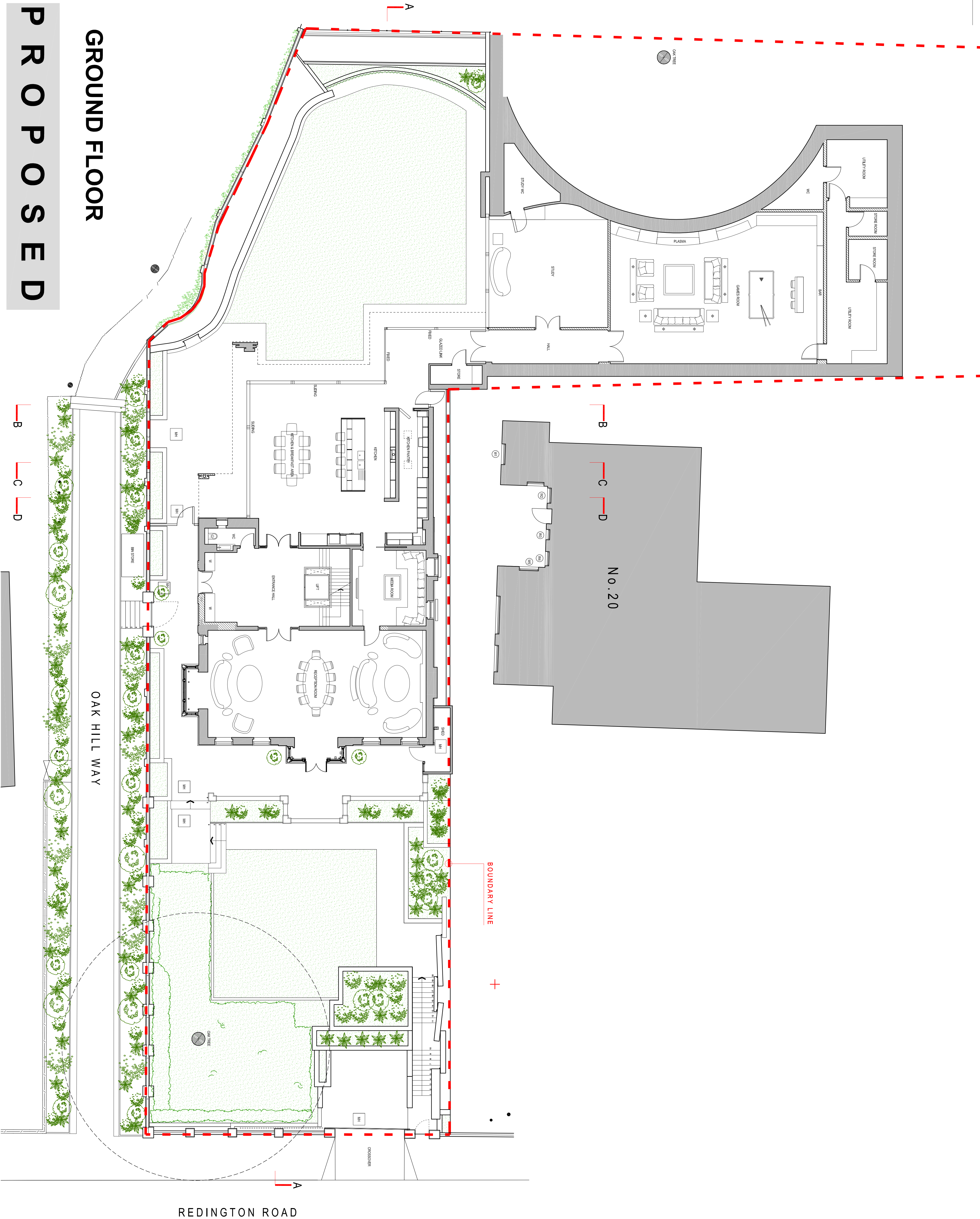

- PROPOSED WORKS

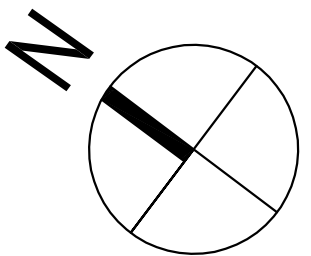
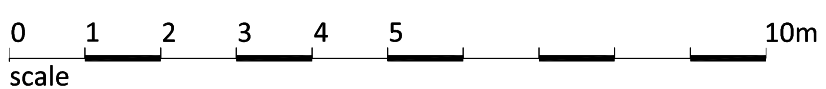

revisions
note

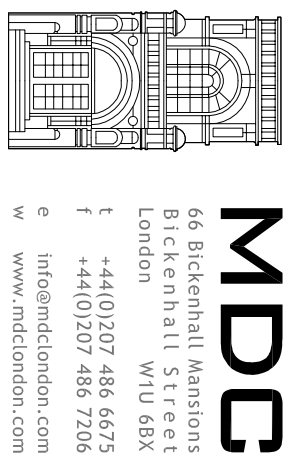

project
22 Redington Road,
London,
NW3 7RG

client

PLANNING

PROPOSED

GROUND FLOOR

drawing

drawn	checked	date
SM	JE	25/06/2012
scale		paper size
1:100	②	A1
drawing no		

6788 / 2021