

This drawing has been prepared for Planning purposes only and should not be used for construction purposes.

All figured dimensions are in millimetres

Key

- 1 Existing air-conditioning units
- 2 Existing water tank room
- 3 Glass roof to atrium

Key plan and north key

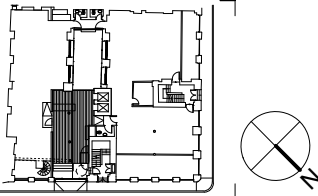

P4	Planning Re-submission	PB	18.07.12
P3	Planning Re-submission	PB	23.05.12
P2	Planning application	DR	21.12.11
P1	Planning first issue	PB	19.08.11
Rev	Description	Drawn	Date

Staffordshire County Council
20-22 Stukeley Street
Proposed North West Elevation
Status: Planning
Scale: 1:50 @ A1, 1:100 @ A3
December 2011

Draw N° 181/ P1016	Rev	P4
Drawn by PB	Authorised by AK	Size A1

HUGHBROUGHTONARCHITECTS
41a Beavor Lane London W6 9BL
T 020 8735 9959 F 020 8563 3891 E info@hbarchitects.co.uk
© Hugh Broughton Architects Ltd



Proposed North West elevation