

PROJECT: NEW LOFT EXTENSIONS

ADDRESS: 21 BROMWICH AVENUE LONDON N6 6QH

CLIENT: Genieve Laidman

DRAWING: PC/GL 2012 – 2010 D01
LOCATION & SITE PLAN to Nos. 21 & 23

SCALE: 1:500; 1:1250 @ A3 DATE: APRIL 2012
REV: D01 – 28.06.12 Town Planning issue.

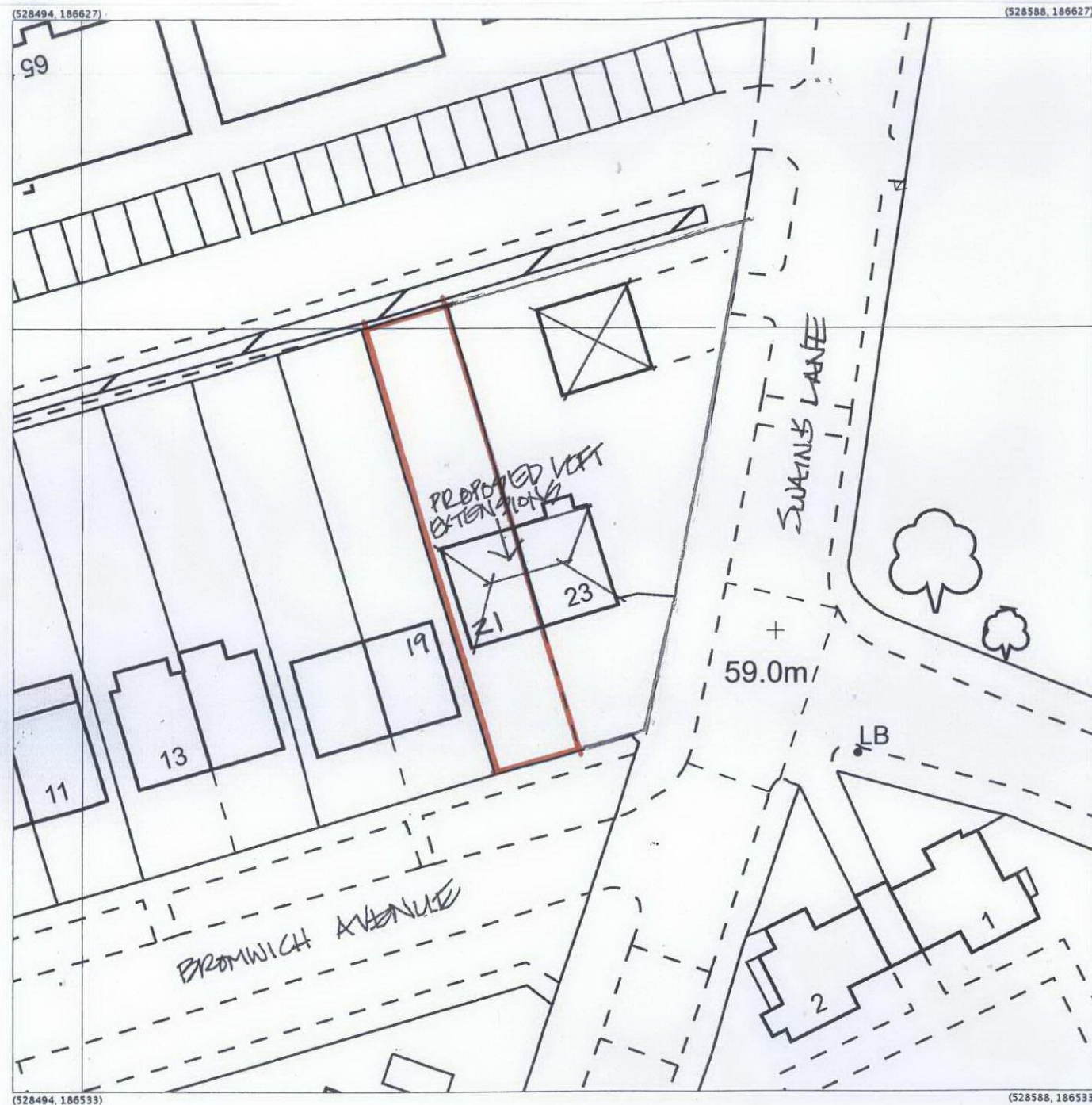

Produced 10 Feb 2012 from the Ordnance Survey National Geographic Database and incorporating surveyed revision available at this date. Reproduction in whole or part is prohibited without the prior permission of Ordnance Survey. © Crown Copyright 2012.

Ordnance Survey and the OS Symbol are registered trademarks of Ordnance Survey, the national mapping agency of Great Britain.

The representation of a road, track or path is no evidence of a right of way. The representation of features as lines is no evidence of a property boundary.



Supplied by: **Stanfords**
Reference: OI376507
Centre coordinates: 528541 186580

21 BROMWICH AVENUE
LONDON
N6 6QH

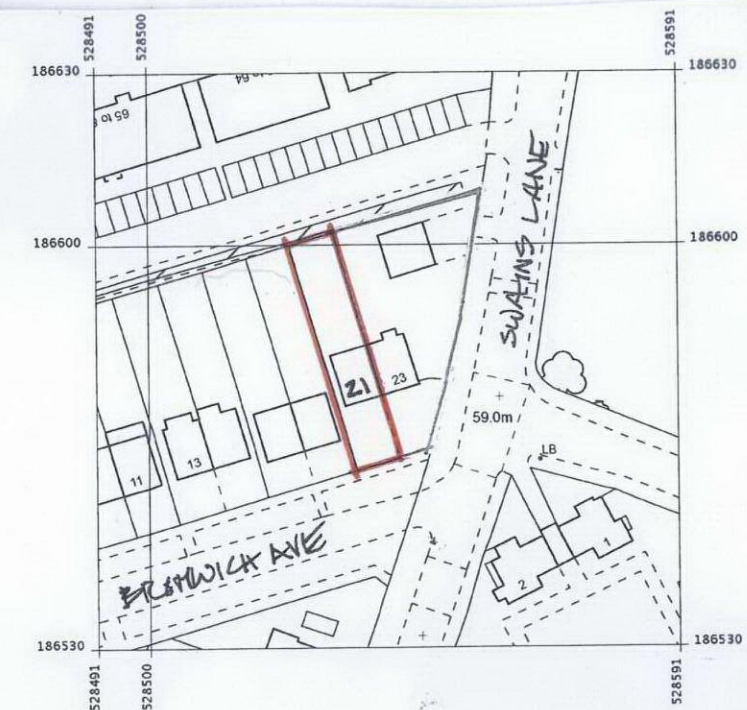

Produced 10 Feb 2012 from the Ordnance Survey National Geographic Database and incorporating surveyed revision available at this date. Reproduction in whole or part is prohibited without the prior permission of Ordnance Survey. © Crown Copyright 2012.

Ordnance Survey and the OS Symbol are registered trademarks of Ordnance Survey, the national mapping agency of Great Britain.

The representation of a road, track or path is no evidence of a right of way. The representation of features as lines is no evidence of a property boundary.



Supplied by: **Stanfords**
Reference: OI376508
Centre coordinates: 528541 186580

21 BROMWICH AVENUE
LONDON
N6 6QH