

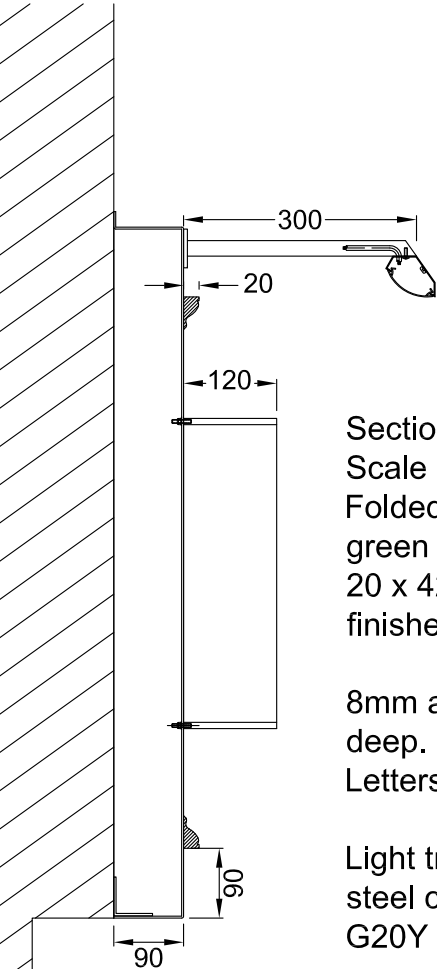

Shaftesbury Avenue Elevation
Scale 1:50



Section A-A through text
Scale 1:10
Folded 2.5mm aluminium fascia panels finished Dulux green smoke Ref 6005 G20Y satin
20 x 42mm timber architrave frame on the fascias finished the same colour.

8mm aluminium welded construction letters 120mm deep.
Letters finished Ardenbrite dark copper gloss.

Light troughs are folded 1.2mm descaled stainless steel channels finished Dulux green smoke Ref 6005 G20Y satin and fitted with low energy white LEDs.

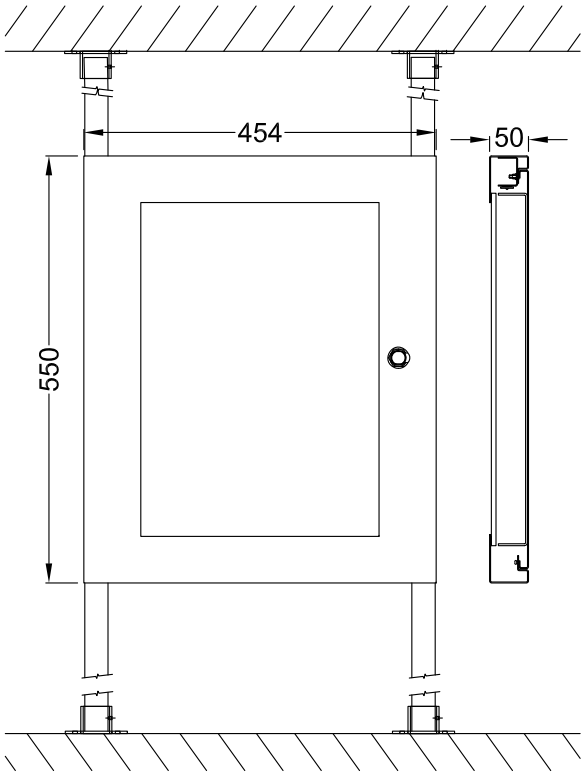

Menu boxes - 2 off
Scale 1:10
1.2mm descaled front and back finished Ardenbrite dark copper gloss.
Fitted with standard cam lock + continuous hinge. 6.4mm laminated glass in window.
Menu insert in 3mm 1TL2 acrylic with cream colour covered pin board.
Illuminated by low energy white LEDs fitted in the top recess.
Descaled stainless steel posts fitted within box and finished Ardenbrite dark copper gloss..
Posts fix to 3mm stainless steel square base plates finished Ardenbrite dark copper gloss.

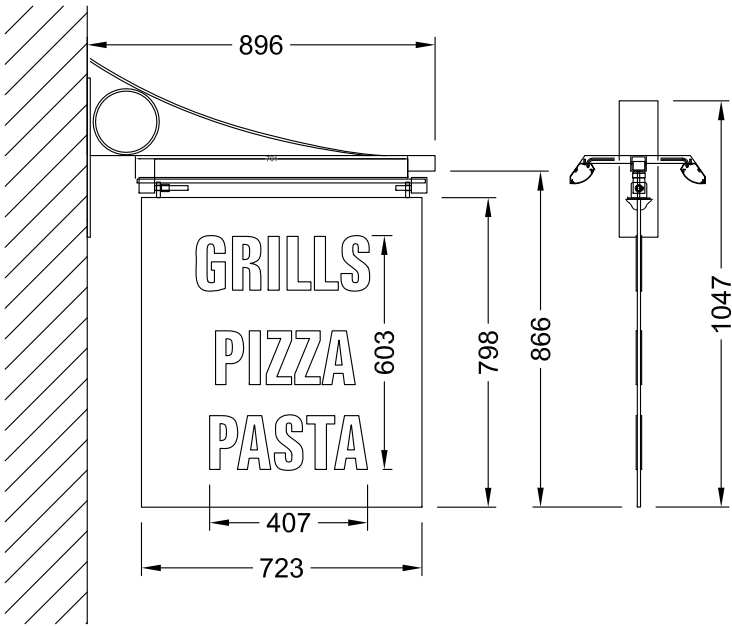

Projected sign - 2 off
Scale 1:20
Flat cut 8mm aluminium panel finished Dulux green smoke Ref 6005 G20Y satin.

Flat cut 3mm aluminium finished Ardenbrite dark copper gloss and bonded to panel faces.

Fixed to a mild steel arm and wall pate finished eggshell black

Externally illuminated by light troughs which are folded 1.2mm descaled stainless steel channels finished black and fitted with low energy white LEDs.

		Client Wildwood		
		Address/Job details 184 Shaftesbury Avenue London WC2H 8JB		
		Proposed Signs		
		Job No		
		Drawn by DN	Date 23/07/12	
		Scale As specified (A3)	Drawing No 329865-3	Rev A