

SECTION B-B
shaded 2nd storey section to be demolished

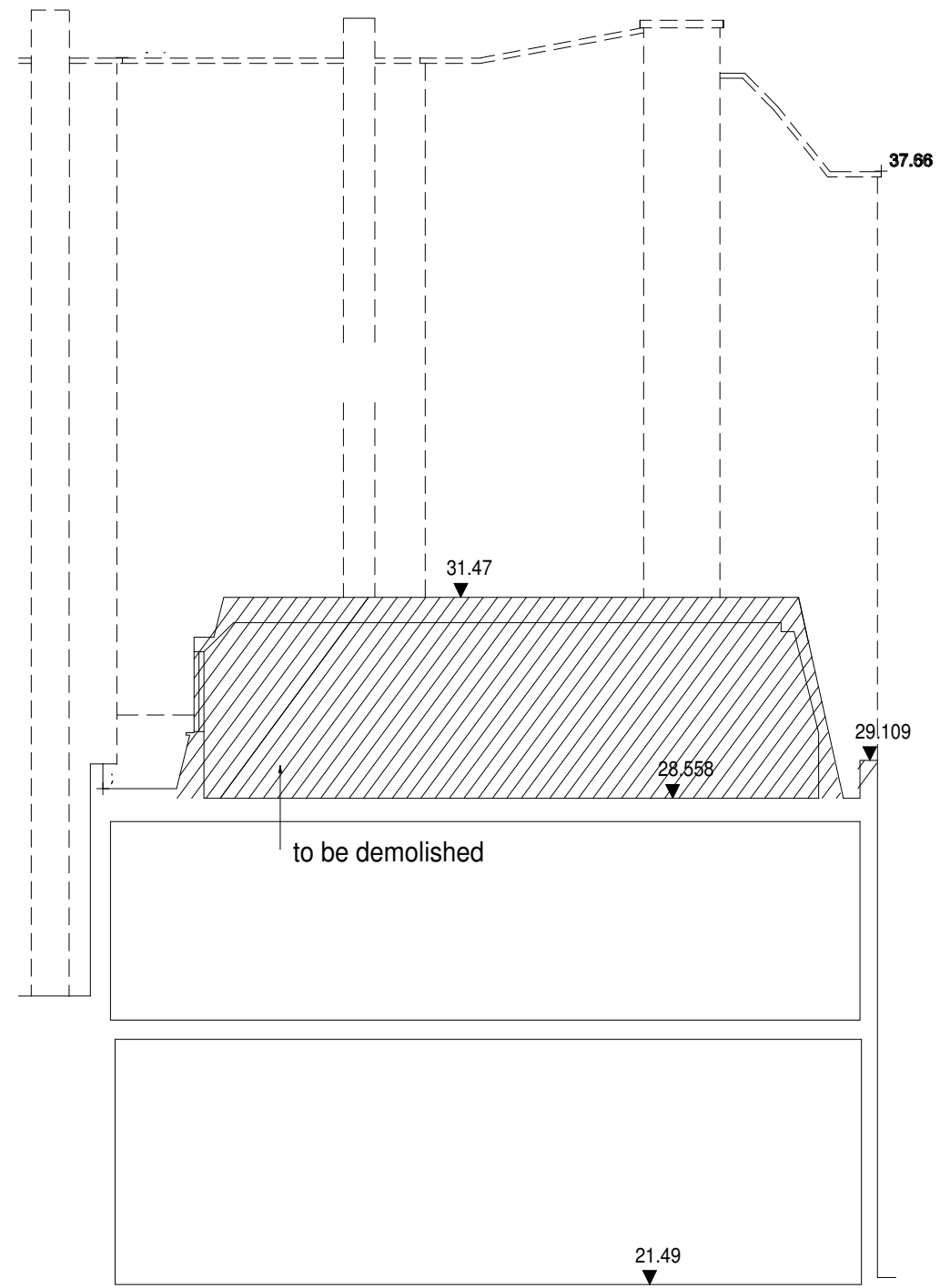

SECTION C-C
shaded 2nd storey section to be demolished

CLIENT	NICHOLAS RAE
SCALE	1:100 @ A3

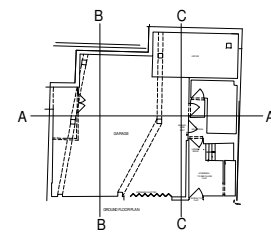
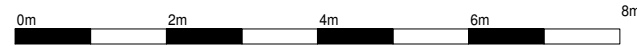

NICHOLAS RAE & ASSOCIATES LTD 29/30 KING'S MEWS, LONDON WC1 NICK@N.RAE.CO.UK Tel: +44(0) 7775 894989	
SITE	29/30 KING'S MEWS, LONDON WC1
DRAWING TITLE	EXISTING SECTIONS B-B & C-C (PROPOSED DEMOLITION)
DRAWING REF	2004-B 29-30KM
DATE	30 JULY 2012