

PLANNING APPROVED 1ST FLOOR PARTIAL PLAN 1:25

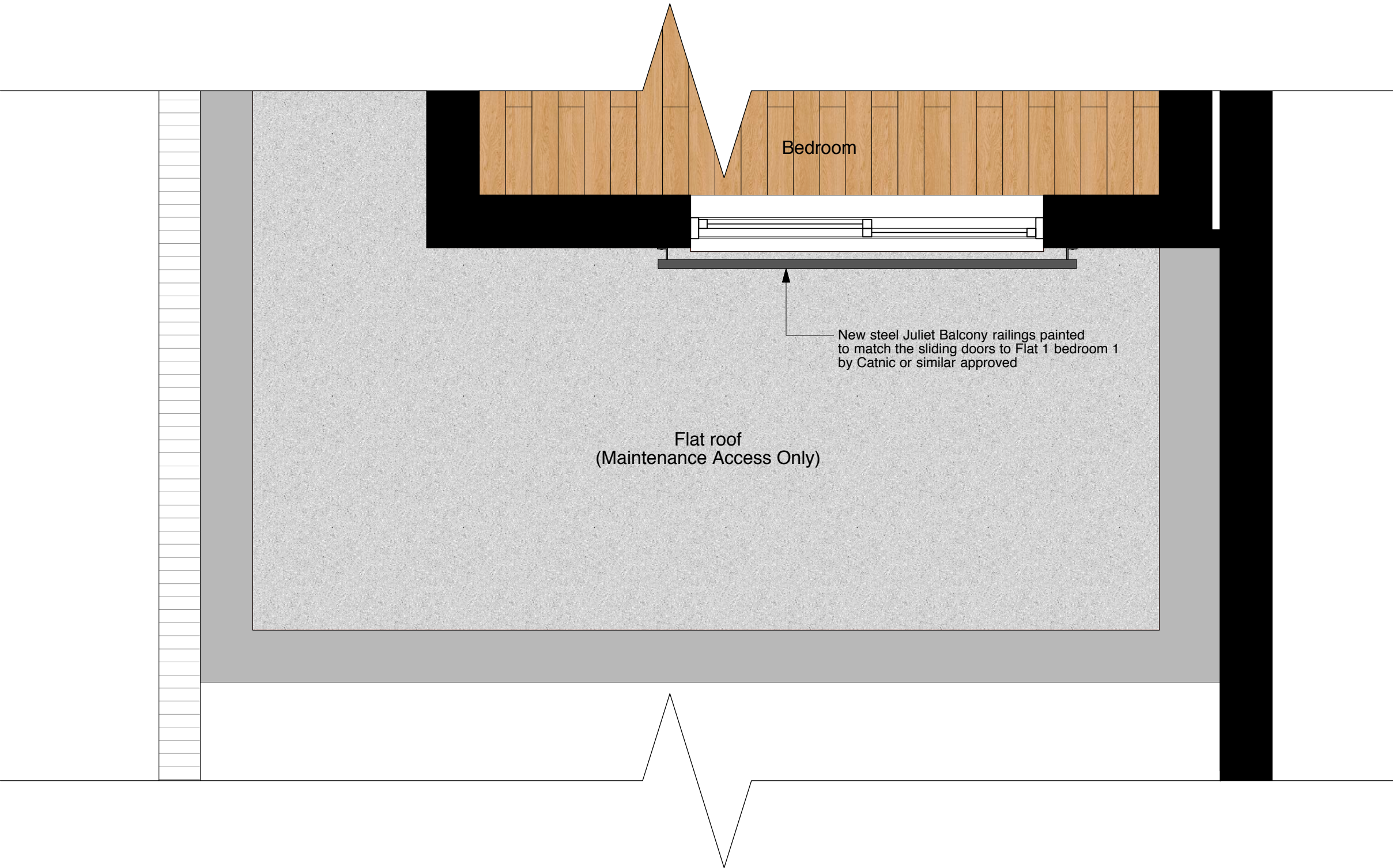

PLANNING APPROVED REAR ELEVATION 1:25



PROPOSED JULIET BALCONY RAILING DETAILS

PROPOSED RAILINGS ELEVATIONS 1:10

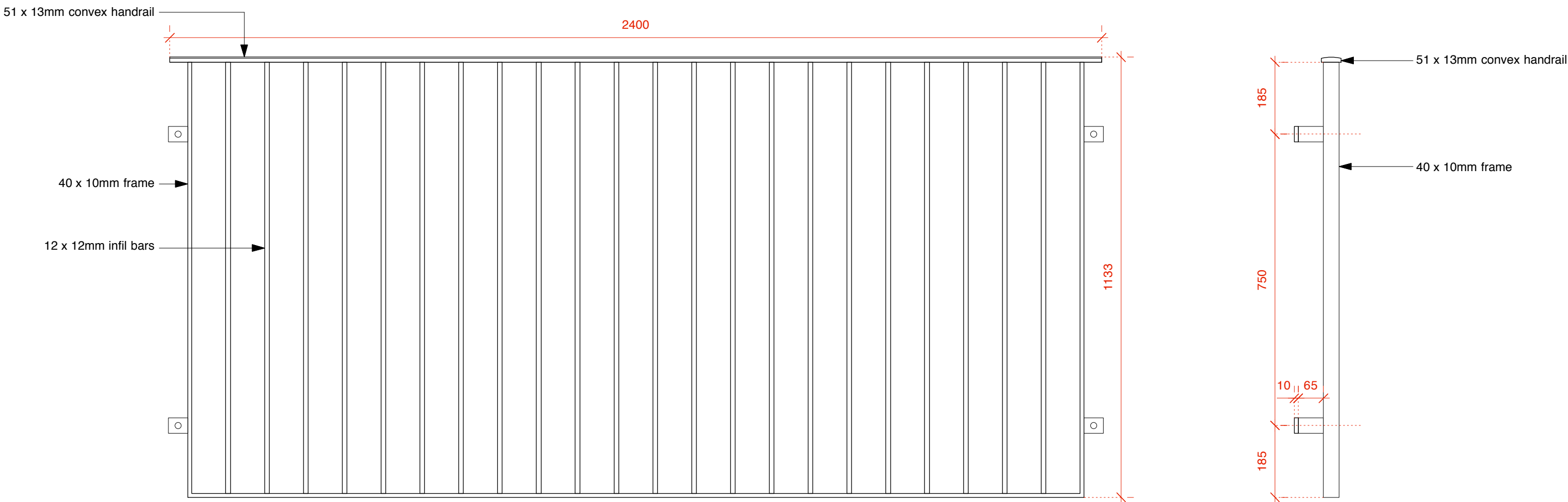

PROPOSED RAILINGS PLAN 1:10

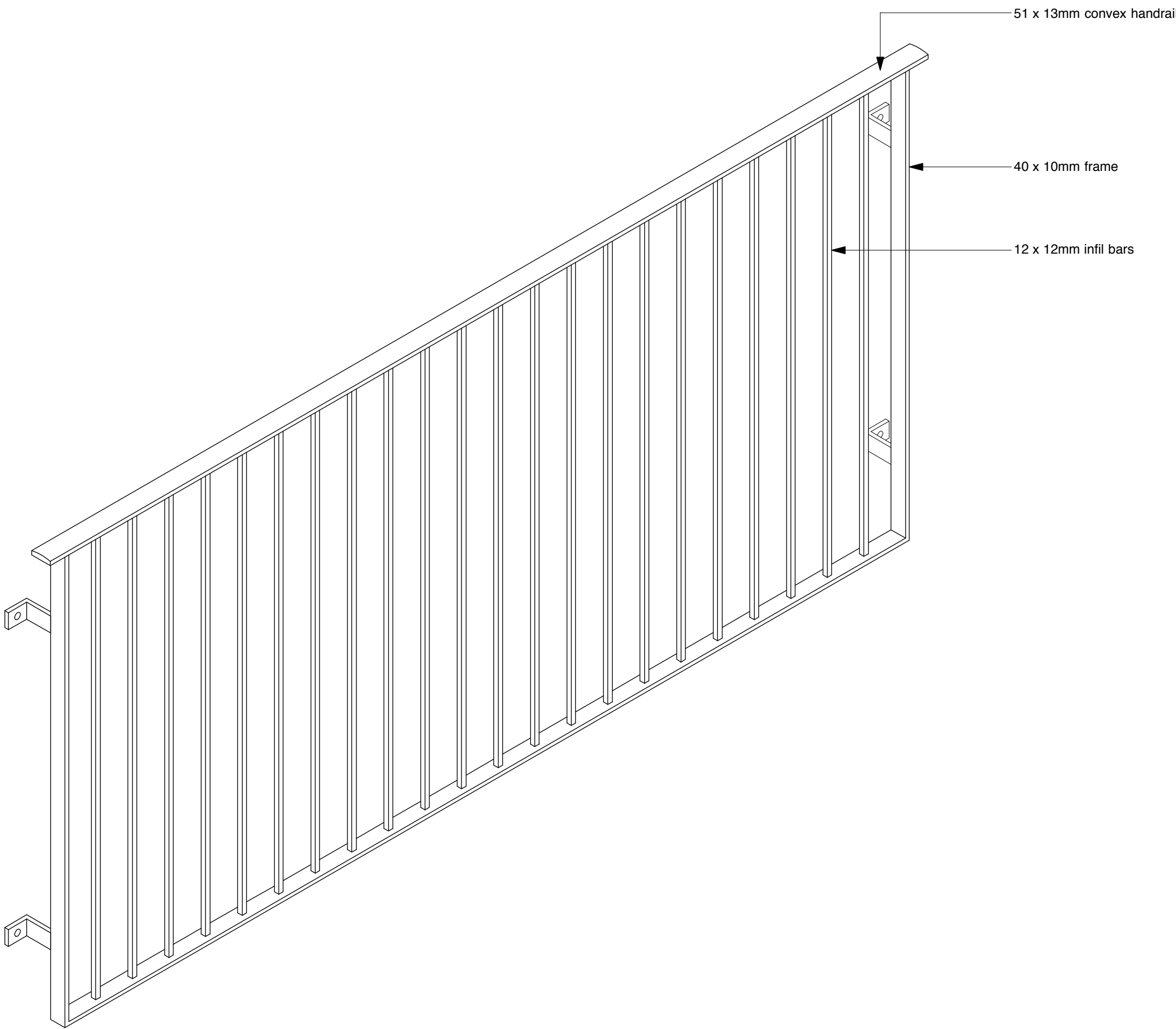
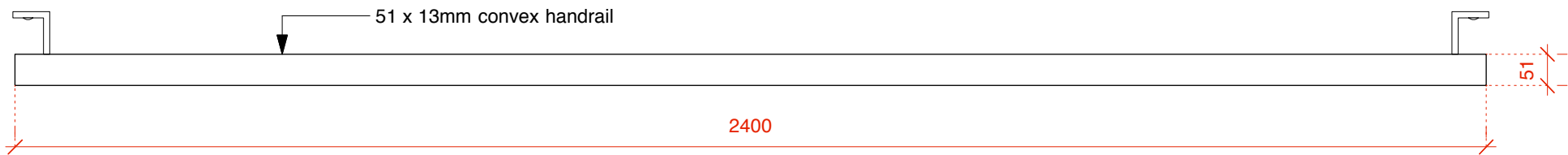

PROPOSED RAILINGS ISOMETRIC

rev.	date	notes
© gpad ltd.		
CLIENT WHITEHALL PARK		
PROJECT 207 ROYAL COLLEGE STREET LONDON NW1 0SG		
TITLE PROPOSED JULIET BALCONY RAILINGS DETAILS		
DWG NO	327A-PA.30	REV
DRAWN BY	J.W	SCALE 1:25@A1
CHECKED BY		DATE July 2012
general practice architects & designers gpad ltd, 6 action st, london, wc1x 9na t: 020 7833 0222 f: 020 7833 2220 e + mail: info@gpadltd.com web: www.gpadltd.com		
This drawing is the copyright of gpad ltd. Figured dimensions to be taken in preference to those scaled. All dimensions to be checked on site before any work proceeds. Drawing not to be used for land transfer purposes. Drawings to be read in conjunction with relevant drawings and specification. Not to be reproduced, retained or disclosed to any unauthorised person either wholly or in part without written permission.		
FILE NAME		PRINT SIZE A1