

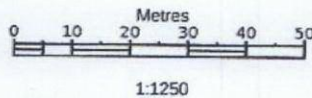

Produced 02 Jul 2012 from the Ordnance Survey National Geographic Database and incorporating surveyed revision available at this date. Reproduction in whole or part is prohibited without the prior permission of Ordnance Survey. © Crown Copyright 2012.

Ordnance Survey and the OS Symbol are registered trademarks of Ordnance Survey, the national mapping agency of Great Britain.

The representation of a road, track or path is no evidence of a right of way. The representation of features as lines is no evidence of a property boundary.



Supplied by: **Stanfords**  
Reference: OI440724  
Centre coordinates: 529372 185006



109A  
ISLIP STREET  
LONDON  
NW5 2DL

2012/3925/P



COPY



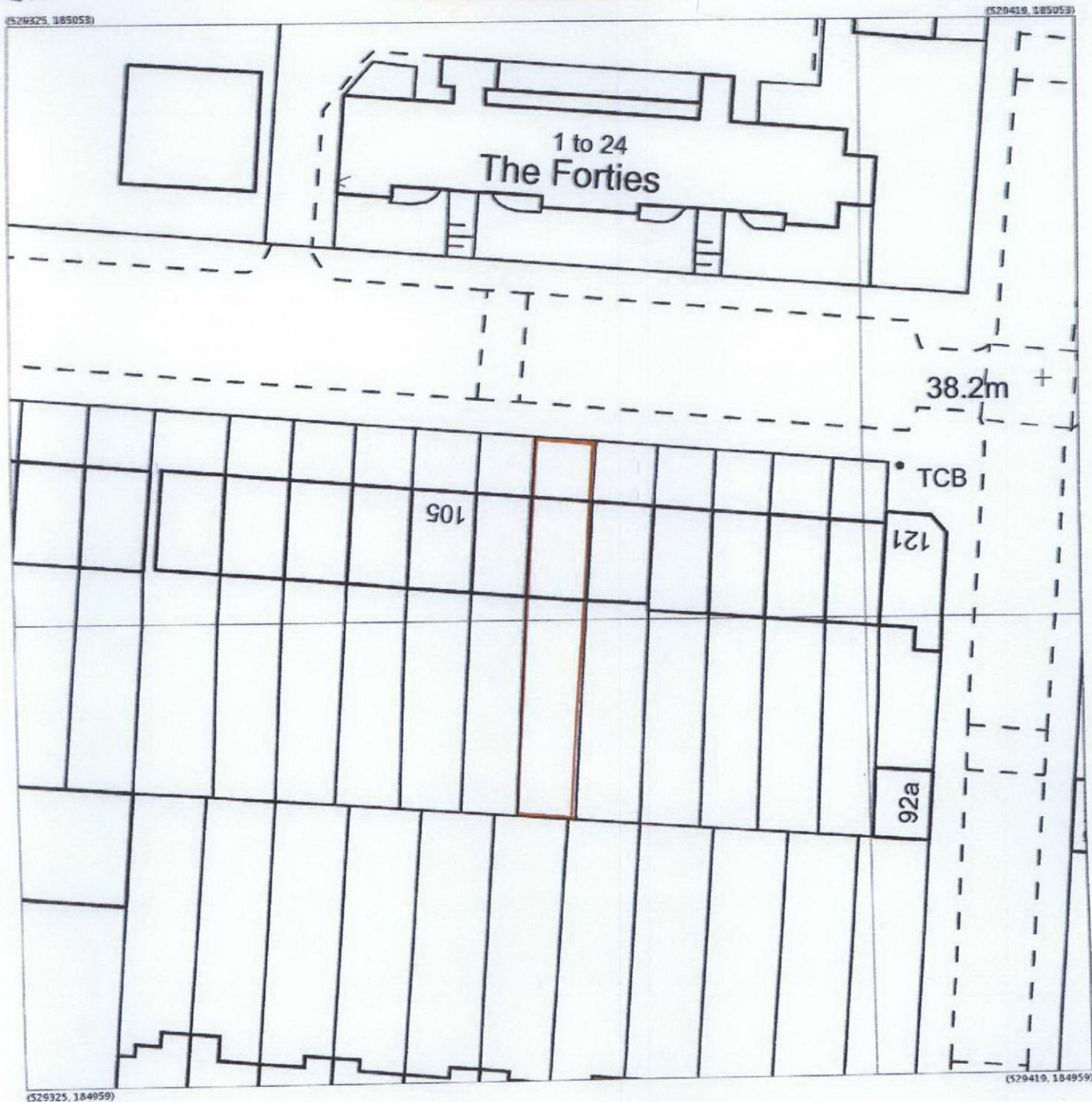

Produced 02 Jul 2012 from the Ordnance Survey National Geographic Database and incorporating surveyed revision available at this date. Reproduction in whole or part is prohibited without the prior permission of Ordnance Survey. © Crown Copyright 2012.

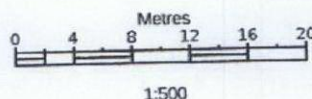

109A  
ISLIP STREET  
LONDON  
NW5 2DL

Ordnance Survey and the OS Symbol are registered trademarks of Ordnance Survey, the national mapping agency of Great Britain.

Supplied by: **Stanfords**  
Reference: Q1440725  
Centre coordinates: 529372 185006

The representation of a road, track or path is no evidence of a right of way. The representation of features as lines is no evidence of a property boundary.

2012/3925/P

 COPY