

NOTES:

REFUSE / RECYCLABLE COLLECTION ARRANGEMENTS

Bin storage areas show 1 to 7 storage units each 650 x 650mm.

1

OFFICE AND WORKSHOP UNITS

The operators of the office and workshop units will make private arrangements for their waste and recycling collections which will take place on-street in accordance with on-street parking and loading restrictions. Bin storage locations 4 to 7 are available for temporary waste and recycling storage

2

RETAIL UNIT

The operators of the retail unit will make private arrangements for their waste and recycling collections which will take place on-street in accordance with on-street parking and loading restrictions.

There are therefore no designated external storage areas for commercial waste

Bin storage location 3 is available for temporary waste and recycling storage

3

RESIDENTIAL UNITS

There are three residential units above the retail unit, (2@ 50m², 1@ 119m²).

Each unit has space designated internally within the kitchen accommodation for 2no. 30 litre bins, one for general waste and one for recyclables, plus 1no. 7 litre kitchen caddy for organic kitchen waste.

In accordance with Camden Planning Guidance 2011 section 10.9, Residential Developments with 6 dwellings or fewer above shops, service will be by kerbside waste and recyclables collection. For the return of recycling/waste bags, bin storage location 1 will, in addition to racking of organic waste (see below) be equipped with three receptacles for the return of recycling/waste bags.

Bin storage location 1 is available for the racking of 3 x 27litre organic kitchen waste receptacles and bin storage location 2 for waste and recycling storage.

PLANNING ISSUE

Job: 20-28 Hatton Wall, WC1 Job No: 1283

Drawing: GROUND FLOOR PLAN WASTE STRATEGY

Date: 110701 Scale: 1:200 No: 105 WD Rev: D

DAVID GIBSON ARCHITECTS
35 BRITANNIA ROW LONDON N1 8QH TEL: 020 7226 2207 FAX: 020 7704 6946

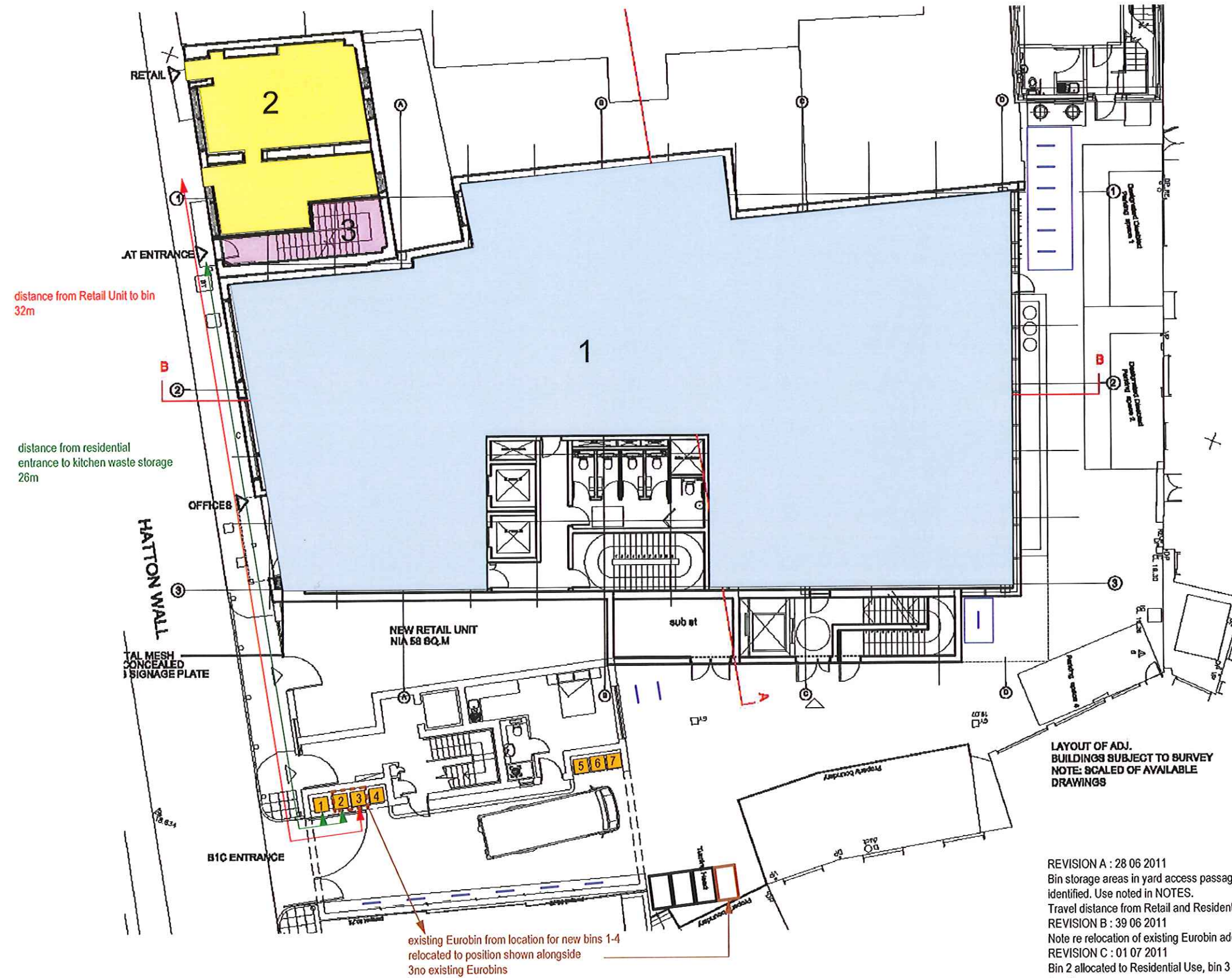

distance from Retail Unit to bin 32m

distance from residential entrance to kitchen waste storage 26m

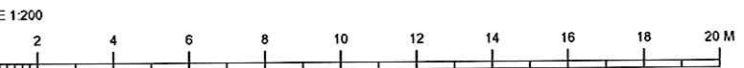

REVISION A : 28 06 2011
Bin storage areas in yard access passage 1 - 7 identified. Use noted in NOTES.
Travel distance from Retail and Residential uses noted.
REVISION B : 30 06 2011
Note re relocation of existing Eurobin added.
REVISION C : 01 07 2011
Bin 2 allocated to Residential Use, bin 3 allocated to Retail use
REVISION D : 24 08 2012
Reference to recycle bag return letterbox removed, amendments to provide for recycle bag return at bin site 1 noted.