

DETAIL 09

horizontal detail of cladding type 2A

M

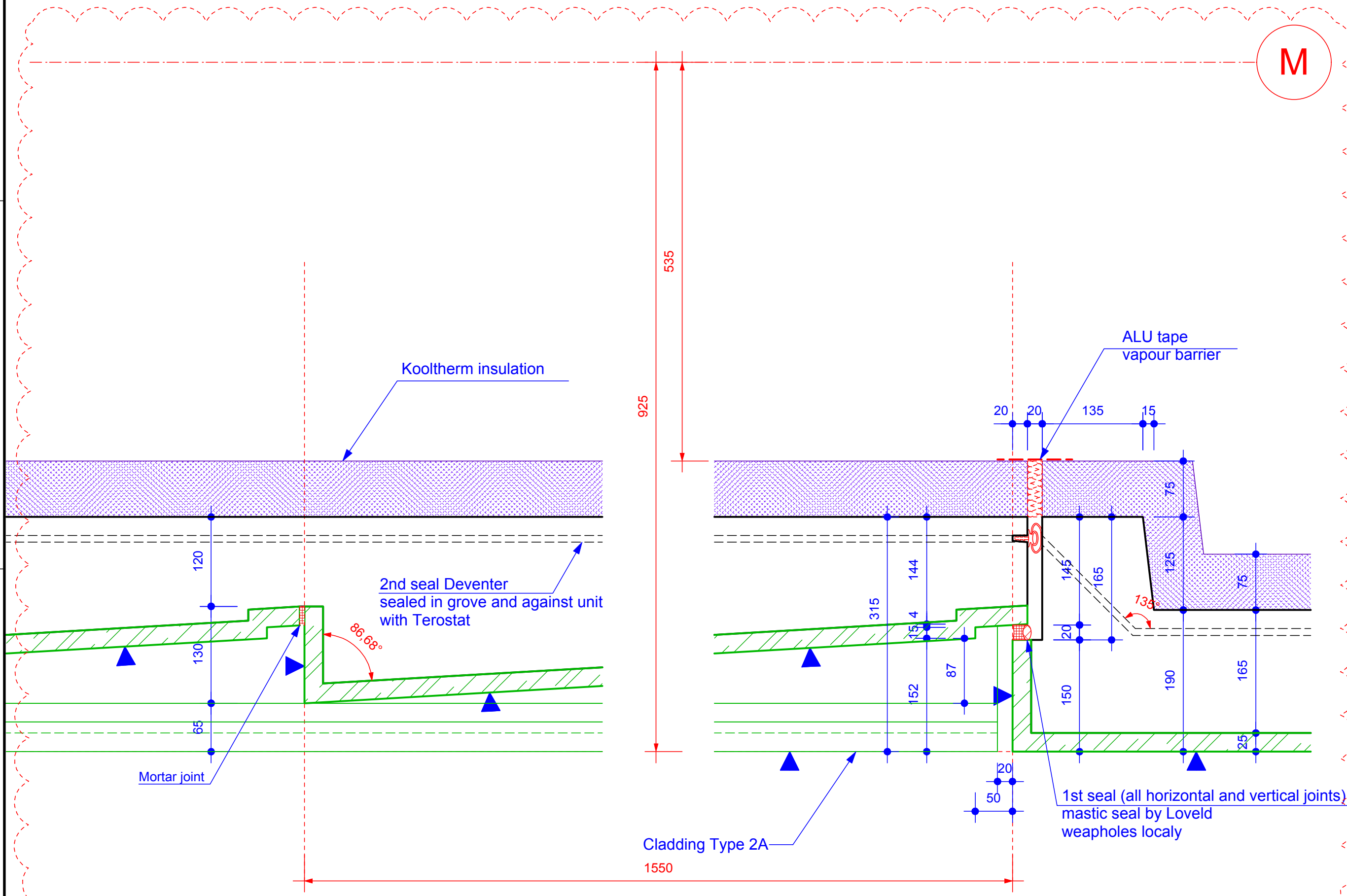

Project
 Prepared For
 UKCMRI Construction Ltd.
 Project No: 08.33082.00

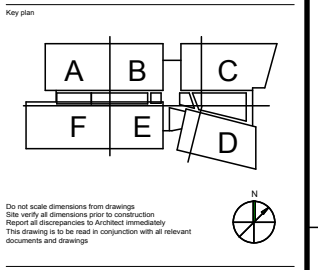

- MATERIALS & FINISHING - SIERLAAG:**
- ▼ EXTRUDED TERRACOTTA TILES
TERRACOTTA TEGELS
 - ▼ MOULD SURFACE - GLAD BETON
 - ▼ ROLLED SURFACE - GEROLD
 - ▼ ROUGH SURFACE - RUW OPPERVLAK
 - ▼ Kooltherm INSULATION - ISOLATIE

Rev	Date	By	Description
A01	23/12/11	ML	Total revision

SPECIFICATIONS FOR PRODUCTION:

CONCRETE: QUALITY 45 N/mm ²	REINFORCEMENT: \varnothing Feb 225
ANCHORAGE LENGTH & LAP LENGTH SEE BS 8110	REINFORCEMENT: \varnothing Feb 500
MIN COVER: EXTERIOR: 30 mm INTERIOR: 20 mm	EXPOSURE CONDITIONS: EXTERIOR: SEVERE INTERIOR: MILD

ITEM	LENGTH	HEIGHT	THICKNESS	WEIGHT	VOLUME

The Francis Crick Institute
 London, UK

**Terracota Pre-Cast Panel
 Cladding Type 2A**

Detail 09

Issue Date: 25/10/2011	Issue By: ML	Checked By:
Project No: 1488	Revision No: RC-	Sheet No: 1/5
Drawing No: 3100 - XXX - X - DT - 2103		Revision No: A01