

THIS DRAWING AND CAD DATA THEREIN IS PROTECTED BY
 COPYRIGHT
 AND MUST NOT BE COPIED OR REPRODUCED
 WITHOUT THE WRITTEN CONSENT OF
 THE ARCHITECT
 ©
 NO DIMENSIONS ARE TO BE SCALED FROM THIS DRAWING.
 USE FIGURED DIMENSIONS ONLY.
 ALL DIMENSIONS AND SIZES ARE TO BE CHECKED ON SITE
 AND ANY DISCREPANCIES REPORTED TO THE ARCHITECT
 0

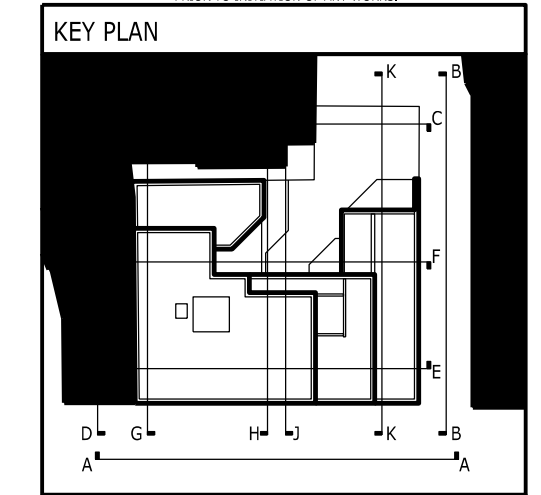

ELEVATION A

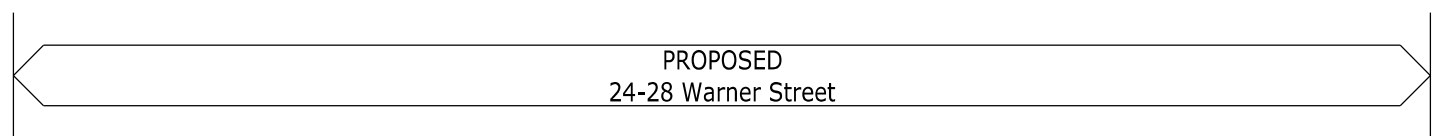

LIST OF MATERIALS

01. Site-Reclaimed Brickwork
02. Western Red Cedar, weatherboard cladding
03. PC, Aluminium Cladding System
04. Structurally reinforced Concrete balcony with solid and Esorbath Aluminium
05. Glass panel balustrade with stainless steel handrails
06. PC, Aluminium cladding panel
07. Stainless steel metal plate balustrade
08. Structurally reinforced screen and doors with Stainless steel plate fittings
09. Western Red Cedar, Screen (1/8" mesh, double sided)
10. Glass balustrade (beamed, double view)
11. Render (off white)
13. PC, Aluminium boxes
14. Timber Deck supported by frame structure, painted white
15. PC, Aluminium cladding



ELEVATION B

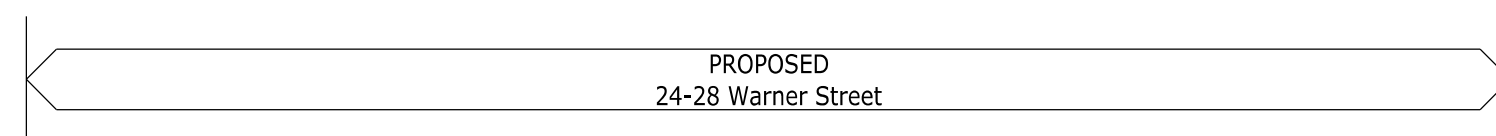

| | | |
|------|---|--------------------------------|
| E | Planning Amendments | GG 19/9/2012 |
| D | Planning Amendments | D.H. 31-08-12 |
| C | Planning Amendments | D.H. 08-06-12 |
| B | Incorporating Planning Advice, Unit 2 changed to 2 bed self-contained | |
| A | 8 SBD update to main entrance & PV panels shown | Y.W. 25-07-11 Y.W. 04-05-11 |
| 1/12 | CONCRETE | INTERNAL |

Job Name
24-28 Warner Street
 London
 EC1R 5EX

Drawing Title
Elevations A & B
 Proposed

Status
Planning Application

Date **Feb 2011 A.R.** Sheet By **1:100 @A1** Scale @ Size

| Job Number | Code | Drawing Number | Rev |
|------------|------|----------------|-----|
| 3001 | (P) | 030 | E |

ARC Design Partnership LLP
 601 International House
 223 Regent Street
 London W1B 2QD

t +44 (0)20 8890 3213
 studio@arcdesignllp.com