

DO NOT SCALE FROM THIS DRAWING.  
USE FIGURED DIMENSIONS ONLY.  
ALL DIMENSIONS AND SIZES ARE TO BE CHECKED ON SITE.  
REPORT ANY DISCREPANCIES TO THE ARCHITECT.

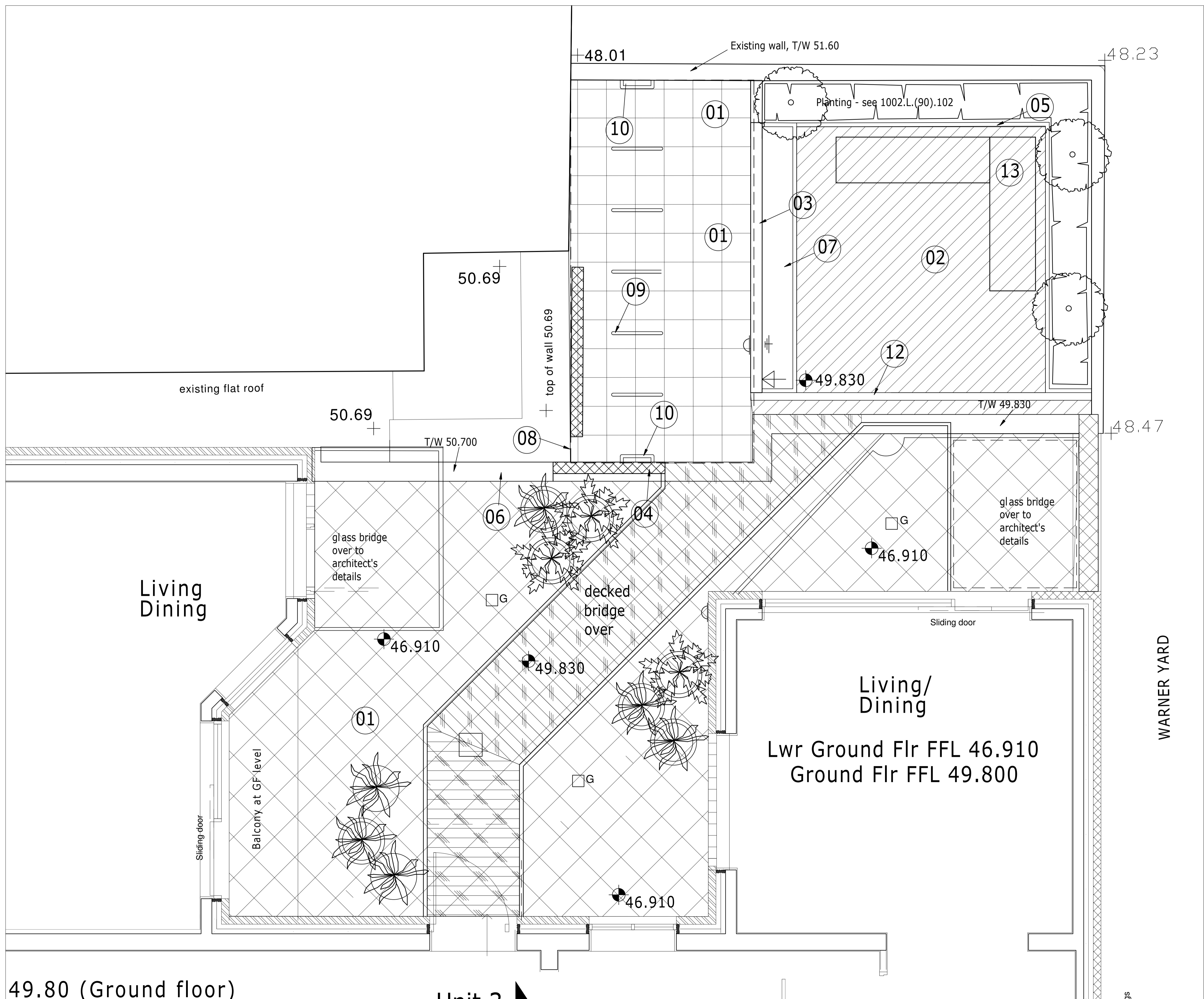

- External services (indicative positions)
- garden water supply
  - 100mm wide drain channel
  - External power socket

- 01 450 x 300 x 50mm silver grey pc concrete paving
- 02 Mixed size grey paving blocks mixed 60=250 x 150, 200 x 150, 150 x 150, 100 x 150mm
- 03 horizontal cedar cladding to r.c. retaining wall with p.c. coping
- 04 2m high Western Red Cedar fence screen
- 05 Aluminium clad plant container
- 06 Lightwell retaining wall in off white self coloured render
- 07 Outdoor kitchen/BBQ unit with 450 x 3000mm smooth grey concrete worksurface and shelves built in below.
- 08 Cedar split-roofed cycle shelter with sedum mat planting
- 09 Galvanised Sheffield cycle stand
- 10 Galvanised wall-fixed cycle stand
- 11 1.1m high glass safety balustrade with s.s. fixings to Architect's details
- 12 100mm wide drain channel
- 13 Hardwood bench 500 x 2000 x 450 mm high
- 14 100 x 50mm impregnated hardwood decking over concrete bridge deck

**PLANNING ISSUE**

Rev. D: Spiral stair removed from lightwell  
Planning Issue 21/09/12  
Rev. C: Lightwell enlarged  
Planning Issue 30/05/12

Client:  
Aitch Group

Project:  
24-28  
Warner  
Street, EC1

Drg. Title:  
Rear hard  
landscape  
layout

Drg. No.  
DOC 1002.L.(90).100.D

Scale: 1:25 @ A1  
Date: 31/05/2012  
Drn by: DO

49.80 (Ground floor)

Unit 2

PS