

SITE LOCATION (Scale 1:50000)

Ordnance Survey map extract
based upon Landranger map series
with the permission of the controller of
Her Majesty's Stationery Office
Mono Consultants Limited licence no. ES100017753
Crown copyright.

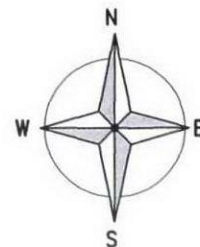

SITE PHOTOGRAPH



1836 00

1835 00

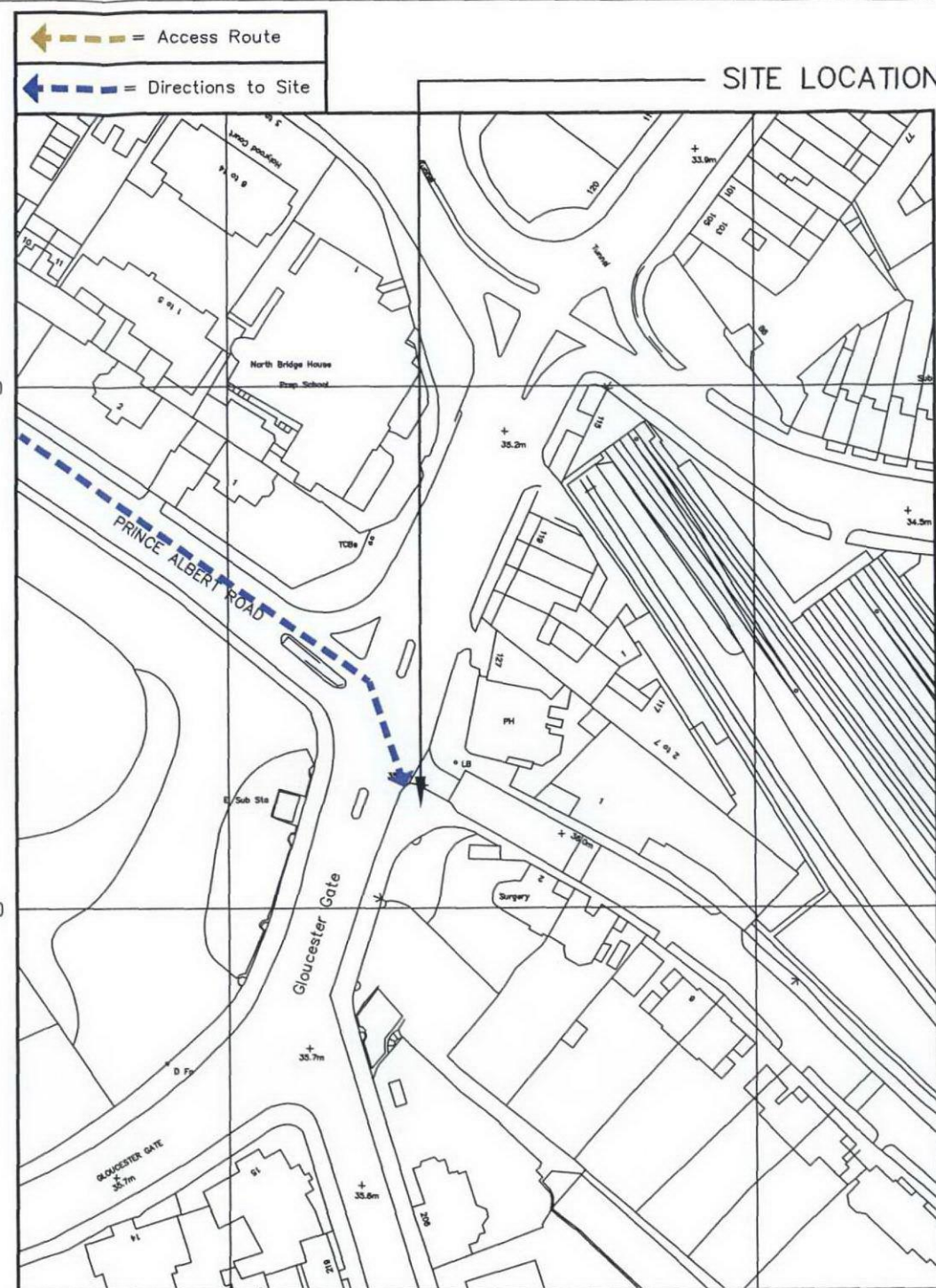

5586 00

5587 00

DETAILED SITE LOCATION (Scale 1:1250)

Based upon Ordnance Survey map extract
with the permission of the Controller of
Her Majesty's Stationery Office.
Crown copyright.
Mono Consultants Limited licence no. ES100017753
Promap licence no. A152065A0001

Notes:
1 ALL DIMENSIONS ARE IN MM UNLESS NOTED OTHERWISE

N.G.R. E: 528638 N: 183530

Directions

From the M25 clockwise, exit at junction 21A, take the A405 exit. At the roundabout, take the 3rd exit onto North Orbital Road (A405). Turn left onto Mt Pleasant Lane. Merge onto M1 for London. Bear slightly left onto the A406 and merge onto the North Circular Road. Take the A41 exit toward Centre London, at the roundabout, take the 3rd exit onto Brentfield Gardens. After 0.3 miles take the ramp onto Brent Cross Flyover. After 1.4 miles turn right onto Finchley Road. After 1.6 miles Continue onto Ave Road. Turn left onto Prince Albert Road and follow to the Junction with Parkway. The site is located on the junction with Parkway and Park Village East.

2012/40/8/P

FILE
COPY

A	Issued for Approval	DCC	NJD	12.06.12
REV	MODIFICATION	BY	CH	DATE

mono #
MONO CONSULTANTS LIMITED
No. 58 Cygnet Court
Timothy's Bridge Road
Stratford-upon-Avon
Warwickshire
CV37 9NW
t. 44 (0)1789 206500
f. 44 (0)1789 206529
www.monoconsultants.com



Cell Name		Opt
PARKWAY		A
Cell ID No		
Cornerstone	Host	Sharer
(CS) 27407	(02) 65932	(VF) N/A
Site Address / Contact Details		
JCN. PARKWAY & PARK VILLAGE EAST CAMDEN LONDON NW1 7PS		

Drawing Title: SITE LOCATION MAPS			
Purpose of Issue: PLANNING			
Drawing Number: 100			
Scale: As Shown	Drawn: DCC	Date: 12.06.12	Issue: A
Checked: NJD	Date: 12.06.12	Approved: AB	Date: 12.06.12