

Our Ref: ER/QT/0812/105
28 September 2012

London Borough of Camden
Attn: Kevin Fisher
Tree Preservation Section
Planning Services
Camden Town Hall
Argyle Street
London WC1H 8ND

TREE WORK APPLICATION

Access: Mecklenburgh Square Garden Committee - 020 7837 7800

Re: 19 Mecklenburgh Square, London, WC1 N 2AD

<u>SPECIES</u>		<u>WORK PROPOSED</u>
P4	London Plane <i>(Platanus x hispanica)</i>	We are of the opinion that, following the discoveries present in Anthony's brief report (see attached), this east limb should be judiciously reduced back over the road to the main crown line to lessen weight and stress on this rather deep cavity.
P7		East lower limb appears to have moved out of crown line small cavity on upper side 1.5m from trunk is decaying. Reduce back this low lateral limb by 20-25% to lessen weight and maintain structural integrity.
P9		Woodpecker hole 20cm dead, decaying. Reduce back the main limb on the east side by 20-25% to lessen weight and maintain structural integrity.
P19		See photographs: 2 limbs, south and east side, have large decaying cavities and fungal brackets present. We are of the opinion that this tree needs crown reducing by 20-25% all round to counter these potentially structurally weak points in the tree and pre-empt possible limb failure.

Please quote our reference number on all correspondence.

Yours sincerely

Edward Radziwillowicz

Our Ref: ER/QT/0812/105
10 August 2012

Mecklenburgh Square Garden Committee
Attn: John Edgington, Caroline Persaud, Myriam Sarens
19 Mecklenburgh Square
London WC1 N 2AD

These tree were inspected for Massaria. Below are the number of branches found on the listed trees.

Trees

- P4. The Ivy was removed and revealed a woodpecker hole on the South side of the East limb at around 10m. It appears to be 50cm in depth, over 30cm wide and goes beyond 50cm high. It is more than 2/3 the diameter of the trunk.
- P5. 1 Dead branch over the garden, not sure if this was Massaria.
- P6. 2 Branches over the garden.
- P7. 1 Branch over the garden.
- P8. 3 Branches over the garden.
- P9. 3 Branches over the footpath on the North side. This tree also has a woodpecker hole on the main limb on the East side at around 8m. It appears to be 20cm deep.
- P13. 1 low branch over the footpath, North west side.
- P15. 3 Branches over the garden.
- P19. On the South side of the main limb at 15m is a wound 40cm long and 20cm deep. Callous wood has formed around the wound. At the top of the wound a Yellow fungal bracket was found.

On the East side limb at 10m was another wound around 30cm in length. A cavity is at the base. At the top is an old ganoderma bracket.

Yours Sincerely,

Anthony Lindley.

Treecare.

Planning Services
Camden Town Hall
Argyle Street
London WC1H 8EQ

Email (enquiries only): env.devcon@camden.gov.uk
Telephone : 020 7974 1911
Fax : 020 7974 5713

For office use
Date
Payee
App. No. Fee

**Application for tree works: works to trees subject to a tree preservation order (TPO)
and/or notification of proposed works to trees in a conservation area.**

Town and Country Planning Act 1990

Publication of planning applications on planning authority websites

Please note that with the exception of applicant contact details, the information provided on this application form and in supporting documents may be published on the authority's website.

If you have provided any other information as part of your application which falls within the definition of personal data under the Data Protection Act which you do not wish to be published on the authority's website, please contact the authority's planning department.

Please complete using block capitals and black ink.

You must use this form if you are applying for work to trees protected by a tree preservation order (TPO). (You may also use it to give notice of works to trees in a conservation area).

It is important that you read the accompanying guidance notes before filling in the form. Without the correct information, your application / notice cannot proceed.

1. Applicant Name and Address

Title:		First name:	
Last name:			
Company (optional):	MECKLENBURGH SQUARE GARDEN COMMITTEE		
Unit:		House number:	19
		House suffix:	
House name:			
Address 1:	MECKLENBURGH SQUARE		
Address 2:			
Address 3:			
Town:	LONDON		
County:			
Country:			
Postcode:	WC1N 2AD		

2. Agent Name and Address

Title:		First name:	CARINA
Last name:			
Company (optional):	TREE CARE		
Unit:		House number:	
		House suffix:	
House name:	OAK TREE HOUSE		
Address 1:	ROSEBANK WORKS		
Address 2:	ROSEBANK WAY		
Address 3:			
Town:	LONDON		
County:			
Country:			
Postcode:	W3 6TT		

3. Trees Location

If all trees stand at the address shown in Question 1, go to Question 4. Otherwise, please provide the full address/location of the site where the tree(s) stand (including full postcode where available)

Unit:	<input type="text"/>	House number:	<input type="text"/>	House suffix:	<input type="text"/>
House name:	<input type="text"/>				
Address 1:	<input type="text"/>				
Address 2:	<input type="text"/>				
Address 3:	<input type="text"/>				
Town:	<input type="text"/>				
County:	<input type="text"/>				
Postcode (if known):	<input type="text"/>				

If the location is unclear or there is not a full postal address, either describe as clearly as possible where it is (for example, 'Land to the rear of 12 to 18 High Street' or 'Woodland adjoining Elm Road') or provide an Ordnance Survey grid reference:

Description:

4. Trees Ownership

Is the applicant the owner of the tree(s): ☒ Yes ☐ No

If 'No' please provide the address of the owner (if known and if different from the trees location)

Title:	<input type="text"/>	First name:	<input type="text"/>
Last name:	<input type="text"/>		
Company (optional):	<input type="text"/>		
Unit:	<input type="text"/>	House number:	<input type="text"/>
House name:	<input type="text"/>		
Address 1:	<input type="text"/>		
Address 2:	<input type="text"/>		
Address 3:	<input type="text"/>		
Town:	<input type="text"/>		
County:	<input type="text"/>		
Country:	<input type="text"/>		
Postcode:	<input type="text"/>		

Telephone numbers

Country code:	National number:	Extension number:
<input type="text"/>	<input type="text"/>	<input type="text"/>
Country code:	Mobile number (optional):	
<input type="text"/>	<input type="text"/>	
Country code:	Fax number (optional):	
<input type="text"/>	<input type="text"/>	

Email address (optional):

5. What Are You Applying For?

Are you seeking consent for works to tree(s) subject to a TPO? ☒ Yes ☐ No

Are you wishing to carry out works to tree(s) in a conservation area? ☒ Yes ☐ No

6. Tree Preservation Order Details

If you know which TPO protects the tree(s), enter its title or number below.

7. Identification Of Tree(s) And Description Of Works

Please identify the tree(s) and provide a full and clear specification of the works you want to carry out. Continue on a separate sheet if necessary. You might find it useful to contact an arborist (tree surgeon) for help with defining appropriate work. Where trees are protected by a TPO, please number them as shown in the First Schedule to the TPO where this is available. Use the same numbers on your sketch plan (see guidance notes).

Please provide the following information below : tree species (and the number used on the sketch plan) and description of works. Where trees are protected by a TPO you must also provide reasons for the work and, where trees are being felled, please give your proposals for planting replacement trees (including quantity, species, position and size) or reasons for not wanting to replant.

E.g. Oak (T3) - fell because of excessive shading and low amenity value. Replant with 1 standard ash in the same place.

7. Identification Of Tree(s) And Description Of Works continued ...

8. Trees - Additional Information

Additional information may be attached to electronic communications or provided separately in paper format.

For all trees

A sketch plan clearly showing the position of trees listed in Question 7 must be provided when applying for works to trees covered by a TPO. A sketch plan is also advised when notifying the LPA of works to trees in a conservation area (see guidance notes). It would also be helpful if you provided details of any advice given on site by an LPA officer.

For works to trees covered by a TPO

Please indicate whether the reasons for carrying out the proposed works include any of the following. If so, your application must be accompanied by the necessary evidence to support your proposals. (See guidance notes for further details)

1. **Condition of the tree(s)** - e.g. it is diseased or you have fears that it might break or fall: ☐ Yes ☒ No
If YES, you are required to provide written arboricultural advice or other diagnostic information from an appropriate expert.

2. **Alleged damage to property** - e.g. subsidence or damage to drains or drives. ☐ Yes ☒ No
If YES, you are required to provide for:

Subsidence

A report by an engineer or surveyor, to include a description of damage, vegetation, monitoring data, soil, roots and repair proposals. Also a report from an arboriculturist to support the tree work proposals.

Other structural damage (e.g. drains, walls and hard surfaces)

Written technical evidence from an appropriate expert, including description of damage and possible solutions.

Documents and plans (for any tree)

Are you providing separate information (e.g. an additional schedule of work for Question 7)? ☒ Yes ☐ No

If YES, please provide the reference numbers of plans, documents, professional reports, photographs etc in support of your application. If they are being provided separately from this form, please detail how they are being submitted.

see attached

N

MECKLENBURGH

SQUARE. WCI

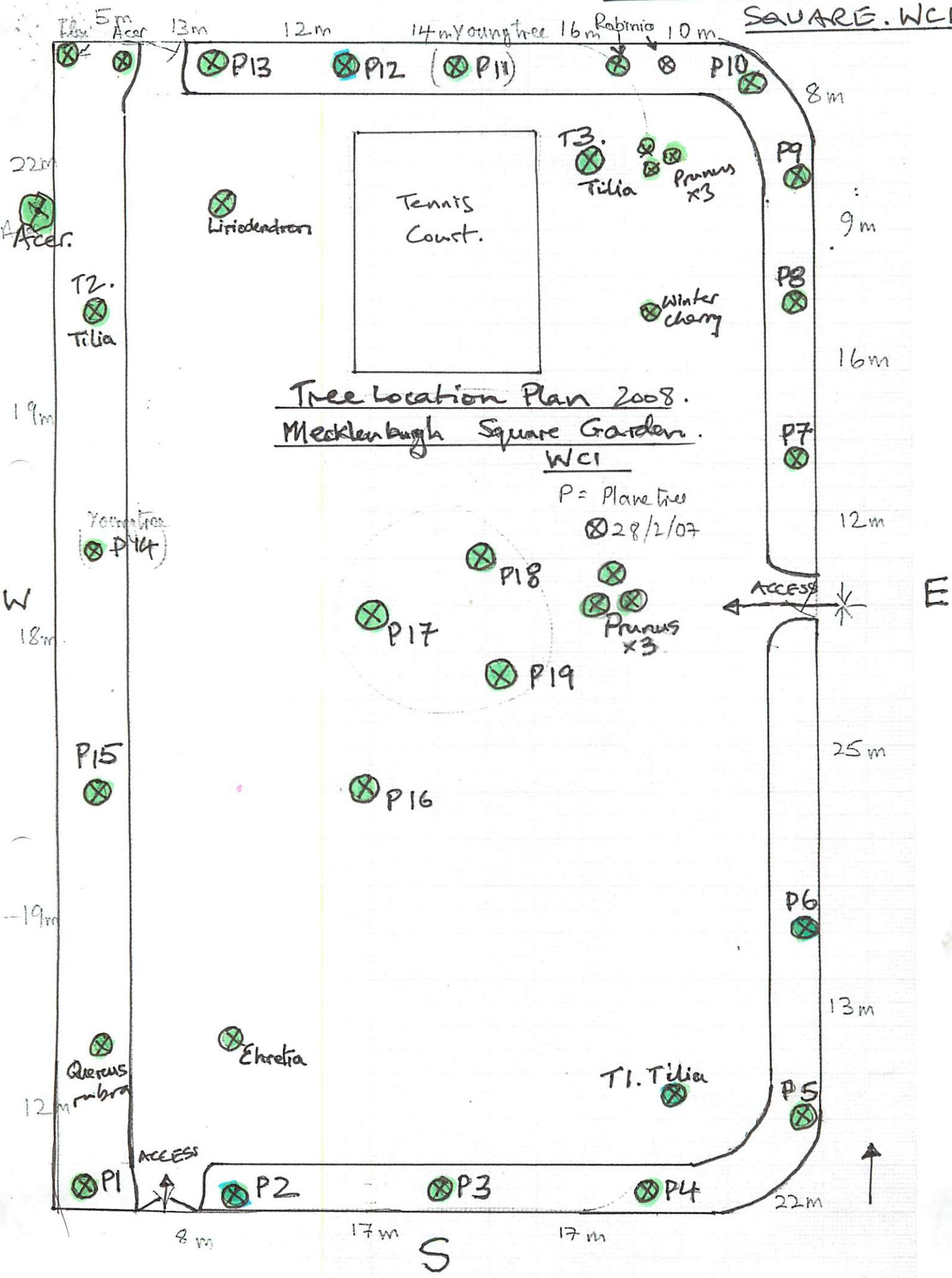

11-20-54

