

This dwg is to be read in conjunction with the following dwgs:

x996 - 0004 Existing elevations.dwg

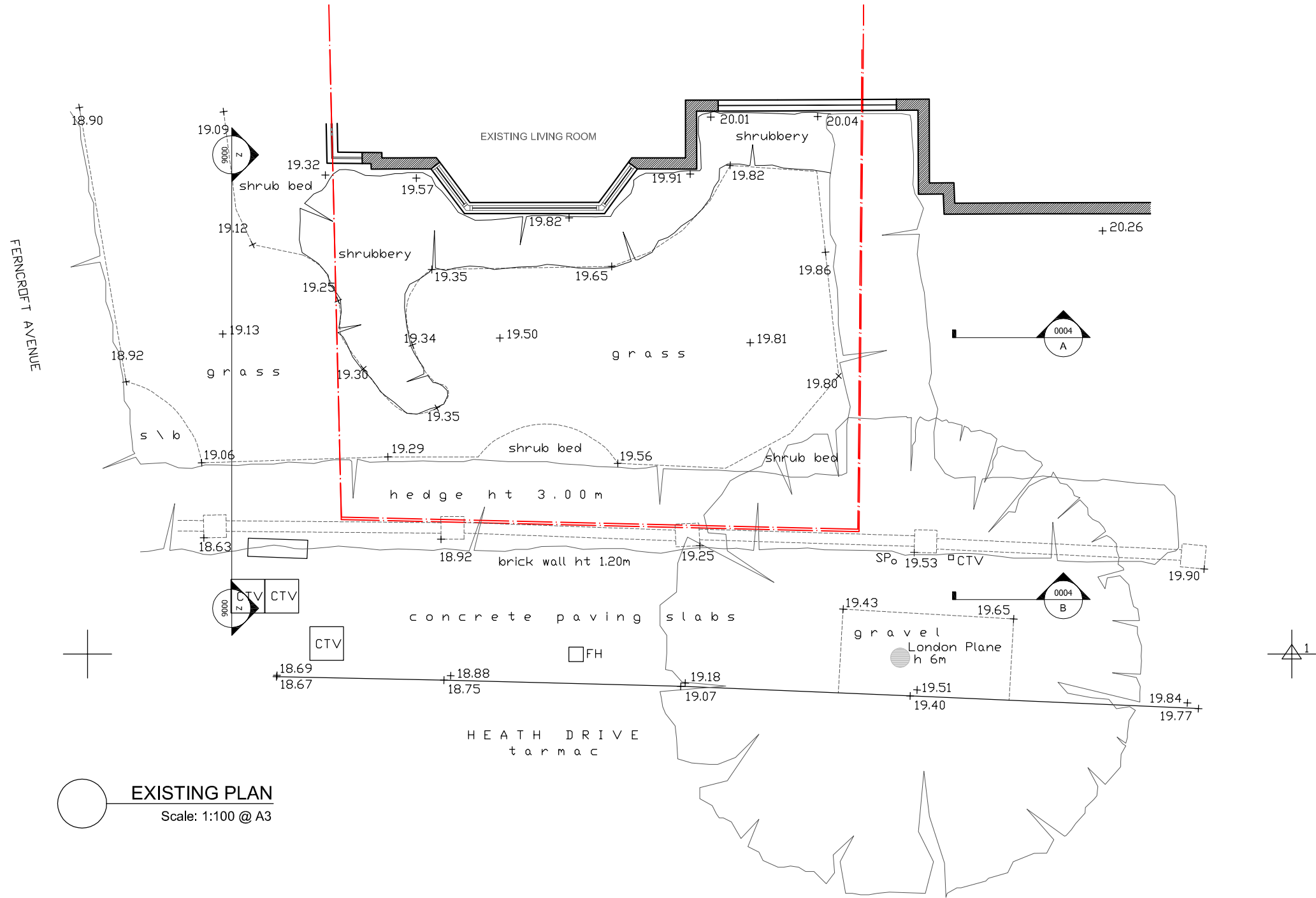

EXISTING PLAN
Scale: 1:100 @ A3

PLANNING

NOTES:		REV:	DATE:	NOTES:	BY:	REV:	DATE:	NOTES:	BY:	REV:	DATE:	NOTES:	BY:	PROJECT: APARTMENT B, 16 HEATH DRIVE LONDON NW3	DRAWING TITLE: EXISTING LAYOUT PLAN			
<p>This drawing may have been prepared based upon survey / other info supplied by others. All dims and levels are to be checked on site, prior to works being commenced, by contractors and discrepancies reported immediately to Janine Stone Design.</p> <p>Contractors to ensure that all works undertaken by themselves and / or their sub-contractors are constructed and / or manufactured according to all current national and / or local authority statutory requirements and in accordance with current codes of practice.</p>		A	12.10.24	New section line added.	TT									<div><div>JANINE STONE</div><div>architectural & interior design - build & project management</div><div>71-73 WARRINER GARDENS, LONDON, SW11 4XW TEL: +44 (0)20 7627 5300 - FAX: +44 (0)20 7622 9882 4 OAKFIELD ROAD, ALTRINCHAM, CHESHIRE, WA15 8EJ TEL: +44 (0)161 929 5568 - FAX: +44 (0)161 929 6627 e: info@janinestone.com - w: www.janinestone.com</div><div><small>*Janine Stone* is a trading name of G & J STONE GROUP LIMITED</small></div></div>	STATUS: PLANNING		PROJECT-NO: x996	
															SCALE: 1: 100@A3	DWN: SF	CHK: CG	0002
														DATE: 2012.09.28	REV: A	SERIES-NO:		